

- | | | | |
|---|--|--|---|
| <p>1</p> <ul style="list-style-type: none"> • Expanding radial pin • Разжимной радиальный штифт • Promieniowy sworzeń rozporowy • Rozširujúci radiálny kolík • Radyal genişletme pimi | <p>2</p> <ul style="list-style-type: none"> • Body • Корпус • Korpus • Tělo • Gövde | <p>3</p> <ul style="list-style-type: none"> • Set screw • Установочный винт • Śruba ustawcza • Nastavovací šroub • Ayar vidası | <p>7</p> <ul style="list-style-type: none"> • Coolant outlet • Выход хладагента • Wylot cieczy chłodzącej • Výstup chladicí kapaliny • Soğutma sıvısı çıkışı |
| <p>4</p> <ul style="list-style-type: none"> • Slide toolholder • Салазки • Sanie narzędziowe • Nástrojový držák šoupátka • Kayar takım tutucu | <p>8</p> <ul style="list-style-type: none"> • Slide clamp screw • Зажимные винты салазок • Śruba blokująca sanie narzędziowe • Upinací šroub šoupátka • Sürgülü sıkma vidası | <p>9</p> <ul style="list-style-type: none"> • Battery compartment cover • Крышка батарейного отсека • Osłona baterii • Kryt prostoru baterie • Pil bölümü kapağı | <p>11</p> <ul style="list-style-type: none"> • Digital display • Цифровой дисплей • Wyświetlacz cyfrowy • Digitální displej • Dijital gösterge |
| <p>5</p> <ul style="list-style-type: none"> • Bit holder • Кассета головки • Wytaczak • Hrotový držák • Matkap kovani | <p>10</p> <ul style="list-style-type: none"> • Oiler • Масленка • Smarownica • Olejnička • Yağlayıcı | <p>12</p> <ul style="list-style-type: none"> • Selection button • Кнопка выбора • Przycisk Wyboru • Tlačítko pro výběr • Seçme düğmesi | <p>6</p> <ul style="list-style-type: none"> • Tools clamp screws • Зажимные винты инструмента • Śruba blokująca narzędzie • Upinací šrouby nástroje • Takımların sıkma vidaları |

IP67

2 μm



GB FEATURES. The TR-ELETTRA heads enable high precision machining with tolerance grade, IT6, with excellent surface finish. They have a 1 micron radius adjustment sensitivity on a built-in digital display, ensuring maximum speed and adjustment accuracy. The TR-ELETTRA heads are resistant to water infiltration and are coated with an anti-corrosive surface protection.

RU ХАРАКТЕРИСТИКИ. Головки TR-Elettra позволяют производить высокоточную обработку по классу IT6 с исключительным качеством поверхности. Они имеют точность регулировки радиуса в 1 микрон на встроенном цифровом дисплее обеспечивая скорость и точность настройки. Головки TR-ELETTRA являются влагозащитными и имеют антикоррозионное покрытие.

PL CECHY. Głowice TR-Elettra umożliwiają obróbkę o bardzo wysokiej dokładności w tolerancji IT6 i gwarantują uzyskanie doskonałej jakości powierzchni. Posiadają dokładność ustawczą 1 mikrometr na promieniu widoczną na wbudowanym wyświetlaczu cyfrowym, zapewniającym maksymalną szybkość i dokładność ustawienia. Głowice TR-Elettra są odporne na przedostawanie się chłodziwa i są pokryte warstwą ankorozijną.

CZ VLASTNOSTI. Pomocí hlav TR-ELETTRA se dosáhne vysoce přesného obrábění podle tolerance IT6 s vynikající finální úpravou povrchu. Přesnost nastavení poloměru na vestavěném digitálním displeji je 1 mikron, což zajišťuje maximální přesnost a rychlost nastavení. Tyto TR-ELETTRA hlavy jsou voděodolné a jsou potaženy antikorozií povrchovou vrstvou.

TR ÖZELLİKLER. TR-ELETTRA kafaları IT6 toleransında mükemmel yüzey kalitesinde yüksek hassasiyet sağlar. Dijital göstergede 1 mikron yarıçap ayarı hassasiyeti ile maximum hız ve ayar doğruluğuna sahiptir.

TR-ELETTRA 32 MHD'32

Ø 35.5 ~ 51.5



TR-ELETTRA 40 MHD'40

Ø 48 ~ 64

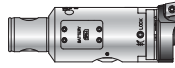

TR-ELETTRA 50 MHD'50

Ø 2.5 ~ 110

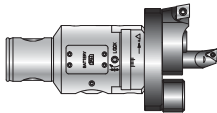

TR-ELETTRA 63 MHD'63

Ø 6 ~ 125

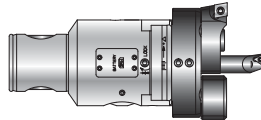

TR-ELETTRA 80 - MHD'80

Ø 6 ~ 200

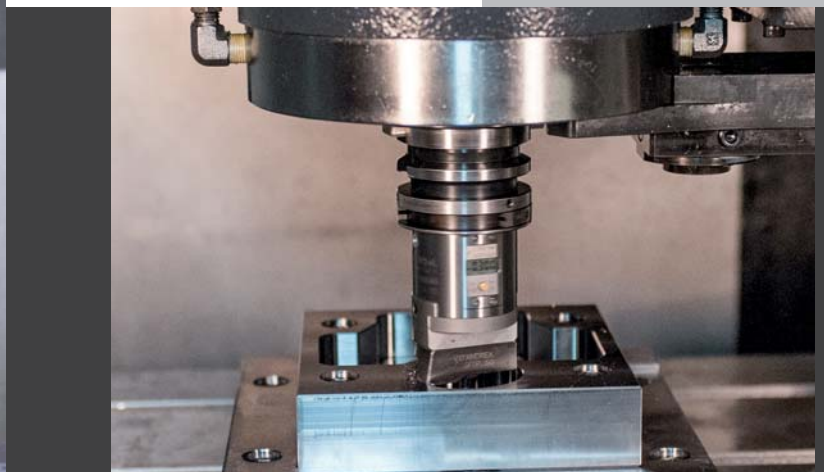
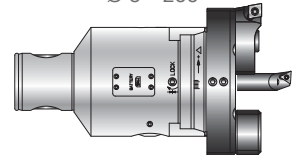

TR-E 32 - MHD'32

TR-E 40 - MHD'40

TR-E 50 - MHD'50

TR-E 63 - MHD'63

TR-E 80 - MHD'80





2 µm

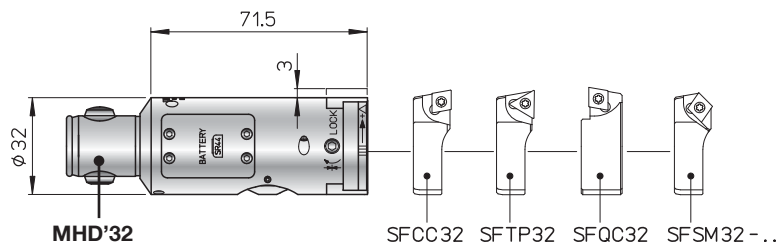

REF.	CODE	Kg.
TR-ELETTRA 32 MHD'32	455200320320	0.4

TR-E 32
Ø 35 ~ 51.5

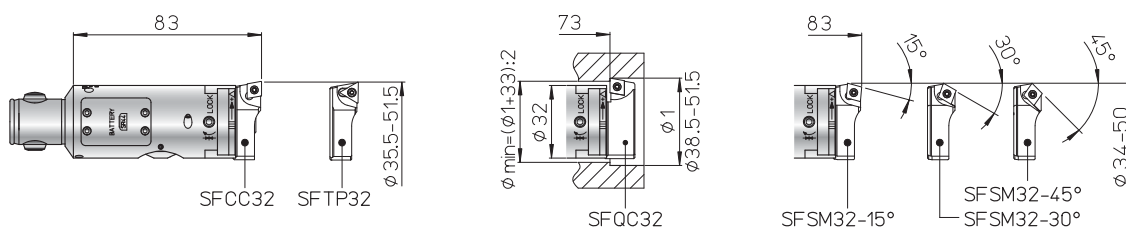

- BIT-HOLDERS FOR TESTAROSSA
- КАССЕТЫ ДЛЯ ГОЛОВКИ TESTAROSSA
- OSTRZA DO GŁOWIC TESTAROSSA
- HROTOVÉ DRŽÁKY TESTAROSSA
- TESTAROSSA İÇİN MATKAP KOVANLARI

SF

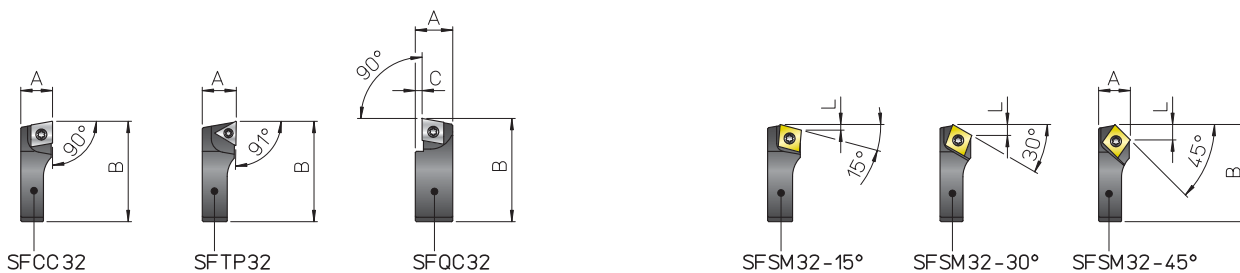

REF.	CODE	A	B	C	L					Kg.
SFCC 32	470500532002	11.5	34.5	-	-	CCGT 0602..	-	TS 25	TORX T08	0.02
SFTP 32	470500532001	11.5	34.5	-	-	-	TPGX 0902..	CS 250T	TORX T08	0.02
SFQC 32	470500532062	13.5	35.5	2.5	-	CCMT 0602..	-	TS 25	TORX T08	0.03
SFSM 32-15°	470500532011	11.5	33.5	-	1.6	CCMT 0602..	-	TS 25	TORX T08	0.02
SFSM 32-30°	470500532013				3					
SFSM 32-45°	470500532015				4.3					





2 μm

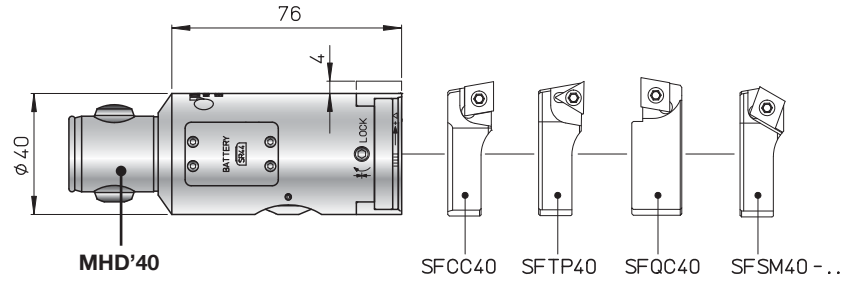

REF.	CODE	Kg.
TR-ELETTRA 40 MHD'40	455200400400	0.7

TR-E 40
Ø 48 ~ 64

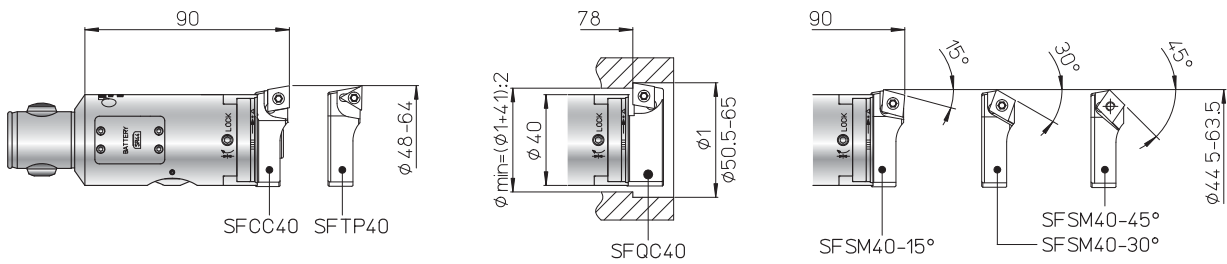

- BIT-HOLDERS FOR TESTAROSSA
- КАССЕТЫ ДЛЯ ГОЛОВКИ TESTAROSSA
- OSTRZA DO GŁOWIC TESTAROSSA
- HROTOVÉ DRŽÁKY TESTAROSSA
- TESTAROSSA İÇİN MATKAP KOVANLARI

SF

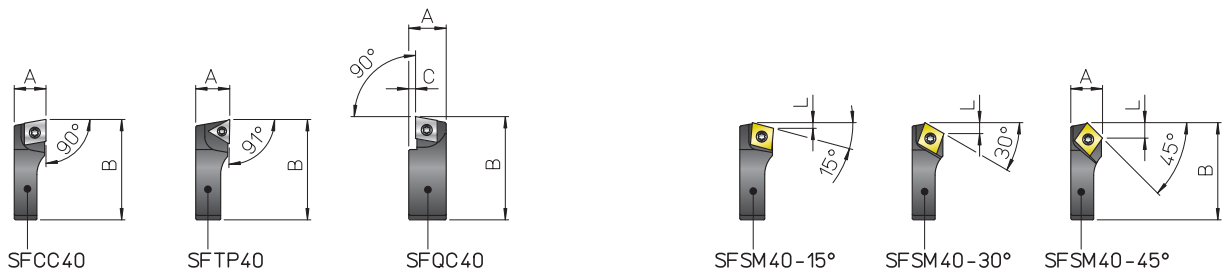

REF.	CODE	A	B	C	L					Kg.
SFCC 40	470500540002	14	44	-	-	CCGT 09T3..	-	TS 4	TORX T15	0.04
SFTP 40	470500540001	14	44	-	-	-	TPGX 1103..	CS 300890T	TORX T08	0.04
SFQC 40	470500540062	16.5	46	3	-	CCMT 09T3..	-	TS 4	TORXT15	0.06
SFSM 40-15°	470500540011	14	42.5	-	2.4	CCMT 09T3..	-	TS 4	TORXT15	0.03
SFSM 40-30°	470500540013				4.6					
SFSM 40-45°	470500540015				6.6					



2 μm

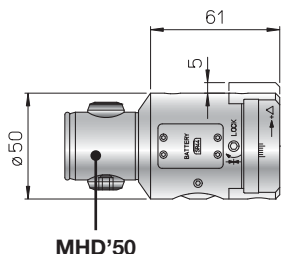

MHD'50

REF.	CODE	Kg.
TR-ELETTRA 50 MHD'50	455200500500	1.1

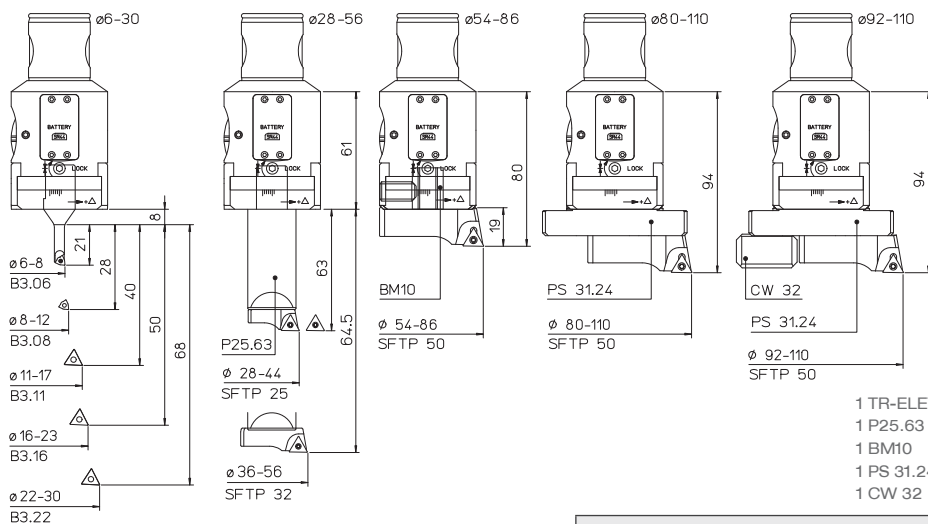
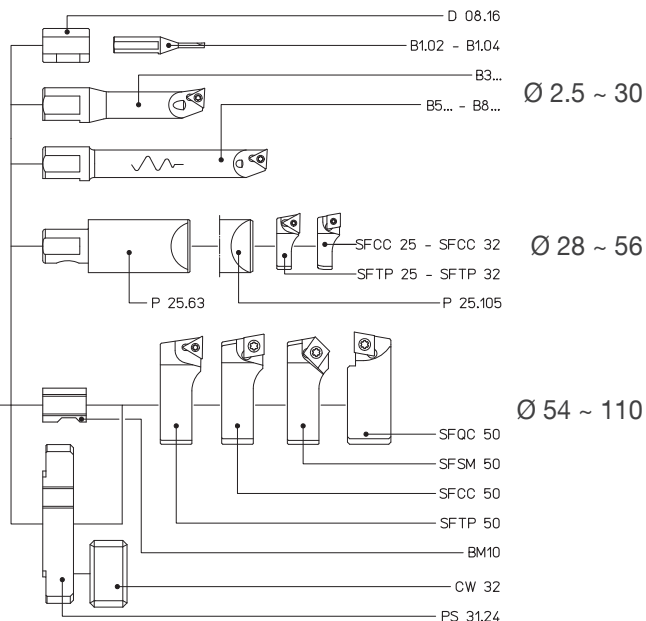

KIT K01

Ø 6 ~ 110



- 1 TR-ELETTRA 50 MHD'50
- 1 P25.63
- 1 BM10
- 1 PS 31.24
- 1 CW 32
- 1 B3.06
- 1 B3.08
- 1 B3.11
- 1 B3.16
- 1 B3.22
- 1 SFTP25
- 1 SFTP32
- 1 SFTP50
- 5 TPGX 090202L DC100
- 1 TPGX 110302L DC100
- 2 WCGT 020102L DC100

REF.	CODE	Ø
KIT K01 TR-ELETTRA 50 MHD'50	655200500500	6 ~ 110

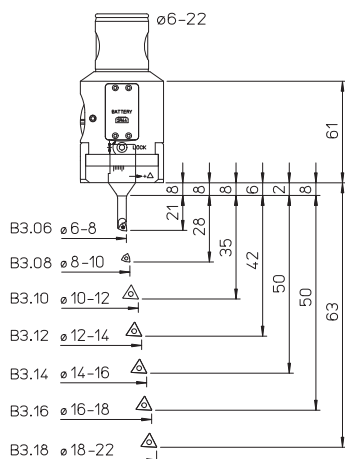

KIT K00

Ø 6 ~ 22



- 1 TR-ELETTRA 50 MHD'50
- 1 B3.06
- 1 B3.08
- 1 B3.10
- 1 B3.12
- 1 B3.14
- 1 B3.16
- 1 B3.18
- 5 TPGX 090202L DC100
- 2 WCGT 020102L DC100

REF.	CODE	Ø
KIT K00 TR-ELETTRA 50 MHD'50	655200500501	6 ~ 22



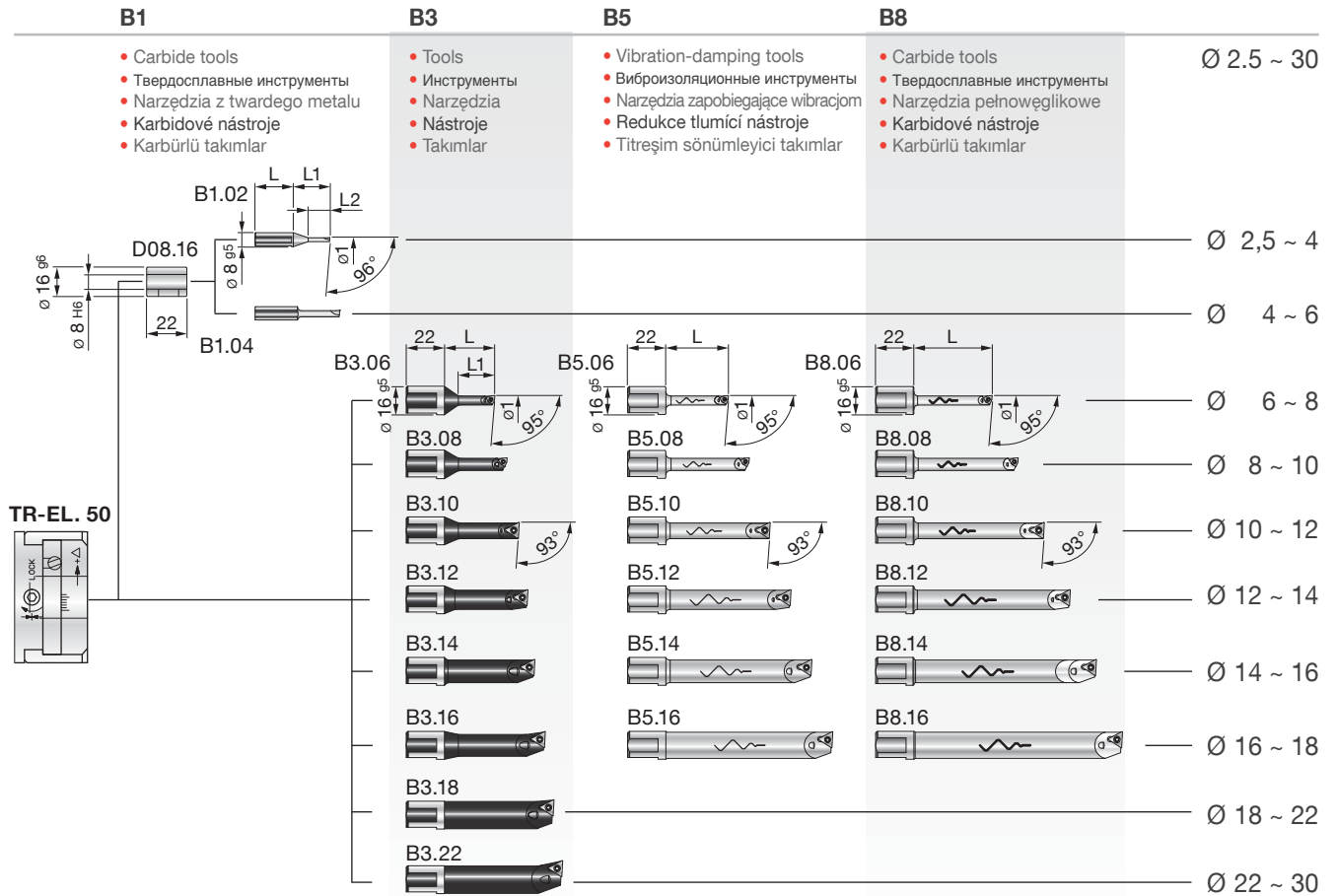

REF.	CODE	Kg.
D08.16	200560116082	0.02

REF.	CODE	Ø1	L	L1	L2	Kg.
B1.02	572010502001	2.5 ~ 4	22	21	12.5	0.02
B1.04	572010504001	4 ~ 6	24	24	-	

REF.	CODE	Ø1	L	L1	⊖	⊖	⊖	⊖	Kg.
B3.06	572010506001	6 ~ 8	29	21	WCGT 0201..	-	TS 21	TORX T06	0.035
B3.08	572010508001	8 ~ 10	36	28			TS 211		0.04
B3.10	572010510001	10 ~ 12	43	35	-	TPGX 0902..	CS 250 T	TORX T08	0.05
B3.11	572010511001	11 ~ 13	48	40					0.055
B3.12	572010512001	12 ~ 14	42	42					0.06
B3.14	572010514001	14 ~ 16	52	50					0.07
B3.16	572010516001	16 ~ 18	58	-	-	TPGX 0902..	CS 250 T	TORX T08	0.1
B3.18	572010518001	18 ~ 22	63	-					0.1
B3.22	572010522001	22 ~ 30	68	-					0.1

B5.06	572010506105	6 ~ 8	36	-	WCGT 0201..	-	TS 21	TORX T06	0.075
B5.08	572010508105	8 ~ 10	48				TS 211		0.09
B5.10	572010510105	10 ~ 12	60	-	TPGX 0902..	CS 250 T	TORX T08	0.1	
B5.12	572010512105	12 ~ 14	72					0.2	
B5.14	572010514105	14 ~ 16	84					0.3	
B5.16	572010516105	16 ~ 18	96					0.3	

B8.06	572010506108	6 ~ 8	45	-	WCGT 0201..	-	TS 21	TORX T06	0.065
B8.08	572010508108	8 ~ 10	60				TS 211		0.08
B8.10	572010510108	10 ~ 12	75	-	TPGX 0902..	CS 250 T	TORX T08	0.1	
B8.12	572010512108	12 ~ 14	90					0.2	
B8.14	572010514108	14 ~ 16	105					0.3	
B8.16	572010516108	16 ~ 18	120					0.3	

MHD'50

- TOOLHOLDERS FOR TESTAROSSA
- ДЕРЖАТЕЛИ ДЛЯ ГОЛОВКИ TESTAROSSA
- OPRAWKI NARZĘDZIOWE DO GŁOWIC TESTAROSSA
- NÁSTROJOVÉ DRŽÁKY PRO TESTAROSSA
- TESTAROSSA İÇİN TAKIM TUTUCULAR

PS 31
CW 32
Ø 54 ~ 110

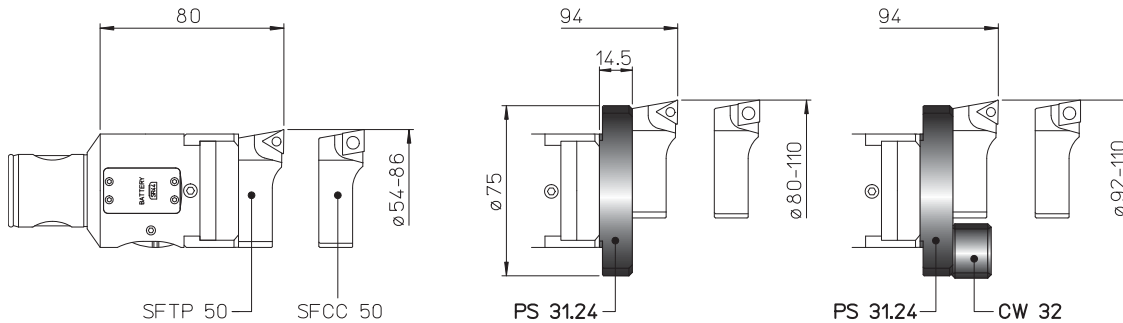

PS 31
Ø 56 ~ 113.5

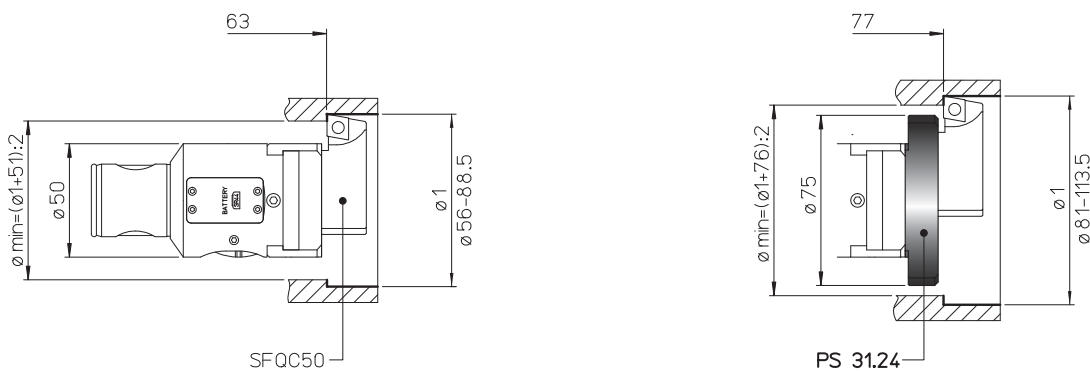

PS 31
Ø 52 ~ 111

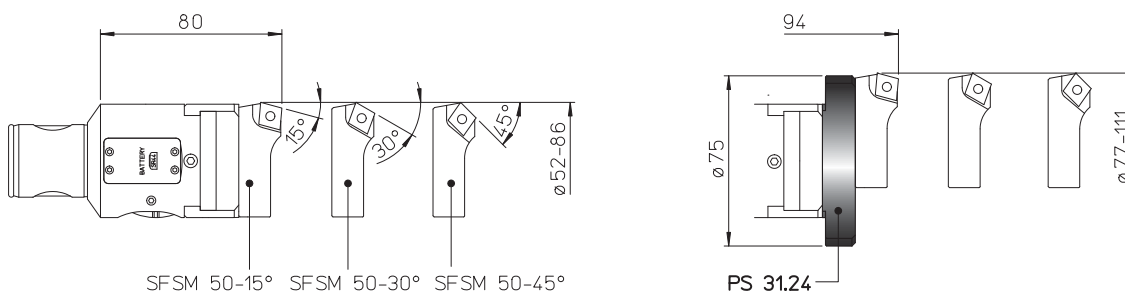

REF.	CODE	Kg.
PS 31.24 TR..50	433024140751	0.19
CW 32	392011003201	0.07



- TOOLHOLDERS FOR TESTAROSSA
- ДЕРЖАТЕЛИ ДЛЯ ГОЛОВКИ TESTAROSSA
- OPRAWKI NARZĘDZIOWE DO GŁÓWIC TESTAROSSA
- NÁSTROJOVÉ DRŽÁKY PRO TESTAROSSA
- TESTAROSSA İÇİN TAKIM TUTUCULAR

P 25
Ø 28 ~ 56

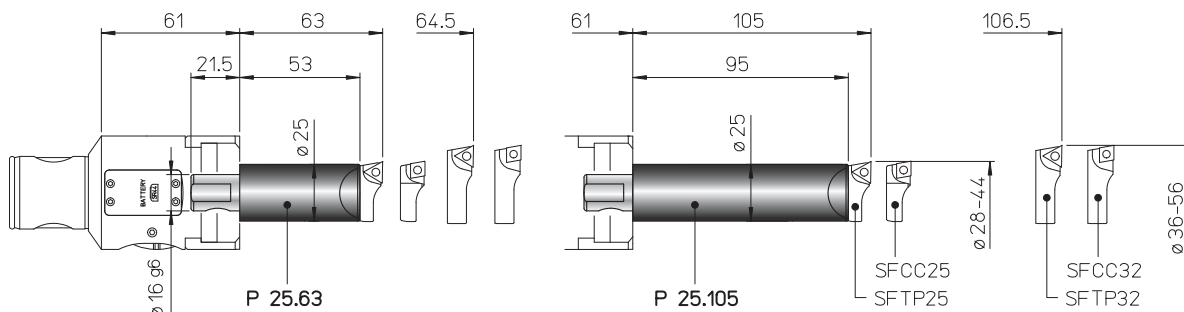

REF.	CODE	Kg.
P25.63 TR...	435116250631	0.5
P25.105 TR...	435116251051	0.8

- BIT-HOLDERS FOR TESTAROSSA
- КАССЕТЫ ДЛЯ ГОЛОВКИ TESTAROSSA
- OSTRZA DO GŁÓWIC TESTAROSSA
- HROTOVÉ DRŽÁKY TESTAROSSA
- TESTAROSSA İÇİN MATKAP KOVANLARI

SF

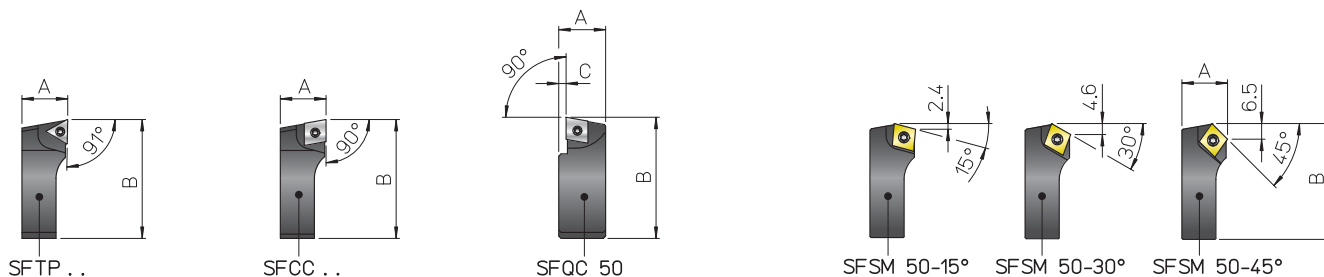

REF.	CODE	A	B	C					Kg.
SFTP 25	470500525001	10	26.5	-	TPGX 0902..	-	CS 250T	TORX T08	0.01
SFTP 32	470500532001	11.5	34.5	-	-	-	-	-	0.02
SFTP 50	470500550001	19	52	-	TPGX 1103..	-	CS 300890T	-	0.08
SFCC 25	470500525002	10	26.5	-	-	CCGT 0602..	TS 25	TORX T08	0.01
SFCC 32	470500532002	11.5	34.5	-	-	-	-	-	0.02
SFCC 50	470500550002	19	52	-	-	CCGT 09T3..	TS 4	TORX T15	0.08
SFQC 50	470500550062	20.5	53	3	-	CCMT 09T3..	TS 4	TORXT15	0.1
SFSM 50-15°	470500550011	19	50.5	-	-	CCMT 09T3..	TS 4	TORXT15	0.07
SFSM 50-30°	470500550013								
SFSM 50-45°	470500550015								



2 µm

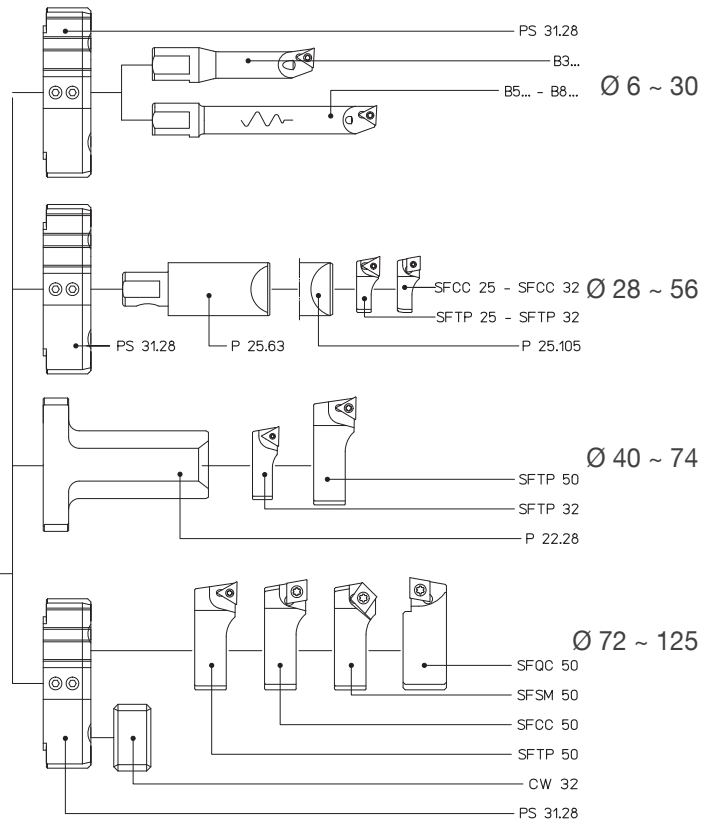
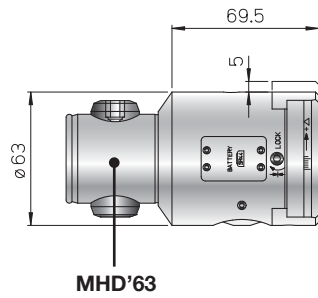

REF.	CODE	Kg.
TR-ELETTRA 63 MHD'63	455200630630	2.2

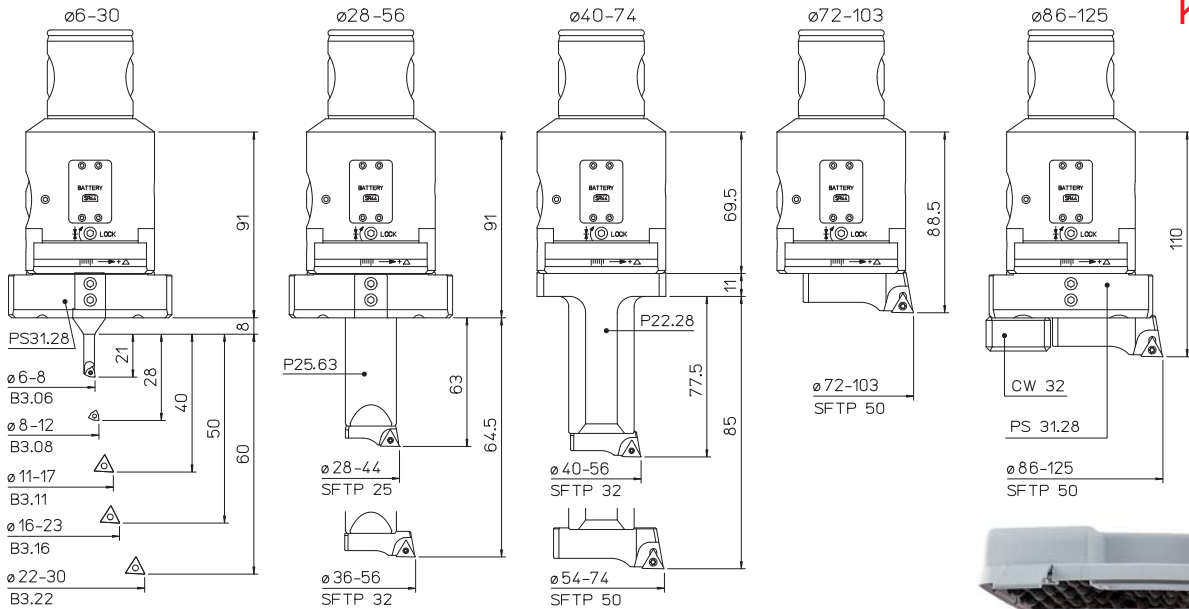

KIT K01
Ø 6 ~ 125



- 1 TR-ELETTRA 63 MHD'63
- 1 P25.63 1 B3.06 1 B3.22 5 TPGX 090202L DC100
- 1 P22.28 1 B3.08 1 SFTP25 1 TPGX 110302L DC100
- 1 PS 31.28 1 B3.11 1 SFTP32 2 WCGT 020102L DC100
- 1 CW 32 1 B3.16 1 SFTP50

REF.	CODE	Ø
KIT K01 TR-ELETTRA 63 MHD'63	655200500630	6 ~ 125

119 120 116 241



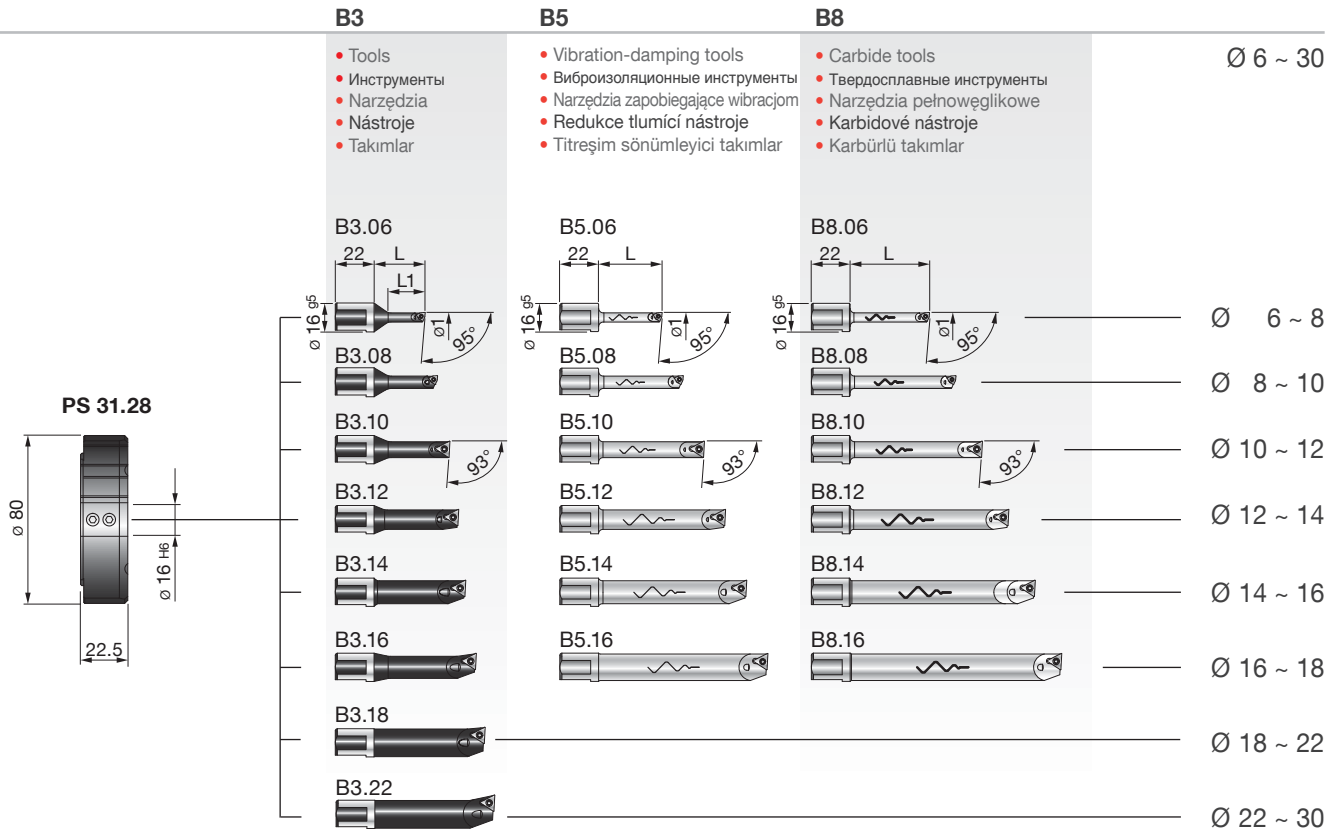

REF.	CODE	Kg.
PS 31.28 TR-ELETTRA 63	433028220802	0.3

REF.	CODE	Ø1	L	L1	⚠	⚠	🔧	🔧	Kg.
B3.06	57 201 05 06 001	6 ~ 8	29	21	WCGT 0201..	-	TS 21	TORX T06	0.035
B3.08	57 201 05 08 001	8 ~ 10	36	28			TS 211		0.04
B3.10	57 201 05 10 001	10 ~ 12	43	35	-	TPGX 0902..	CS 250 T	TORX T08	0.05
B3.11	57 201 05 11 001	11 ~ 13	48	40					0.055
B3.12	57 201 05 12 001	12 ~ 14	48	42					0.06
B3.14	57 201 05 14 001	14 ~ 16	52	50	-	TPGX 0902..	CS 250 T	TORX T08	0.07
B3.16	57 201 05 16 001	16 ~ 18	58						0.07
B3.18	57 201 05 18 001	18 ~ 22	63	-	-	-	-	-	0.1
B3.22	57 201 05 22 001	22 ~ 30	68	-	-	-	-	-	0.1

B5.06	57 201 05 06 105	6 ~ 8	36	-	WCGT 0201..	-	TS 21	TORX T06	0.075
B5.08	57 201 05 08 105	8 ~ 10	48				TS 211		0.09
B5.10	57 201 05 10 105	10 ~ 12	60	-	TPGX 0902..	CS 250 T	TORX T08	0.1	
B5.12	57 201 05 12 105	12 ~ 14	72					0.2	
B5.14	57 201 05 14 105	14 ~ 16	84					0.3	
B5.16	57 201 05 16 105	16 ~ 18	96	-	-	-	-	-	0.3

B8.06	57 201 05 06 108	6 ~ 8	45	-	WCGT 0201..	-	TS 21	TORX T06	0.065
B8.08	57 201 05 08 108	8 ~ 10	60				TS 211		0.08
B8.10	57 201 05 10 108	10 ~ 12	75	-	TPGX 0902..	CS 250 T	TORX T08	0.1	
B8.12	57 201 05 12 108	12 ~ 14	90					0.2	
B8.14	57 201 05 14 108	14 ~ 16	105					0.3	
B8.16	57 201 05 16 108	16 ~ 18	120					0.3	



MHD'63

- TOOLHOLDERS FOR TESTAROSSA
- ДЕРЖАТЕЛИ ДЛЯ ГОЛОВКИ TESTAROSSA
- OPRAWKI NARZĘDZIOWE DO GŁOWIC TESTAROSSA
- NÁSTROJOVÉ DRŽÁKY PRO TESTAROSSA
- TESTAROSSA İÇİN TAKIM TUTUCULAR

PS 31
CW 32
Ø 72~125

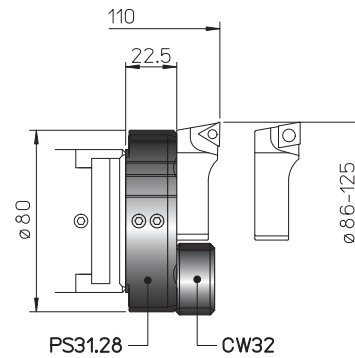
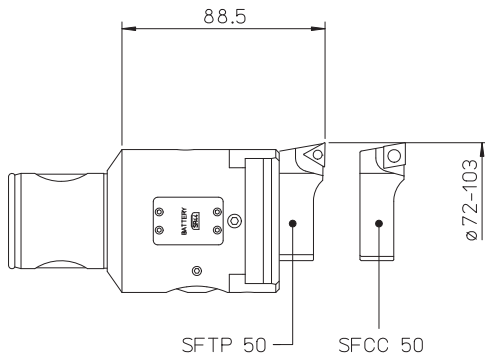

PS 31
Ø 72.5 ~ 129.5

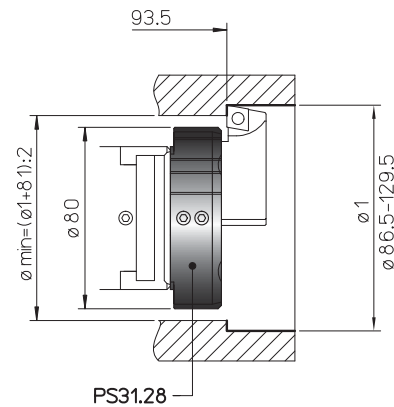
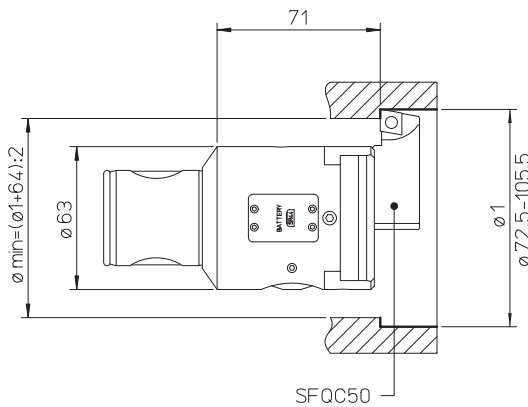

PS 31
Ø 69 ~ 127

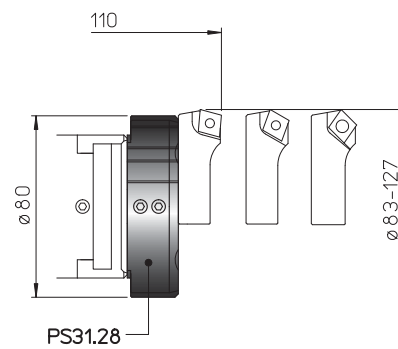
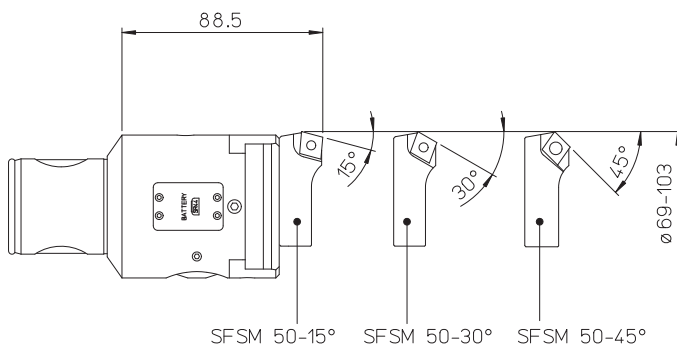

REF.	CODE	Kg.
PS 31.28 TR-ELETTRA 63	433028220802	0.3
CW 32	392011003201	0.07

119



125



- TOOLHOLDERS FOR TESTAROSSA
- ДЕРЖАТЕЛИ ДЛЯ ГОЛОВКИ TESTAROSSA
- OPRAWKI NARZĘDZIOWE DO GŁOWIC TESTAROSSA
- NÁSTROJOVÉ DRŽÁKY PRO TESTAROSSA
- TESTAROSSA İÇİN TAKIM TUTUCULAR

P 25
Ø 28 ~ 56

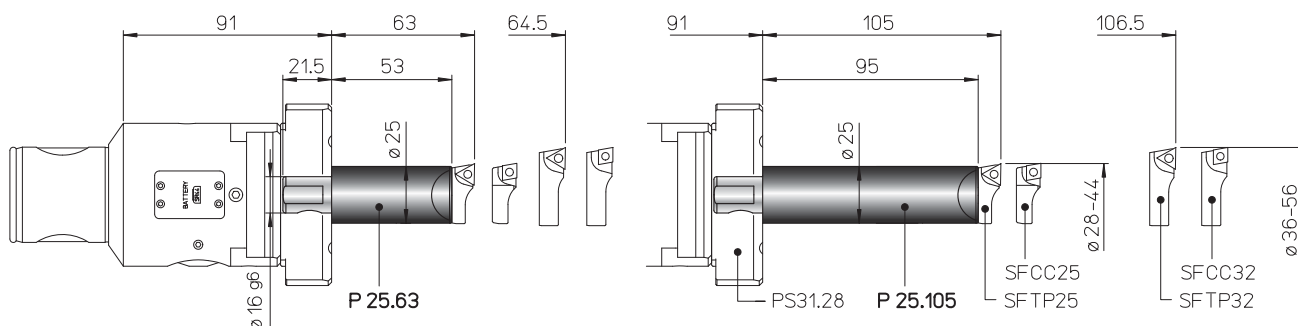

REF.	CODE	Kg.
P25.63 TR...	435116250631	0.5
P25.105 TR...	435116251051	0.8

P 22

Ø 40 ~ 74

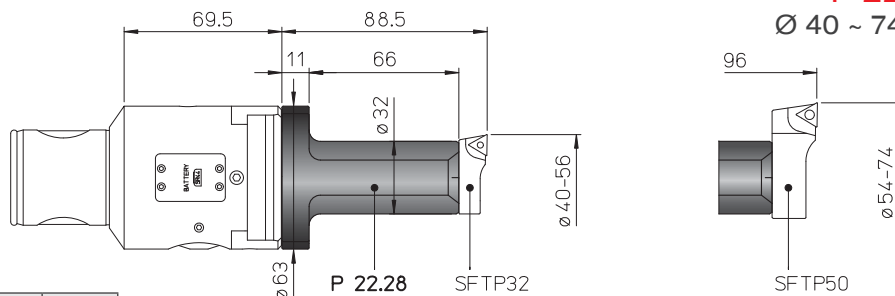

REF.	CODE	Kg.
P 22.28	433028220631	0.45

- BIT-HOLDERS FOR TESTAROSSA
- КАССЕТЫ ДЛЯ ГОЛОВКИ TESTAROSSA
- OSTRZA DO GŁOWIC TESTAROSSA
- HROTOVÉ DRŽÁKY TESTAROSSA
- TESTAROSSA İÇİN MATKAP KOVANLARI

SF

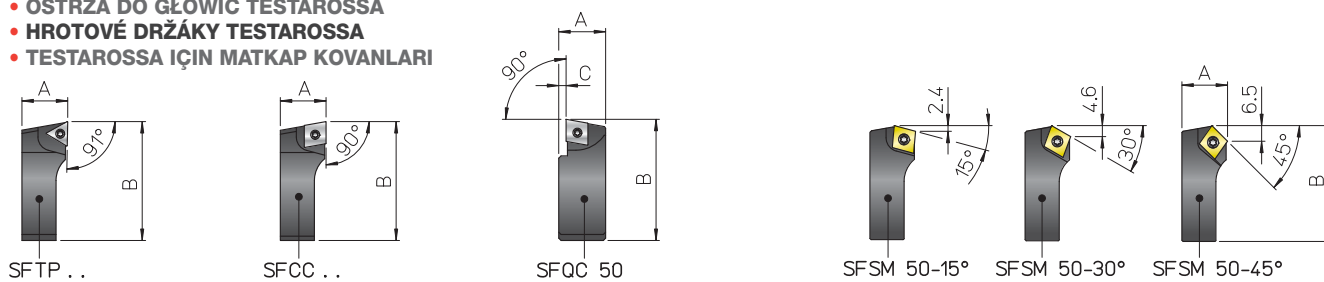

REF.	CODE	A	B	C	△	□	⊥	⌘	Kg.
SFTP 25	470500525001	10	26.5	-	TPGX 0902..	-	CS 250T	TORX T08	0.01
SFTP 32	470500532001	11.5	34.5	-	-	-	CS 300890T	TORX T08	0.02
SFTP 50	470500550001	19	52	-	TPGX 1103..	-	CS 300890T	TORX T15	0.08
SFCC 25	470500525002	10	26.5	-	-	CCGT 0602..	TS 25	TORX T08	0.01
SFCC 32	470500532002	11.5	34.5	-	-	CCGT 09T3..	TS 4	TORX T15	0.02
SFCC 50	470500550002	19	52	-	-	CCGT 09T3..	TS 4	TORX T15	0.08
SFQC 50	470500550062	20.5	53	3	-	CCMT 09T3..	TS 4	TORXT15	0.1
SFSM 50-15°	470500550011	19	50.5	-	-	CCMT 09T3..	TS 4	TORXT15	0.07
SFSM 50-30°	470500550013								
SFSM 50-45°	470500550015								

116

125

119





2 µm

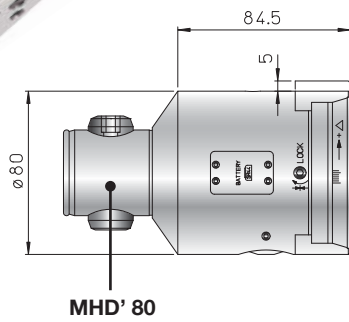

MHD'80

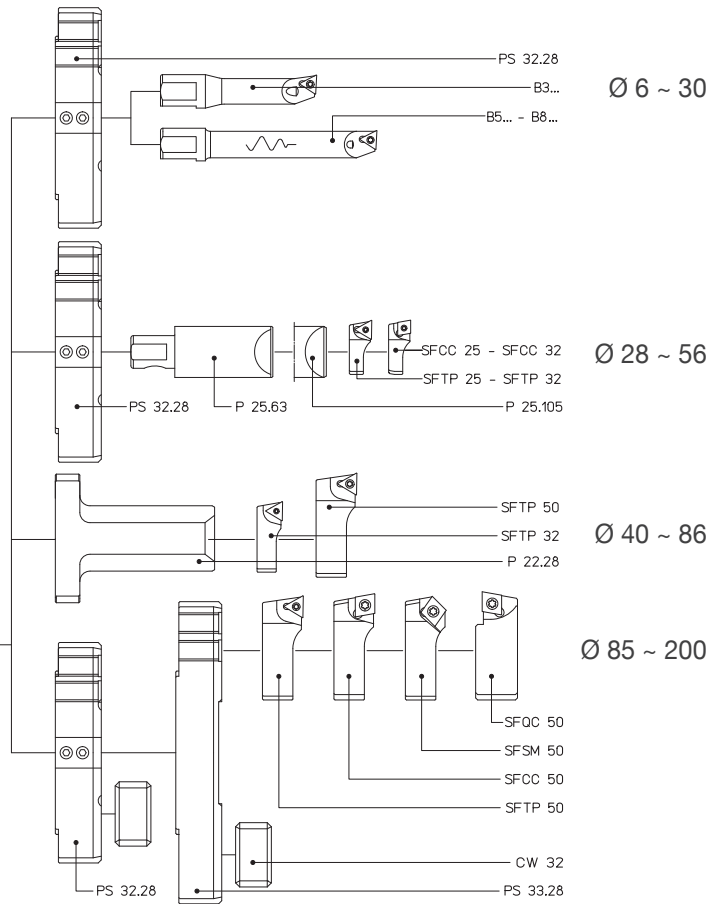

REF.	CODE	Kg.
TR-ELETTRA 80 MHD'80	455200800800	3.9

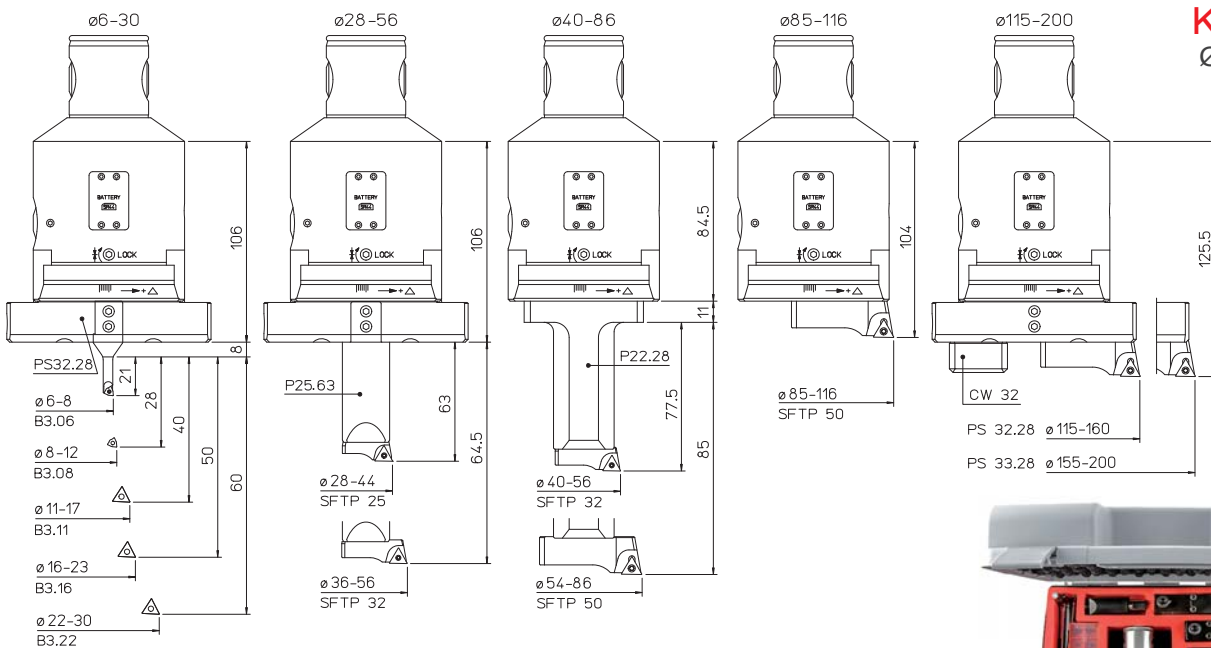

KIT K01
Ø 6 ~ 200

- 1 TR-ELETTRA 80 MHD'80
- 1 P25.63 1 CW 32 1 B3.16 1 SFTP50
- 1 P22.28 1 B3.06 1 B3.22 5 TPGX 090202L DC100
- 1 PS 32.28 1 B3.08 1 SFTP25 1 TPGX 110302L DC100
- 1 PS 33.28 1 B3.11 1 SFTP32 2 WCGT 020102L DC100

REF.	CODE	Ø
K01 TR-ELETTRA 80 MHD'80	655200500800	6 ~ 200



119 120 116 241



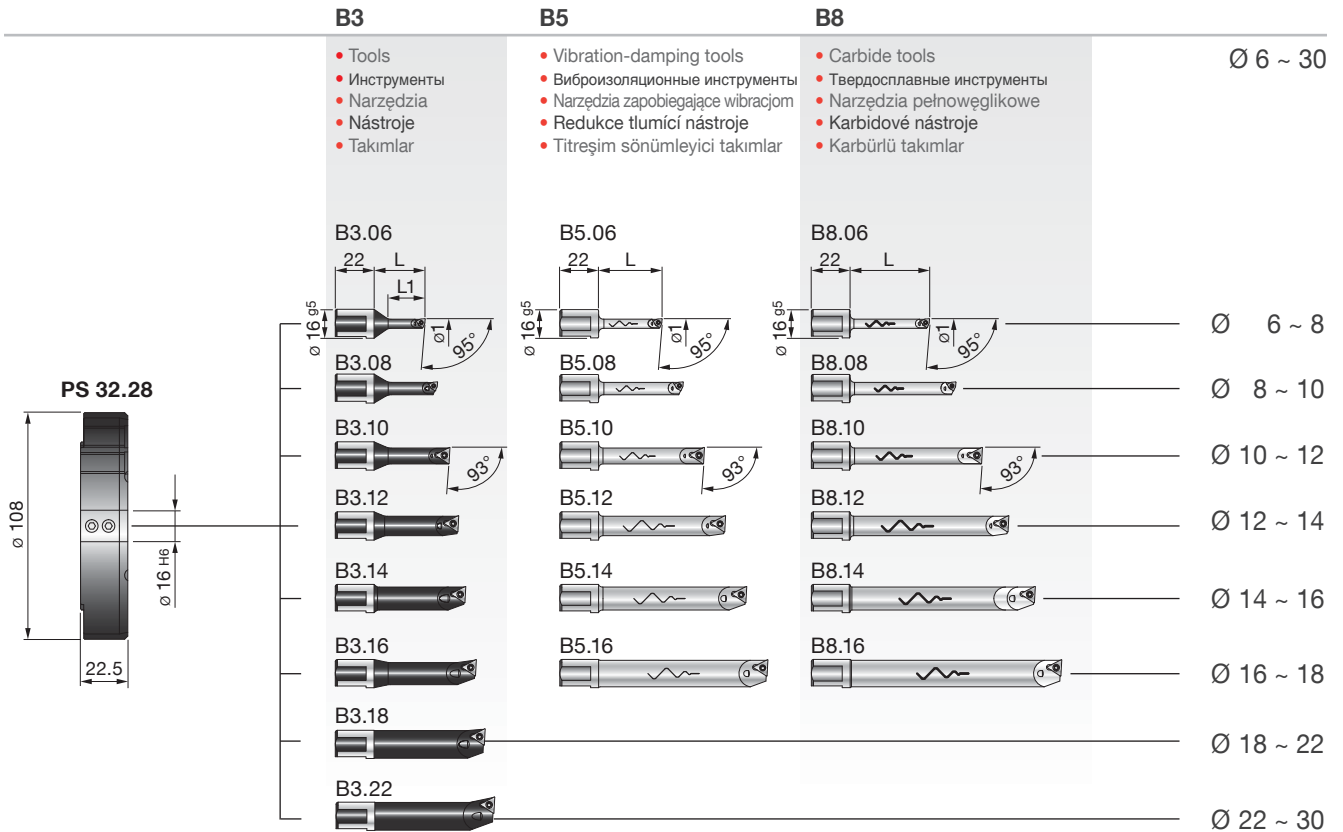

REF.	CODE	Kg.
PS 32.28 TR-ELETTRA 80	433028221082	0.5

REF.	CODE	Ø1	L	L1	⚠	⚠	🔧	🔧	Kg.
B3.06	572010506001	6 ~ 8	29	21	WCGT 0201..	-	TS 21	TORX T06	0.035
B3.08	572010508001	8 ~ 10	36	28			TS 211		0.04
B3.10	572010510001	10 ~ 12	43	35	-	TPGX 0902..	CS 250 T	TORX T08	0.05
B3.11	572010511001	11 ~ 13	48	40					0.055
B3.12	572010512001	12 ~ 14	48	42					0.06
B3.14	572010514001	14 ~ 16	52	50	-	TPGX 0902..	CS 250 T	TORX T08	0.07
B3.16	572010516001	16 ~ 18	58	50					0.07
B3.18	572010518001	18 ~ 22	63	-	-	TPGX 0902..	CS 250 T	TORX T08	0.1
B3.22	572010522001	22 ~ 30	68	-					0.1
B5.06	572010506105	6 ~ 8	36	-	WCGT 0201..	-	TS 21	TORX T06	0.075
B5.08	572010508105	8 ~ 10	48				28		TS 211
B5.10	572010510105	10 ~ 12	60	-	-	TPGX 0902..	CS 250 T	TORX T08	0.1
B5.12	572010512105	12 ~ 14	72						0.2
B5.14	572010514105	14 ~ 16	84						0.3
B5.16	572010516105	16 ~ 18	96	-	-	TPGX 0902..	CS 250 T	TORX T08	0.3
B8.06	572010506108	6 ~ 8	45	-					WCGT 0201..
B8.08	572010508108	8 ~ 10	60		28	TS 211	0.08		
B8.10	572010510108	10 ~ 12	75	-	-	TPGX 0902..	CS 250 T	TORX T08	0.1
B8.12	572010512108	12 ~ 14	90						0.2
B8.14	572010514108	14 ~ 16	105						0.3
B8.16	572010516108	16 ~ 18	120	-	-	TPGX 0902..	CS 250 T	TORX T08	0.3
B8.16	572010516108	16 ~ 18	120	-					0.3



MHD'80

- TOOLHOLDERS FOR TESTAROSSA
- ДЕРЖАТЕЛИ ДЛЯ ГОЛОВКИ TESTAROSSA
- OPRAWKI NARZĘDZIOWE DO GŁOWIC TESTAROSSA
- NÁSTROJOVÉ DRŽÁKY PRO TESTAROSSA
- TESTAROSSA İÇİN TAKIM TUTUCULAR

PS

CW 32

Ø 85~ 200

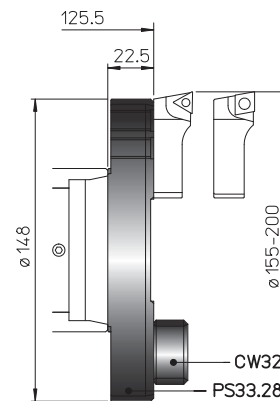
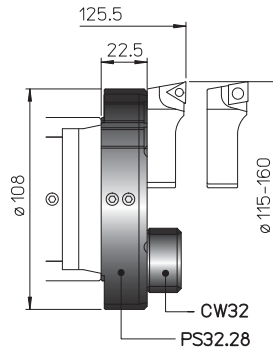
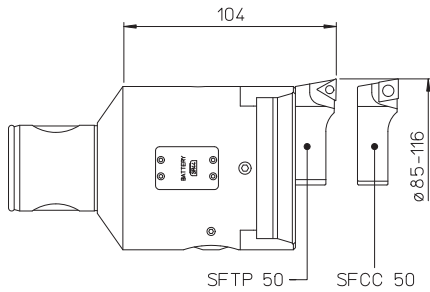

PS

Ø 85.5 ~ 202.5

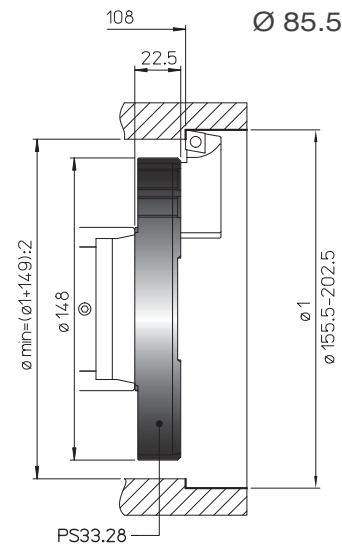
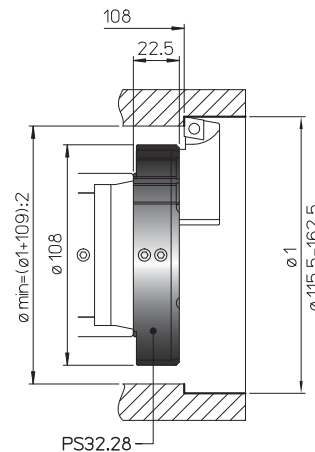
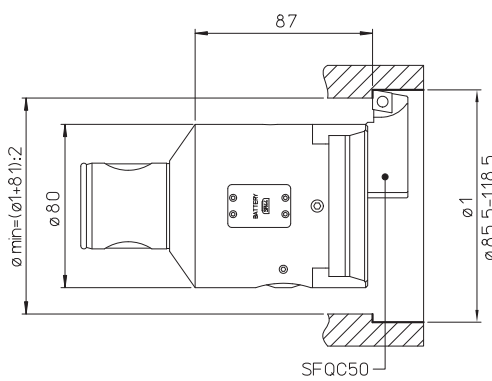

PS

Ø 82 ~ 200

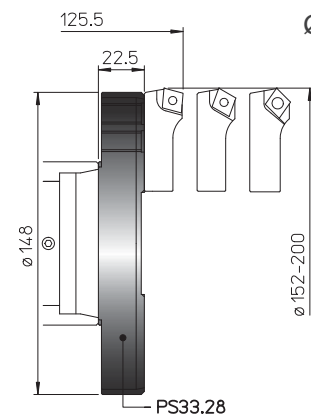
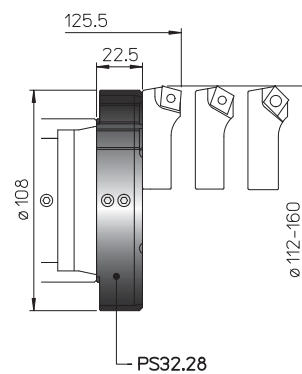
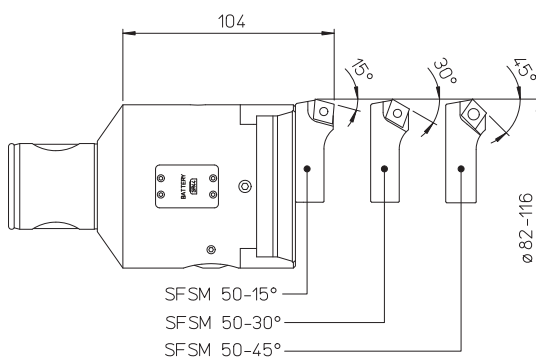

REF.	CODE	Kg.
PS 32.28 TR-ELETTRA 80	433028221082	0.5
PS 33.28 TR-ELETTRA 80	433028221482	0.6
CW 32	392011003201	0.07

119



125



- TOOLHOLDERS FOR TESTAROSSA
- ДЕРЖАТЕЛИ ДЛЯ ГОЛОВКИ TESTAROSSA
- OPRAWKI NARZĘDZIOWE DO GŁOWIC TESTAROSSA
- NÁSTROJOVÉ DRŽÁKY PRO TESTAROSSA
- TESTAROSSA İÇİN TAKIM TUTUCULAR

P 25
Ø 28 ~ 56

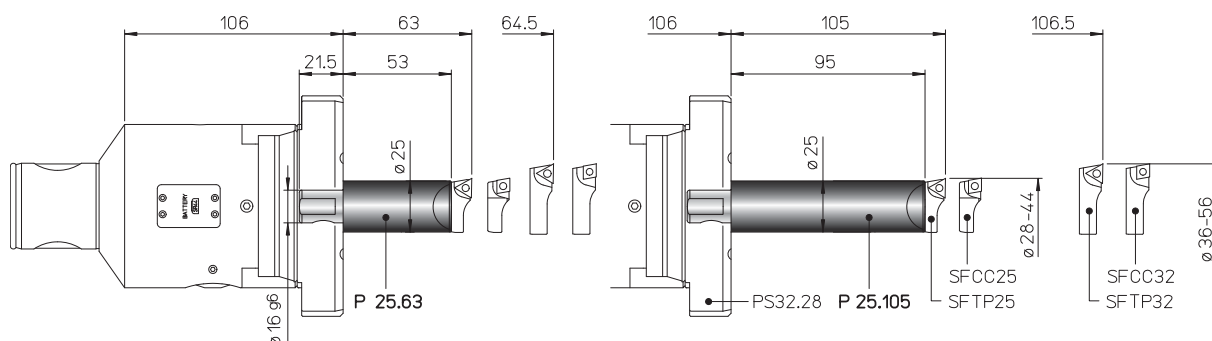

REF.	CODE	Kg.
P25.63 TR...	435116250631	0.5
P25.105 TR...	435116251051	0.8

P 22
Ø 40 ~ 86

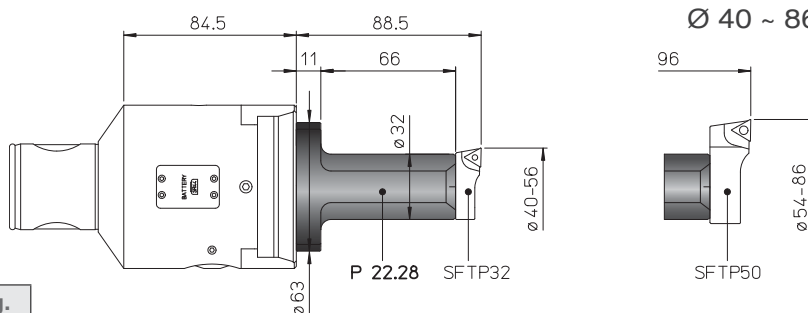

REF.	CODE	Kg.
P 22.28	433028220631	0.45

- BIT-HOLDERS FOR TESTAROSSA
- КАССЕТЫ ДЛЯ ГОЛОВКИ TESTAROSSA
- OSTRZA DO GŁOWIC TESTAROSSA
- HROTOVÉ DRŽÁKY TESTAROSSA
- TESTAROSSA İÇİN MATKAP KOVANLARI

SF

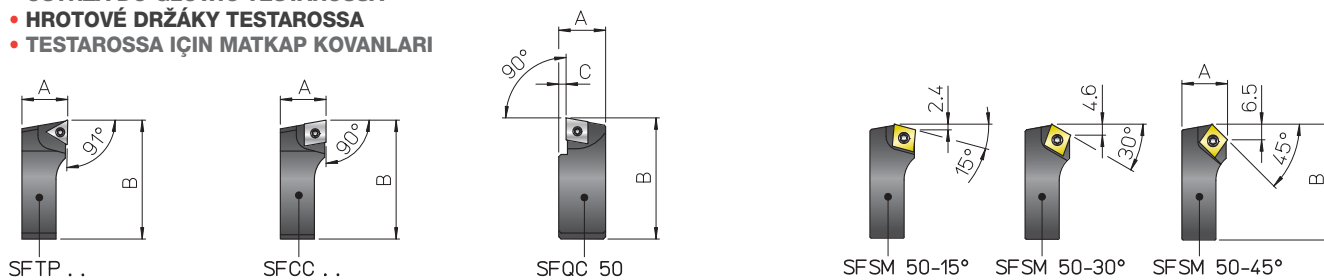

REF.	CODE	A	B	C	△	□	⊥	⌘	Kg.
SFTP 25	470500525001	10	26.5	-	TPGX 0902..	-	CS 250T	TORX T08	0.01
SFTP 32	470500532001	11.5	34.5	-	-	-	CS 300890T	TORX T08	0.02
SFTP 50	470500550001	19	52	-	TPGX 1103..	-	-	TORX T15	0.08
SFCC 25	470500525002	10	26.5	-	-	CCGT 0602..	TS 25	TORX T08	0.01
SFCC 32	470500532002	11.5	34.5	-	-	-	-	TORX T08	0.02
SFCC 50	470500550002	19	52	-	-	CCGT 09T3..	TS 4	TORX T15	0.08
SFQC 50	470500550062	20.5	53	3	-	CCMT 09T3..	TS 4	TORXT15	0.1
SFSM 50-15°	470500550011	19	50.5	-	-	CCMT 09T3..	TS 4	TORXT15	0.07
SFSM 50-30°	470500550013								
SFSM 50-45°	470500550015								