

- 1 • Body
• Корпус
• Korpus
• Tělo
• Gövde

- 2 • Slide toolholder
• Салазки
• Sanie narzędziowe
• Nástrojový držák šoupátka
• Kayar takim tutucu

- 3 • Expanding radial pin
• Разжимной радиальный штифт
• Promieniowy sworzeń rozporowy
• Rozširujúci radiálny kolík
• Radyal genişletme pimi

- 4 • Micrometric vernier scale
• Микрометрический нониус
• Noniusz mikrometryczny
• Mikrometrické měřítko vernier
• Mikrometrik verniye skalası

- 5 • Slide clamp screw
• Зажимные винты салазок
• Śruba blokująca sanie narzędziowe
• Upínací šroub šoupátka
• Sürgülü sıkma vidası

- 6 • Coolant outlet
• Выход хладагента
• Wylot cieczy chłodzącej
• Výstup chladicí kapaliny
• Soğutma sıvısı çıkışı

- 7 • Tools clamp screws
• Зажимные винты инструмента
• Śruba blokująca narzędzie
• Upínací šrouby nástroje
• Takımların sıkma vidaları

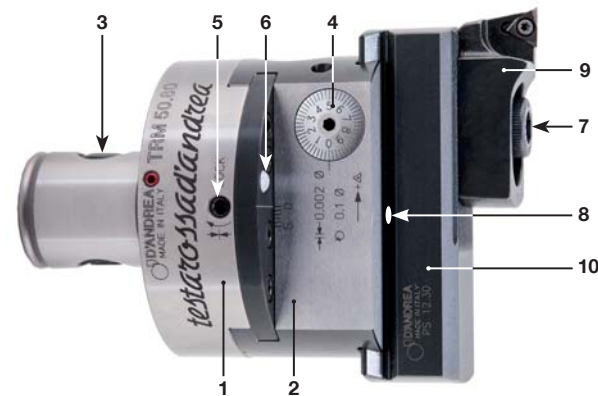
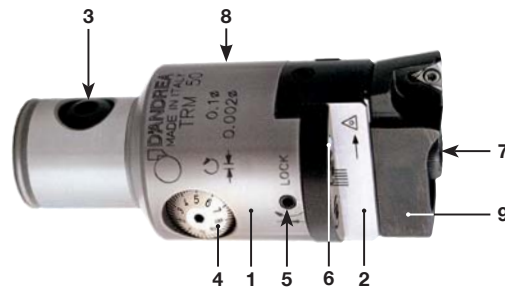

2 μm



- 8 • Oiler
• Масленка
• Smarownica
• Olejnička
• Yağlayıcı

- 9 • Bit holder
• Кассета головки
• Wytaczak
• Hrotový držák
• Matkap kovani

- 10 • Tool holder
• Держатель
• Oprawka narzędziowa
• Nástrojový držák
• Takım tutucu

GB FEATURES. The TRM heads in the D'Andrea Testarossa line have protective rustproof coating. High precision work to IT6 tolerance, with excellent surface finish, is achieved using TRM boring heads. These are very sensitive and radial correction of 1 micron can be effected directly on the machine and easily read on the vernier scale.

RU ХАРАКТЕРИСТИКИ. Головки TRM линии Testarossa D'Andrea оснащены защитным антикоррозийным покрытием. Головки TRM обеспечивают высокую точность с допусками по классу IT6 с исключительной чистотой поверхности. Они очень чувствительны и радиальная коррекция в 1 микрон может быть осуществлена прямо на станке и легко считана по шкале нониуса.

PL CECHY. Głowice serii TRM, pochodzące z nowej linii Testarossa firmy D'Andrea, posiadają dodatkową ochronną powłokę antykorozyjną. Głowice TRM umożliwiają obróbkę o bardzo wysokiej dokładności w tolerancji IT6 i gwarantują uzyskanie doskonałej jakości powierzchni. Dokładność ustawcza głowic wynosi 1 mikrometr na promieniu. Wartość ta jest łatwa do odczytania bezpośrednio na noniuszu głowicy co umożliwia dokonywanie regulacji bezpośrednio na obrabiarce.

CZ VLASTNOSTI. Hlavy TRM v řadě Testarossa společnosti D'Andrea mají rezuzvdornou povrchovou úpravu. Pomocí vyvrtávacích hlav TRM se docílí vysoce přesné obrábění dle tolerance IT6 s vynikající finální úpravou povrchu. Jsou velmi citlivé a radiální korekci 1 mikronu lze provést přímo na stroji a snadno odečíst na měřítku vernier.

TR ÖZELLİKLER. D'Andrea Testarossa ürün gamındaki TRM kafaları, koruyucu paslanmaz kaplamaya sahiptir. TRM matkap başları kullanılarak IT6 toleransa kadar yüksek hassasiyetli çalışma ve mükemmel yüzey bitirme gerçekleştirilir. Bunlar son derece hassastırlar ve 1 mikron radyal düzeltme doğrudan makine üzerinde gerçekleştirilip verniye skalasında kolayca okunabilir.sul raggio, facilmente leggibile sul nonio ed eseguibile anche in macchina.

TRM 16

Ø 18 ~ 23



TRM 20

Ø 22 ~ 29



TRM 25

Ø 28 ~ 38



TRM 32

Ø 35.5 ~ 51.5



TRM 40

Ø 48 ~ 63

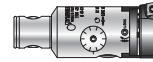

TRM 50

Ø 2.5 ~ 108

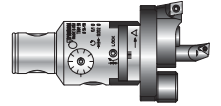

TRM 50/63

Ø 6 ~ 125



TRM 63/63

Ø 6 ~ 125



TRM 50/80

Ø 6 ~ 160



TRM 80/80

Ø 6 ~ 160



TRM 80/125

Ø 36 ~ 500

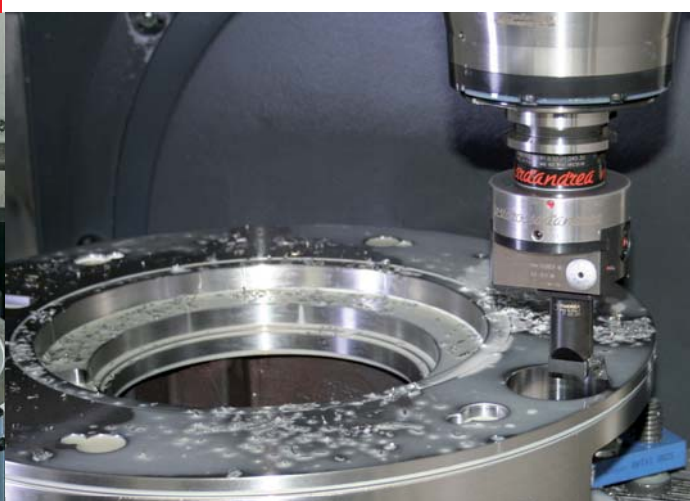
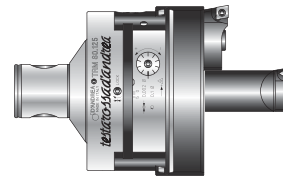

D'ANDREA MODULHARD'ANDREA

TRM 16~40 Ø 18 ~ 63

• TESTAROSSA

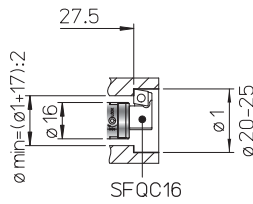
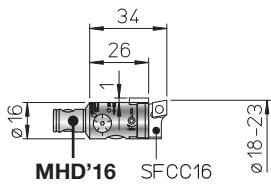
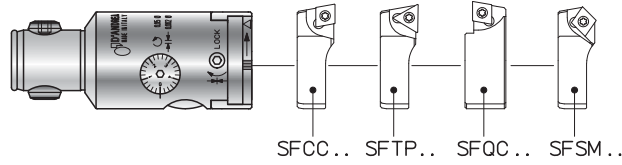

TRM 16
Ø 18 ~ 23

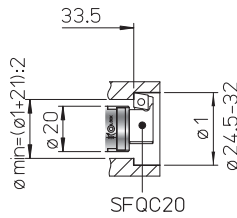
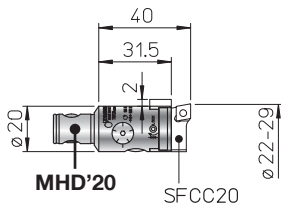

TRM 20
Ø 22 ~ 29

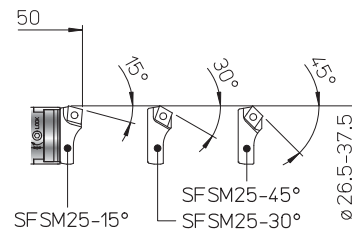
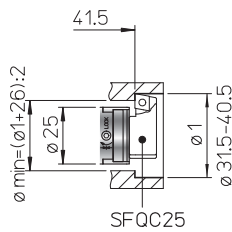
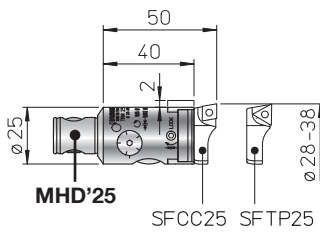

TRM 25
Ø 28 ~ 38

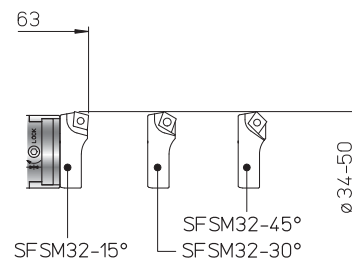
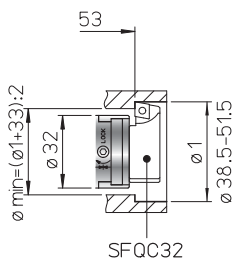
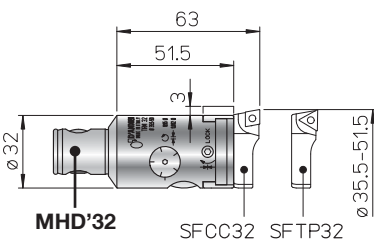

TRM 32
Ø 35.5 ~ 51.5

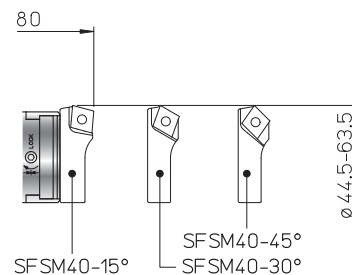
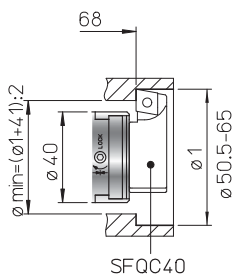
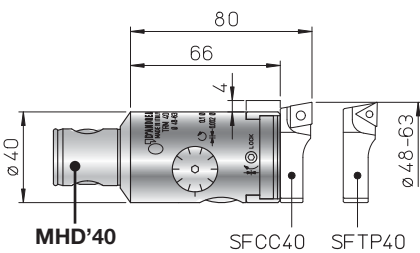

TRM 40
Ø 48 ~ 63



TRM



2 μm

REF.	CODE	Kg.
TRM 16	455001600341	0.05
TRM 20	455002000401	0.1
TRM 25	455002500500	0.2
TRM 32	455003200630	0.35
TRM 40	455004000800	0.7

- BIT-HOLDERS FOR TESTAROSSA
- КАССЕТЫ ДЛЯ ГОЛОВКИ TESTAROSSA
- OSTRZA DO GŁOWIC TESTAROSSA
- HROTOVÉ DRŽÁKY TESTAROSSA
- TESTAROSSA İÇİN MATKAP KOVANLARI

SF

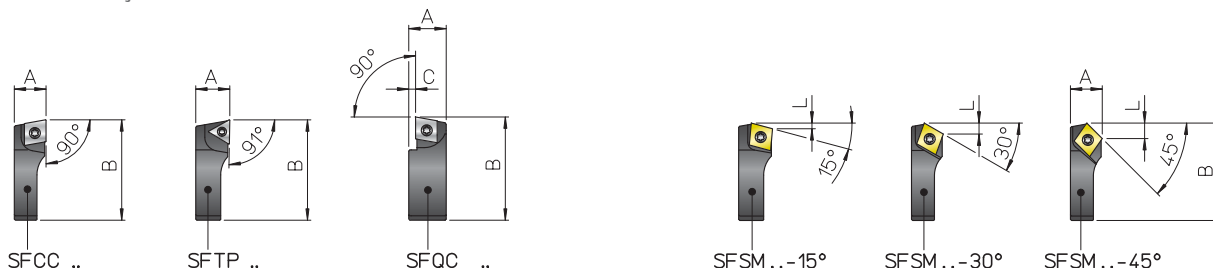

REF.	CODE	A	B	C	L	☐	△	⌊	🔩	Kg.
SFCC 16	470500516002	8	17							0.003
SFCC 20	470500520002	8.5	21							0.005
SFCC 25	470500525002	10	26.5	-	-	CCGT 0602..	-	TS 25	TORX T08	0.01
SFCC 32	470500532002	11.5	34.5							0.02
SFCC 40	470500540002	14	44	-	-	CCGT 09T3..	-	TS 4	TORX T15	0.04
SFTP 25	470500525001	10	26.5	-	-	-	TPGX 0902..	CS 250T	TORX T08	0.01
SFTP 32	470500532001	11.5	34.5							0.02
SFTP 40	470500540001	14	44	-	-	-	TPGX 1103..	CS 300890T		0.04
SFQC 16	470500516062	10	18	2						0.005
SFQC 20	470500520062	10.5	22.5							0.008
SFQC 25	470500525062	12	28.5	2.5		CCMT 0602..	-	TS 25	TORX T08	0.01
SFQC 32	470500532062	13.5	35.5							0.03
SFQC 40	470500540062	16.5	46	3		CCMT 09T3..	-	TS 4	TORXT15	0.06
SFSM 25-15°	470500525011				1.6					
SFSM 25-30°	470500525013	10	25.5	-	3					0.01
SFSM 25-45°	470500525015				4.3					
SFSM 32-15°	470500532011				1.6					
SFSM 32-30°	470500532013	11.5	33.5	-	3	CCMT 0602..	-	TS 25	TORX T08	0.02
SFSM 32-45°	470500532015				4.3					
SFSM 40-15°	470500540011				2.4					
SFSM 40-30°	470500540013	14	42.5	-	4.6	CCMT 09T3..	-	TS 4	TORXT15	0.03
SFSM 40-45°	470500540015				6.6					

116

120

119



D'ANDREA MODULHARD'ANDREA

TRM 50 Ø 2.5 ~ 108

• TESTAROSSA



2 µm

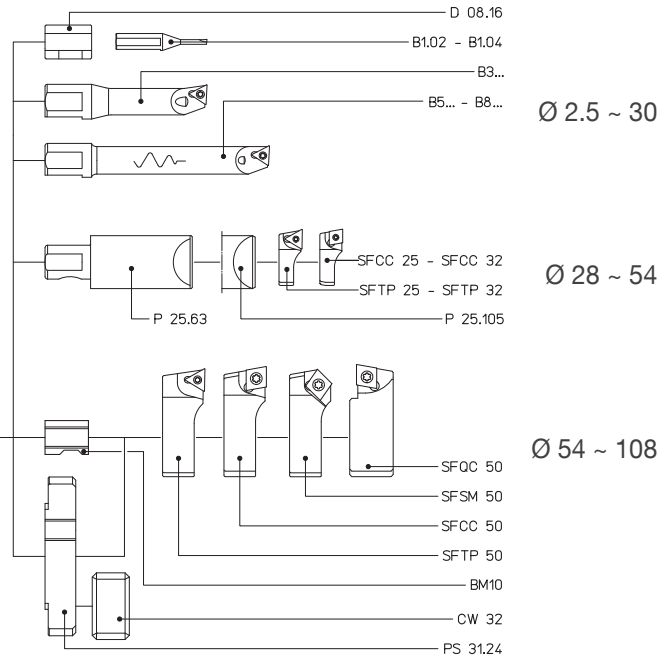
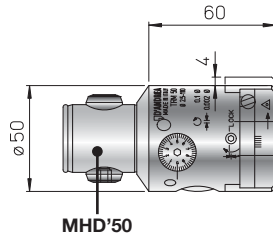

REF.	CODE	Kg.
TRM 50	455005000500	1

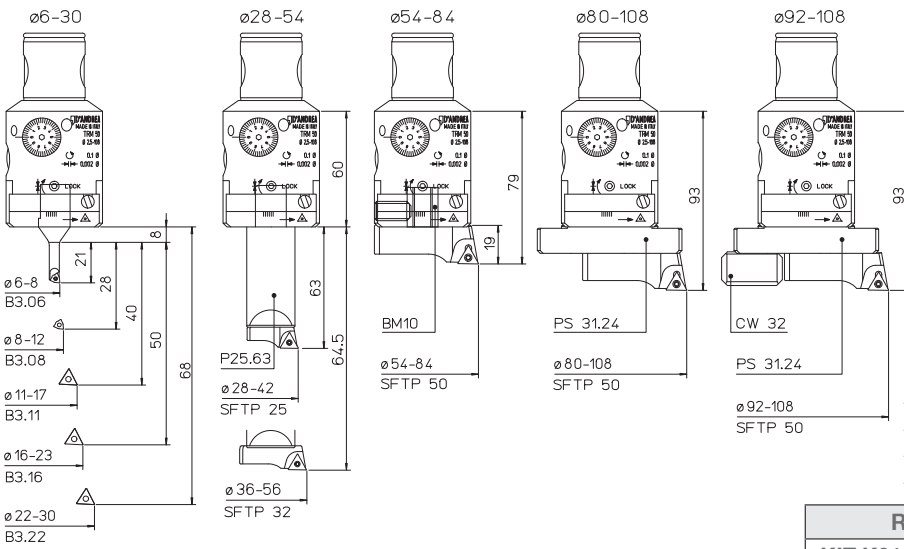

KIT K01
Ø 6 ~ 108



- 1 TRM 50
- 1 P25.63
- 1 BM10
- 1 PS 31.24
- 1 CW 32
- 1 B3.06
- 1 B3.08
- 1 B3.11
- 1 B3.16
- 1 B3.22
- 1 SFTP25
- 1 SFTP50
- 1 SFTP50
- 5 TPGX 090202L DC100
- 1 TPGX 110302L DC100
- 2 WCGT 020102L DC100

REF.	CODE	Ø
KIT K01 TRM 50	655005010501	6 ~ 108

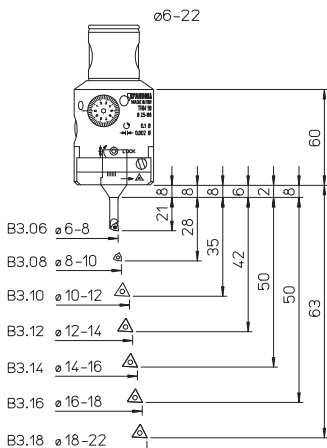

KIT K00
Ø 6 ~ 22



- 1 TRM50
- 1 B3.06
- 1 B3.08
- 1 B3.10
- 1 B3.12
- 1 B3.14
- 1 B3.16
- 1 B3.18
- 5 TPGX 090202L DC100
- 2 WCGT 020102L DC100

REF.	CODE	Ø
KIT K00 TRM 50	655005010500	6 ~ 22



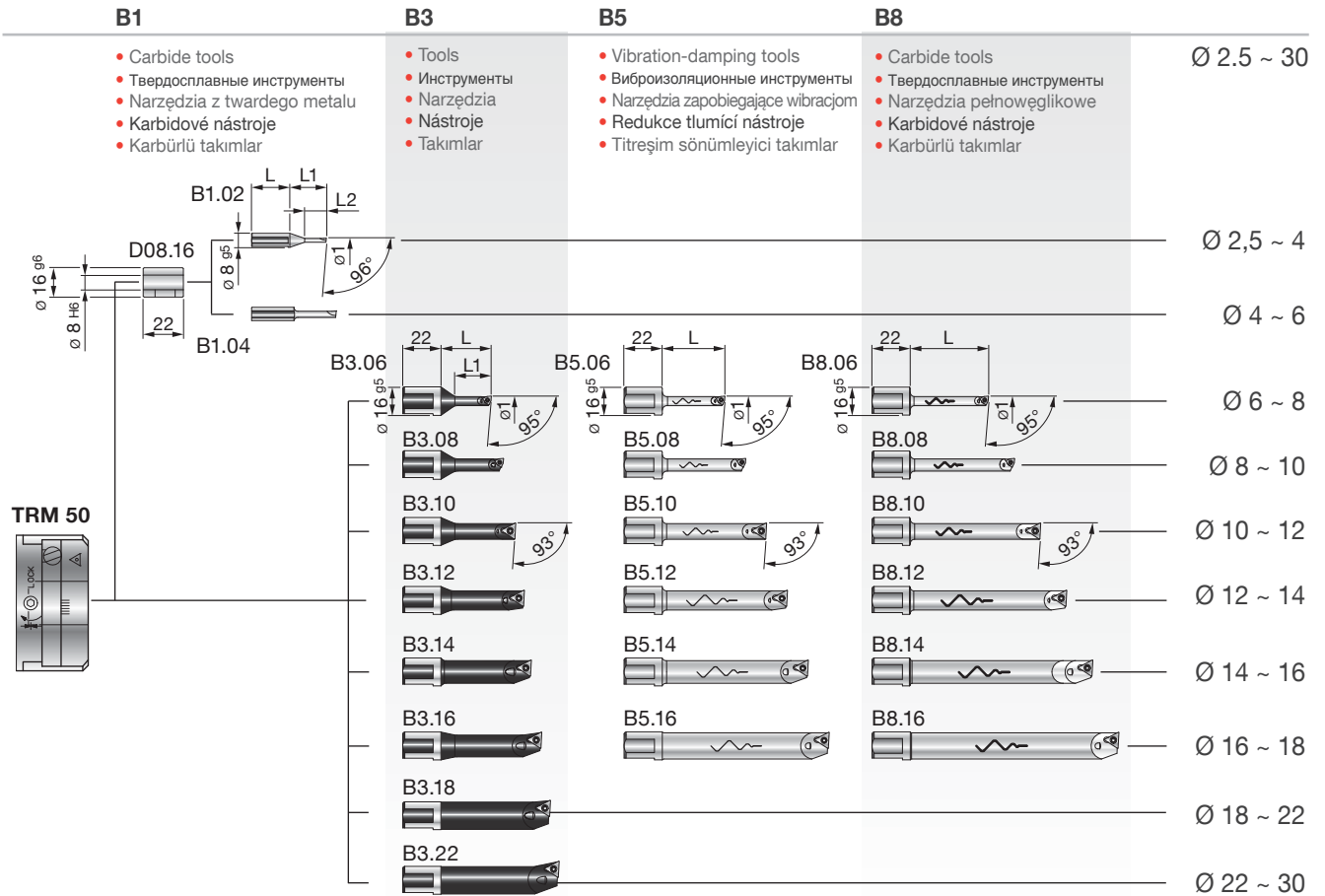

REF.	CODE	Kg.
D08.16	200560116082	0.02

REF.	CODE	Ø1	L	L1	L2	Kg.
B1.02	572010502001	2.5 ~ 4	22	21	12.5	0.02
B1.04	572010504001	4 ~ 6	24	24	-	

REF.	CODE	Ø1	L	L1	⊖	⊖	⊖	⊖	Kg.
B3.06	572010506001	6 ~ 8	29	21	WCGT 0201..	-	TS 21	TORX T06	0.035
B3.08	572010508001	8 ~ 10	36	28					0.04
B3.10	572010510001	10 ~ 12	43	35	-	TPGX 0902..	CS 250 T	TORX T08	0.05
B3.11	572010511001	11 ~ 13	48	40					0.055
B3.12	572010512001	12 ~ 14	52	42					0.06
B3.14	572010514001	14 ~ 16	58	50					0.07
B3.16	572010516001	16 ~ 18	63	-					0.1
B3.18	572010518001	18 ~ 22	68	-					
B3.22	572010522001	22 ~ 30	68	-					

B5.06	572010506105	6 ~ 8	36	-	WCGT 0201..	-	TS 21	TORX T06	0.075
B5.08	572010508105	8 ~ 10	48						0.09
B5.10	572010510105	10 ~ 12	60	-	TPGX 0902..	CS 250 T	TORX T08	0.1	
B5.12	572010512105	12 ~ 14	72					0.2	
B5.14	572010514105	14 ~ 16	84					0.3	
B5.16	572010516105	16 ~ 18	96						

B8.06	572010506108	6 ~ 8	45	-	WCGT 0201..	-	TS 21	TORX T06	0.065
B8.08	572010508108	8 ~ 10	60						0.08
B8.10	572010510108	10 ~ 12	75	-	TPGX 0902..	CS 250 T	TORX T08	0.1	
B8.12	572010512108	12 ~ 14	90					0.2	
B8.14	572010514108	14 ~ 16	105					0.3	
B8.16	572010516108	16 ~ 18	120						

- TOOLHOLDERS FOR TESTAROSSA
- ДЕРЖАТЕЛИ ДЛЯ ГОЛОВКИ TESTAROSSA
- OPRAWKI NARZĘDZIOWE DO GŁOWIC TESTAROSSA
- NÁSTROJOVÉ DRŽÁKY PRO TESTAROSSA
- TESTAROSSA İÇİN TAKIM TUTUCULAR

PS 31
CW 32
 \varnothing 54 ~ 108

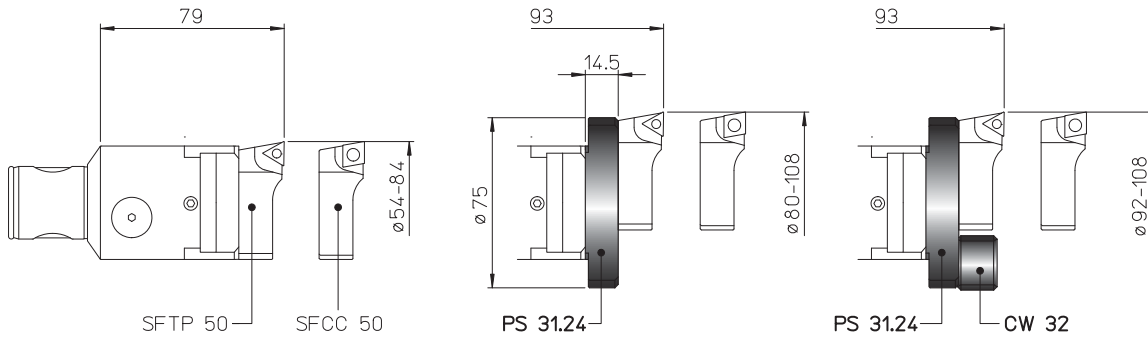

PS 31
 \varnothing 56 ~ 111

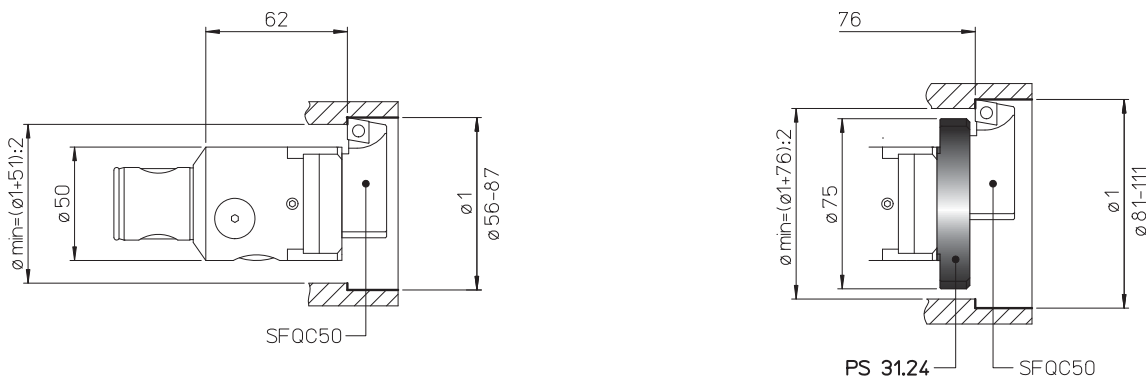

PS 31
 \varnothing 52 ~ 109

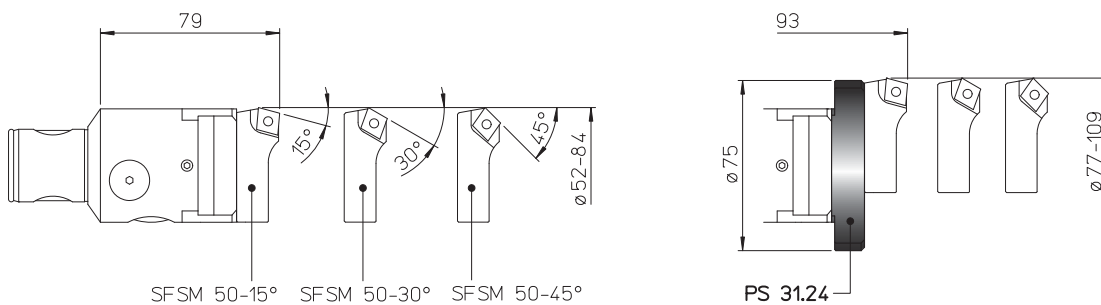

REF.	CODE	Kg.
PS 31.24 TR..50	433024140751	0.19
CW 32	392011003201	0.07



- TOOLHOLDERS FOR TESTAROSSA
- ДЕРЖАТЕЛИ ДЛЯ ГОЛОВКИ TESTAROSSA
- OPRAWKI NARZĘDZIOWE DO GŁOWIC TESTAROSSA
- NÁSTROJOVÉ DRŽÁKY PRO TESTAROSSA
- TESTAROSSA İÇİN TAKIM TUTUCULAR

P 25
Ø 28 ~ 54

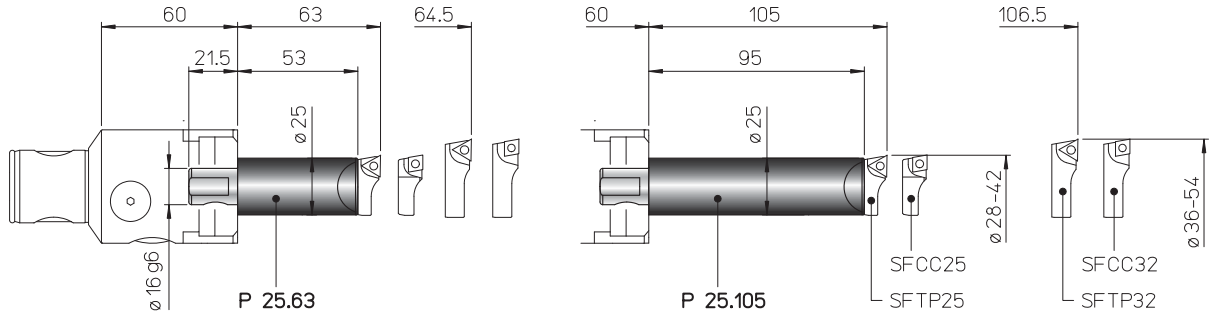

REF.	CODE	Kg.
P25.63 TR...	435116250631	0.5
P25.105 TR...	435116251051	0.8

- BIT-HOLDERS FOR TESTAROSSA
- КАССЕТЫ ДЛЯ ГОЛОВКИ TESTAROSSA
- OSTRZA DO GŁOWIC TESTAROSSA
- HROTOVÉ DRŽÁKY TESTAROSSA
- TESTAROSSA İÇİN MATKAP KOVANLARI

SF

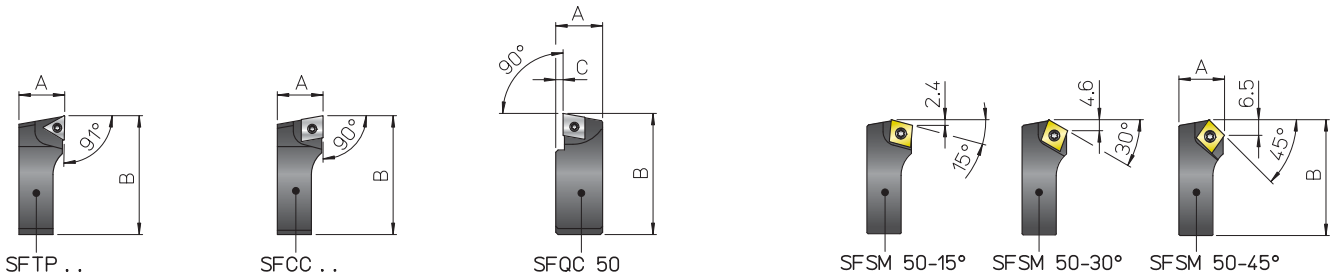

REF.	CODE	A	B	C	⚠	⊞	⊞	⊞	Kg.
SFTP 25	470500525001	10	26.5	-	TPGX 0902..	-	CS 250T	TORX T08	0.01
SFTP 32	470500532001	11.5	34.5	-	TPGX 1103..	-	CS 300890T		0.02
SFTP 50	470500550001	19	52	-	-	-	-		0.08
SFCC 25	470500525002	10	26.5	-	-	CCGT 0602..	TS 25	TORX T08	0.01
SFCC 32	470500532002	11.5	34.5	-	-	CCGT 09T3..	TS 4	TORX T15	0.02
SFCC 50	470500550002	19	52	-	-	CCMT 09T3..	TS 4	TORX T15	0.08
SFQC 50	470500550062	20.5	53	3	-	CCMT 09T3..	TS 4	TORXT15	0.1
SFSM 50-15°	470500550011	19	50.5	-	-	CCMT 09T3..	TS 4	TORXT15	0.07
SFSM 50-30°	470500550013								
SFSM 50-45°	470500550015								





2 µm

TRM 50/63

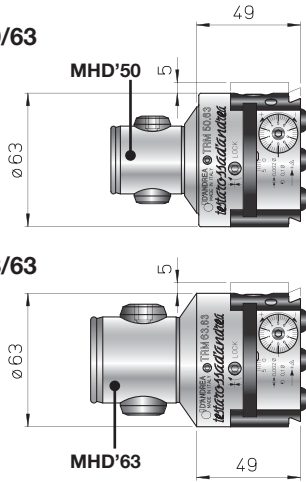

TRM 63/63

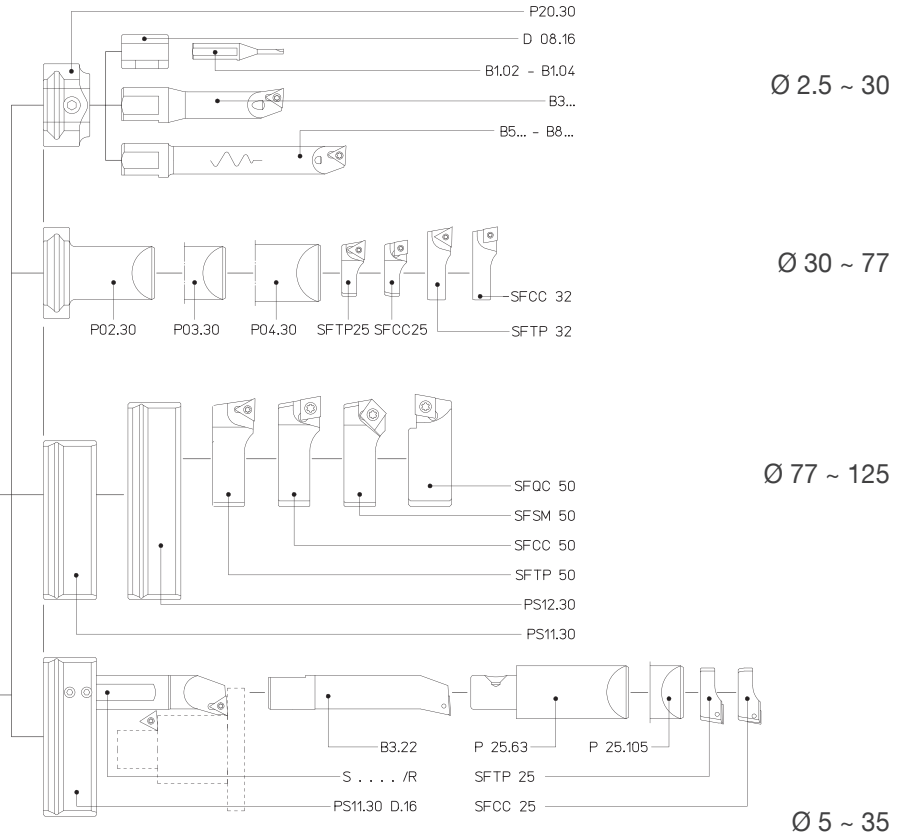
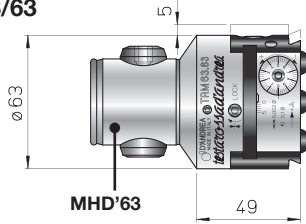

REF.	CODE	Kg.
TRM 50/63	455005000631	1.1
TRM 63/63	455006300631	1.5

KIT K01
Ø 6 ~ 125

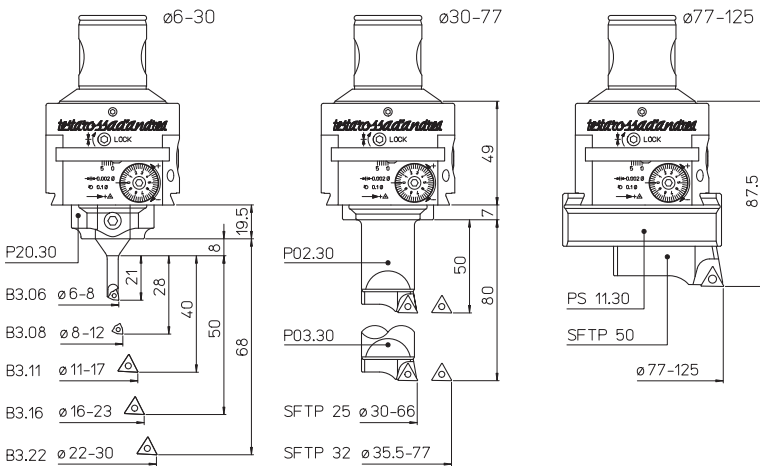

- 1 TRM../63
- 1 P20.30 1 B3.06 1 B3.22 5 TPGX 090202L DC100
- 1 PS11.30 1 B3.08 1 SFTP25 1 TPGX 110302L DC100
- 1 P02.30 1 B3.11 1 SFTP32 2 WCGT 020102L DC100
- 1 P03.30 1 B3.16 1 SFTP50

REF.	CODE	Ø
KIT K01 TRM 50/63	655005010632	6 ~ 125
KIT K01 TRM 63/63	655006310632	

119 120 116 241



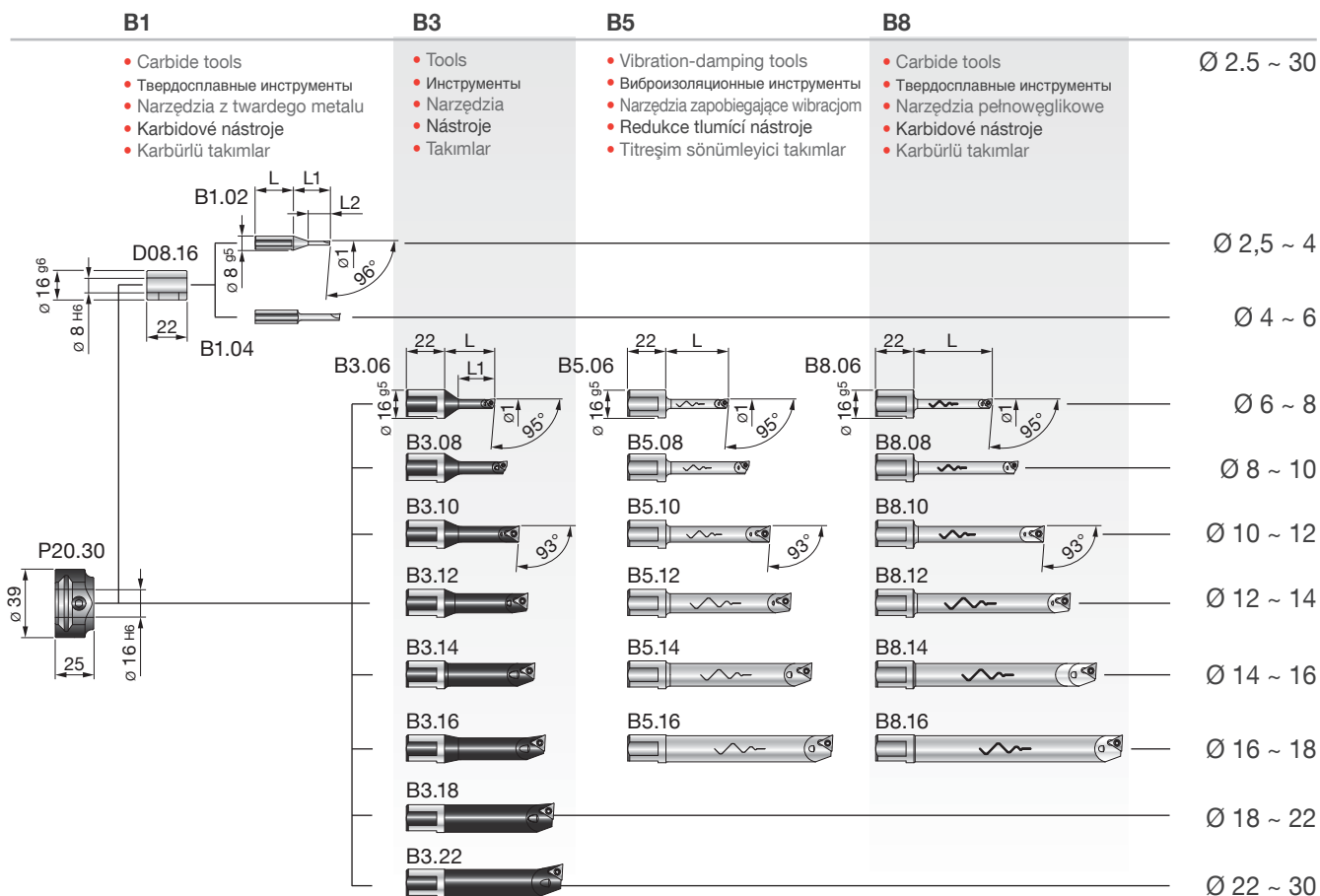

REF.	CODE	Kg.
P20.30	431030160300	0.2

REF.	CODE	Kg.
D08.16	200560116082	0.02

REF.	CODE	Ø1	L	L1	L2	Kg.
B1.02	572010502001	2.5 ~ 4	22	21	12.5	0.02
B1.04	572010504001	4 ~ 6	24	24	-	

REF.	CODE	Ø1	L	L1	△	△	🔩	🔩	Kg.		
B3.06	572010506001	6 ~ 8	29	21	WCGT 0201..	-	TS 21	TORX T06	0.035		
B3.08	572010508001	8 ~ 10	36	28					TS 211	0.04	
B3.10	572010510001	10 ~ 12	43	35			-	TPGX 0902..	CS 250 T	TORX T08	0.05
B3.11	572010511001	11 ~ 13	48	40							0.055
B3.12	572010512001	12 ~ 14	42	42	0.06						
B3.14	572010514001	14 ~ 16	52	50	-	TPGX 0902..	CS 250 T	TORX T08	0.07		
B3.16	572010516001	16 ~ 18	58						0.07		
B3.18	572010518001	18 ~ 22	63	-	-	TPGX 0902..	CS 250 T	TORX T08	0.1		
B3.22	572010522001	22 ~ 30	68						0.1		

B5.06	572010506105	6 ~ 8	36	-	WCGT 0201..	-	TS 21	TORX T06	0.075
B5.08	572010508105	8 ~ 10	48						TS 211
B5.10	572010510105	10 ~ 12	60	-	-	TPGX 0902..	CS 250 T	TORX T08	0.1
B5.12	572010512105	12 ~ 14	72						0.2
B5.14	572010514105	14 ~ 16	84						0.2
B5.16	572010516105	16 ~ 18	96						0.3

B8.06	572010506108	6 ~ 8	45	-	WCGT 0201..	-	TS 21	TORX T06	0.065
B8.08	572010508108	8 ~ 10	60						TS 211
B8.10	572010510108	10 ~ 12	75	-	-	TPGX 0902..	CS 250 T	TORX T08	0.1
B8.12	572010512108	12 ~ 14	90						0.2
B8.14	572010514108	14 ~ 16	105						0.2
B8.16	572010516108	16 ~ 18	120						0.3

TRM 50/63

TRM 63/63 Ø 77 ~ 127

- TOOLHOLDERS FOR TESTAROSSA
- ДЕРЖАТЕЛИ ДЛЯ ГОЛОВКИ TESTAROSSA
- OPRAWKI NARZĘDZIOWE DO GŁOWIC TESTAROSSA
- NÁSTROJOVÉ DRŽÁKY PRO TESTAROSSA
- TESTAROSSA İÇİN TAKIM TUTUCULA

PS

Ø 77 ~ 125

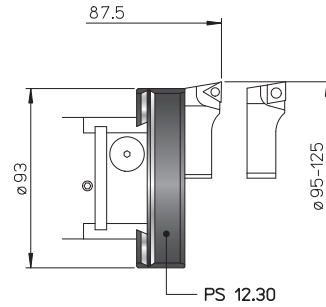
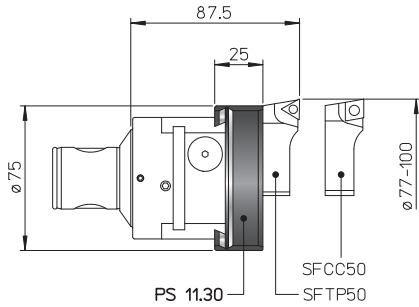

PS

Ø 82 ~ 127

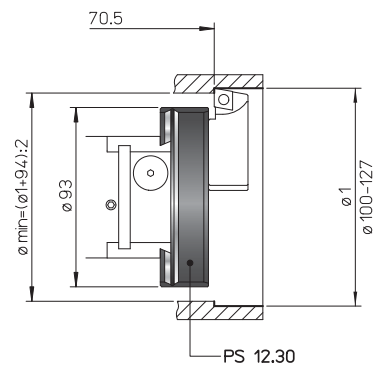
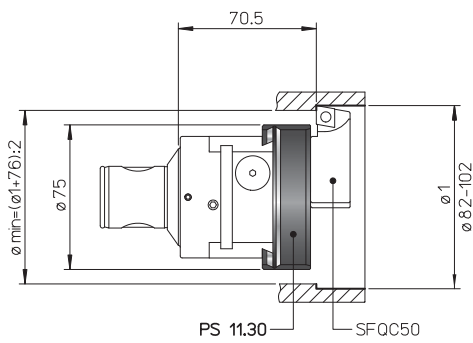

PS

Ø 77 ~ 125

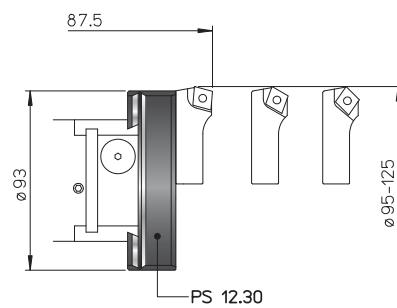
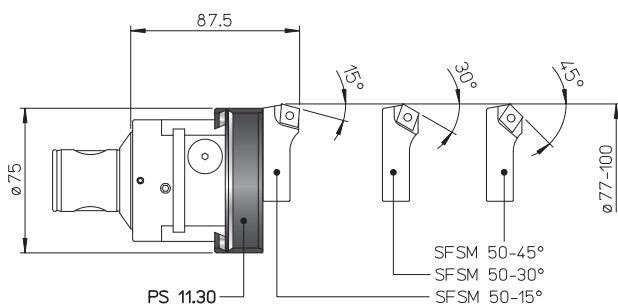

REF.	CODE	Kg.
PS 11.30	433030260750	0.4
PS 12.30	433030260950	0.5

119



125



116



- TOOLHOLDERS FOR TESTAROSSA
- ДЕРЖАТЕЛИ ДЛЯ ГОЛОВКИ TESTAROSSA
- OPRAWKI NARZĘDZIOWE DO GŁOWIC TESTAROSSA
- NÁSTROJOVÉ DRŽÁKY PRO TESTAROSSA
- TESTAROSSA İÇİN TAKIM TUTUCULAR

P
Ø 30 ~ 77

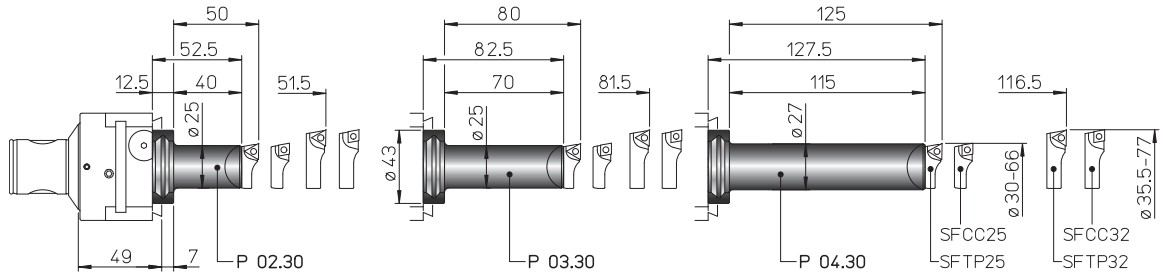

REF.	CODE	Kg.
P02.30	431030250400	0.3
P03.30	431030250700	0.4
P04.30	431030251150	0.7

- TESTAROSSA EXTERNAL TURNING
- TESTAROSSA ВНЕШНЕГО ОБТАЧИВАНИЯ
- TESTAROSSA TOCZENIE ZEWNĘTRZNE
- EXTERNÍ SOUSTRUŽENÍ TESTAROSSA
- TESTAROSSA DIŞ TORNALAMA

PS + P25
Ø 5 ~ 35

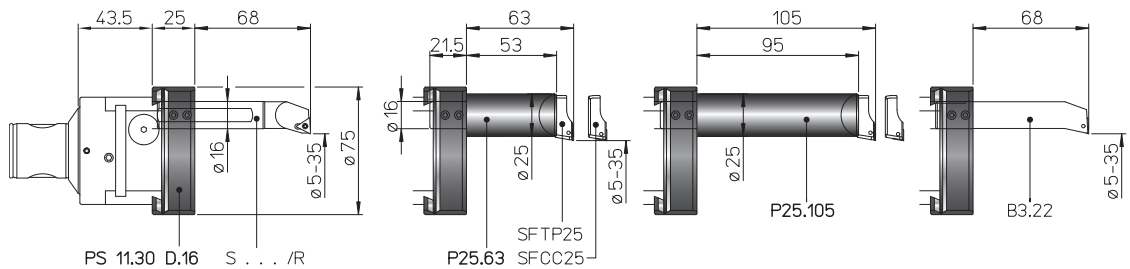

REF.	CODE	Kg.
PS 11.30 D.16	433030260755	0.4
P25.63 TR...	435116250631	0.5
P25.105 TR...	435116251051	0.8

- BIT-HOLDERS FOR TESTAROSSA
- КАССЕТЫ ДЛЯ ГОЛОВКИ TESTAROSSA
- OSTRZA DO GŁOWIC TESTAROSSA
- HROTOVÉ DRŽÁKY TESTAROSSA
- TESTAROSSA İÇİN MATKAP KOVANLARI

SF

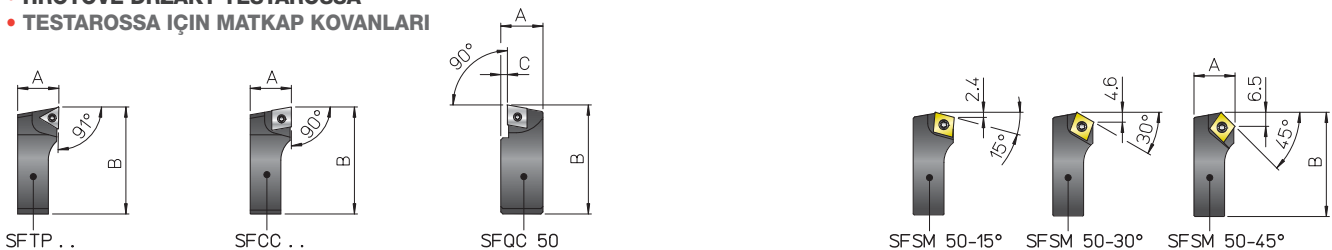

REF.	CODE	A	B	C	△	⊗	⊔	⊔	Kg.
SFTP 25	470500525001	10	26.5	-	TPGX 0902..	-	CS 250T	TORX T08	0.01
SFTP 32	470500532001	11.5	34.5	-	-	-	-	-	0.02
SFTP 50	470500550001	19	52	-	TPGX 1103..	-	CS 300890T	-	0.08
SFCC 25	470500525002	10	26.5	-	-	CCGT 0602..	TS 25	TORX T08	0.01
SFCC 32	470500532002	11.5	34.5	-	-	-	-	-	0.02
SFCC 50	470500550002	19	52	-	-	CCGT 09T3..	TS 4	TORX T15	0.08
SFQC 50	470500550062	20.5	53	3	-	CCMT 09T3..	TS 4	TORXT15	0.1
SFSM 50-15°	470500550011	19	50.5	-	-	CCMT 09T3..	TS 4	TORXT15	0.07
SFSM 50-30°	470500550013								
SFSM 50-45°	470500550015								



2 µm

TRM 50/80

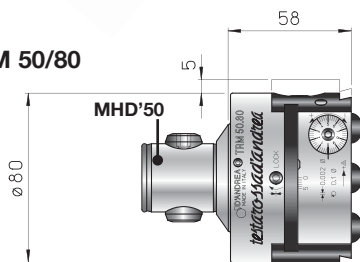

TRM 80/80

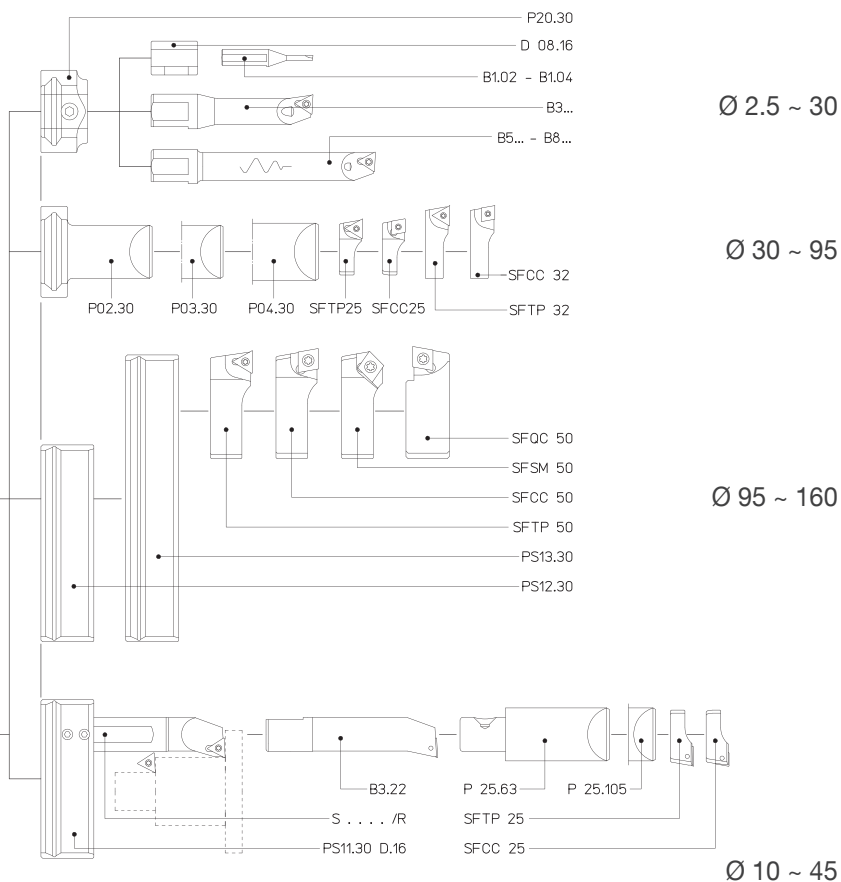
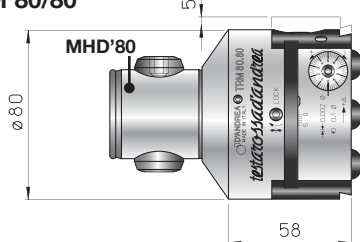

REF.	CODE	Kg.
TRM 50/80	455005000801	2
TRM 80/80	455008000801	2.5

KIT K01
 Ø 6 ~ 220

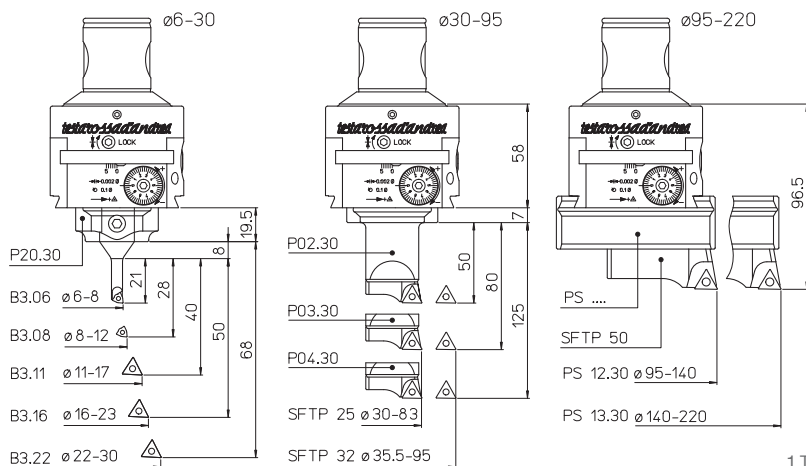

- 1 TRM.../ 80
- 1 P20.30 1 P03.30 1 SFTP50 1 B3.16 5 TPGX 090202L DC100
- 1 PS12.30 1 P04.30 1 B3.06 1 B3.22 1 TPGX 110302L DC100
- 1 PS13.30 1 SFTP25 1 B3.08 2 WCGT 020102L DC100
- 1 P02.30 1 SFTP32 1 B3.11

REF.	CODE	Ø
KIT K01 TRM 50/80	655005010802	6 ~ 220
KIT K01 TRM 80/80	655008010802	

119 INFO

120

116

241



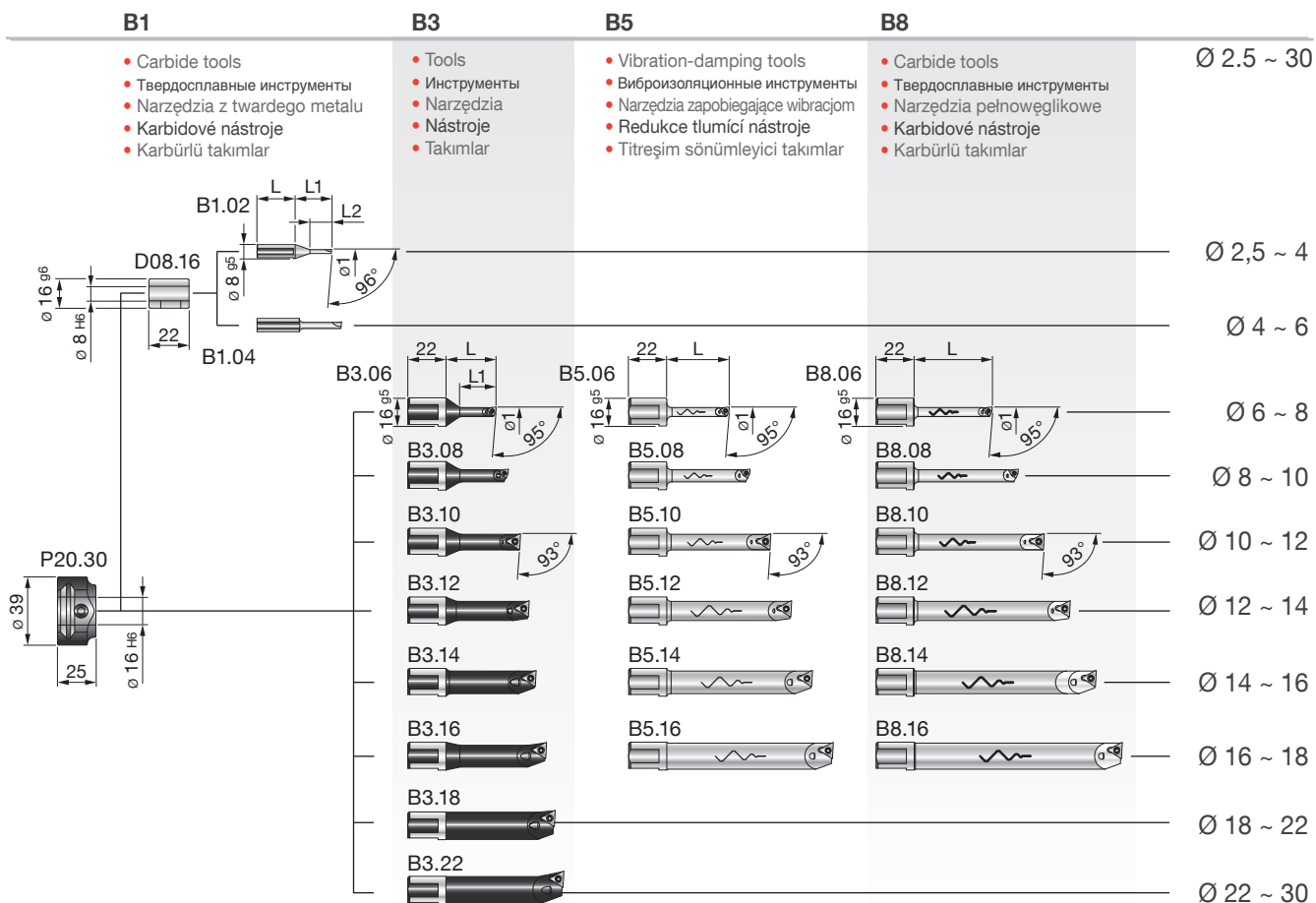

B1

- Carbide tools
- Твердосплавные инструменты
- Narzędzia z twardego metalu
- Karbidové nástroje
- Karbürli takımlar

B3

- Tools
- Инструменты
- Narzędzia
- Nástroje
- Takımlar

B5

- Vibration-damping tools
- Виброизоляционные инструменты
- Narzędzia zapobiegające wibracjom
- Redukce tlumiící nástroje
- Titreşim sönmüleyici takımlar

B8

- Carbide tools
- Твердосплавные инструменты
- Narzędzia pełnowęglkowe
- Karbidové nástroje
- Karbürli takımlar

Ø 2.5 ~ 30

Ø 2,5 ~ 4

Ø 4 ~ 6

Ø 6 ~ 8

Ø 8 ~ 10

Ø 10 ~ 12

Ø 12 ~ 14

Ø 14 ~ 16

Ø 16 ~ 18

Ø 18 ~ 22

Ø 22 ~ 30

REF.	CODE	Kg.
P20.30	431030160300	0.2

REF.	CODE	Kg.
D08.16	200560116082	0.02

REF.	CODE	Ø1	L	L1	L2	Kg.
B1.02	572010502001	2.5 ~ 4	22	21	12.5	0.02
B1.04	572010504001	4 ~ 6	24	24	-	

REF.	CODE	Ø1	L	L1	⚠	⚠	🔧	🔧	Kg.		
B3.06	572010506001	6 ~ 8	29	21	WCGT 0201..	-	TS 21	TORX T06	0.035		
B3.08	572010508001	8 ~ 10	36	28					TS 211	0.04	
B3.10	572010510001	10 ~ 12	43	35			-	TPGX 0902..	CS 250 T	TORX T08	0.05
B3.11	572010511001	11 ~ 13	48	40							0.055
B3.12	572010512001	12 ~ 14	42	42	0.06						
B3.14	572010514001	14 ~ 16	52	50	0.07						
B3.16	572010516001	16 ~ 18	58	-	0.1						
B3.18	572010518001	18 ~ 22	63	-	0.1						
B3.22	572010522001	22 ~ 30	68	-	-	-	-	-			

B5.06	572010506105	6 ~ 8	36	-	WCGT 0201..	-	TS 21	TORX T06	0.075
B5.08	572010508105	8 ~ 10	48						TS 211
B5.10	572010510105	10 ~ 12	60		-	TPGX 0902..	CS 250 T	TORX T08	0.1
B5.12	572010512105	12 ~ 14	72						0.2
B5.14	572010514105	14 ~ 16	84						0.2
B5.16	572010516105	16 ~ 18	96						0.3

B8.06	572010506108	6 ~ 8	45	-	WCGT 0201..	-	TS 21	TORX T06	0.065
B8.08	572010508108	8 ~ 10	60						TS 211
B8.10	572010510108	10 ~ 12	75	-	-	TPGX 0902..	CS 250 T	TORX T08	0.1
B8.12	572010512108	12 ~ 14	90						0.2
B8.14	572010514108	14 ~ 16	105						0.2
B8.16	572010516108	16 ~ 18	120						0.3

TRM 50/80

TRM 80/80 Ø 95 ~ 162

- TOOLHOLDERS FOR TESTAROSSA
- ДЕРЖАТЕЛИ ДЛЯ ГОЛОВКИ TESTAROSSA
- OPRAWKI NARZĘDZIOWE DO GŁOWIC TESTAROSSA
- NÁSTROJOVÉ DRŽÁKY PRO TESTAROSSA
- TESTAROSSA İÇİN TAKIM TUTUCULAR

PS

Ø 95 ~ 160

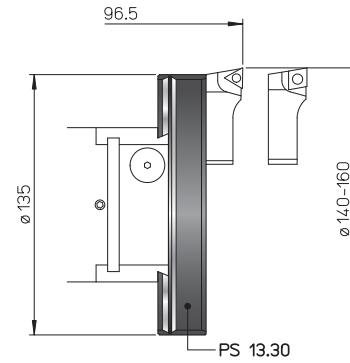
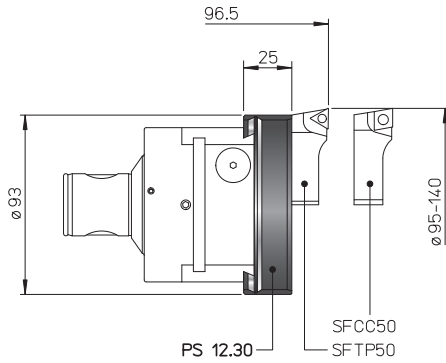

PS

Ø 100 ~ 162

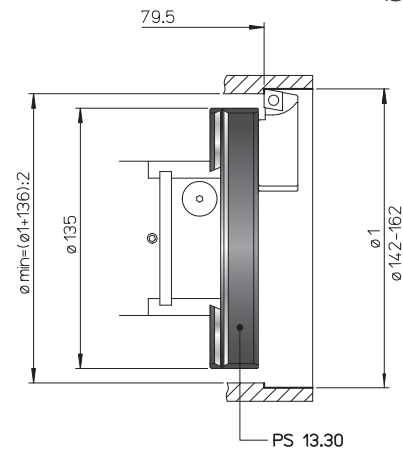
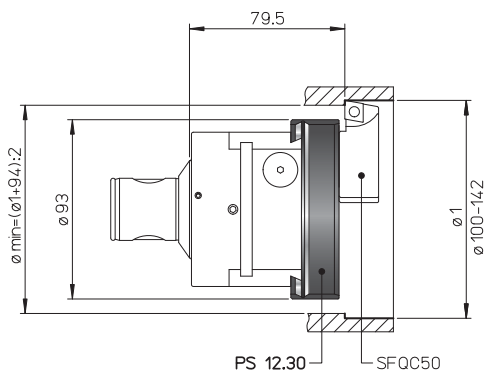

PS

Ø 95 ~ 160

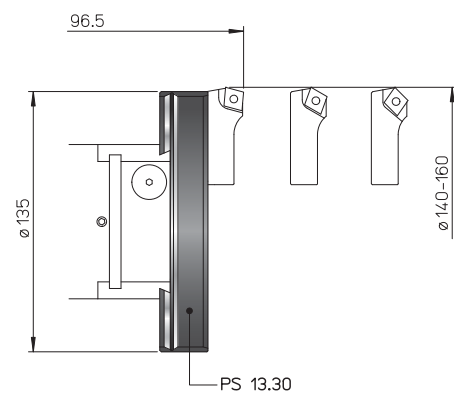
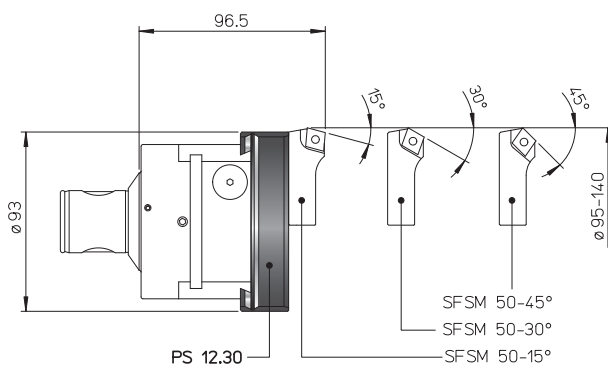

REF.	CODE	Kg.
PS 12.30	433030260950	0.5
PS 13.30	433030261400	0.7

119



125



116



- TOOLHOLDERS FOR TESTAROSSA
- ДЕРЖАТЕЛИ ДЛЯ ГОЛОВКИ TESTAROSSA
- OPRAWKI NARZĘDZIOWE DO GŁOWIC TESTAROSSA
- NÁSTROJOVÉ DRŽÁKY PRO TESTAROSSA
- TESTAROSSA İÇİN TAKIM TUTUCULAR

P
Ø 30 ~ 95

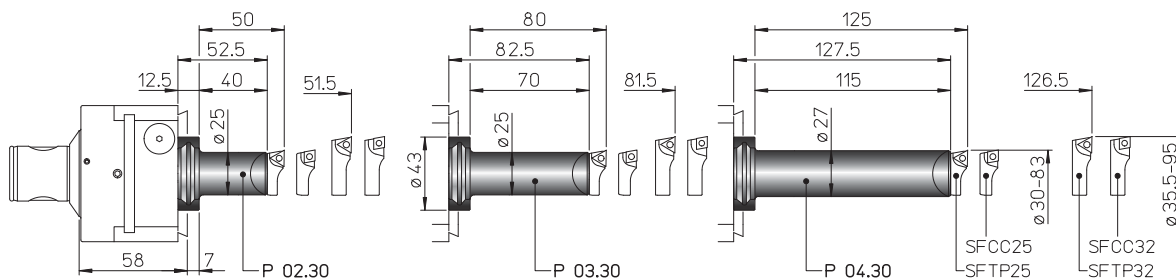

REF.	CODE	Kg.
P02.30	431030250400	0.3
P03.30	431030250700	0.4
P04.30	431030251150	0.7

- TESTAROSSA EXTERNAL TURNING
- TESTAROSSA ВНЕШНЕГО ОБТАЧИВАНИЯ
- TESTAROSSA TOCZENIE ZEWNĘTRZNE
- EXTERNÍ SOUSTRUŽENÍ TESTAROSSA
- TESTAROSSA DIŞ TORNALAMA

PS + P25
Ø 10 ~ 45

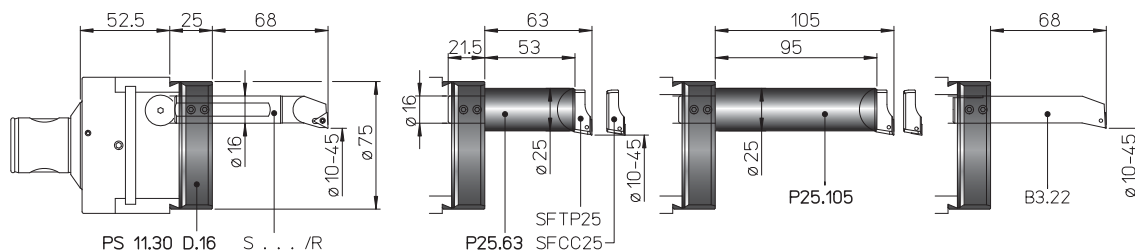

REF.	CODE	Kg.
PS 11.30 D.16	433030260755	0.4
P25.63 TR...	435116250631	0.5
P25.105 TR...	435116251051	0.8

- BIT-HOLDERS FOR TESTAROSSA
- КАССЕТЫ ДЛЯ ГОЛОВКИ TESTAROSSA
- OSTRZA DO GŁOWIC TESTAROSSA
- HROTOVÉ DRŽÁKY TESTAROSSA
- TESTAROSSA İÇİN MATKAP KOVANLARI

SF

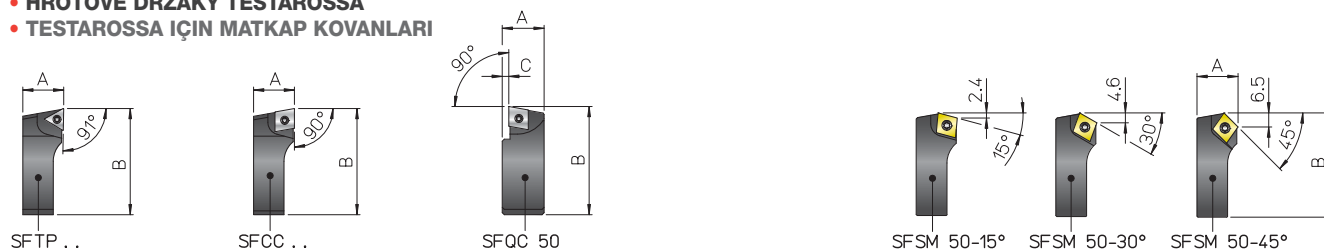

REF.	CODE	A	B	C	△	□	⊥	⌘	Kg.
SFTP 25	470500525001	10	26.5	-	TPGX 0902..	-	CS 250T	TORX T08	0.01
SFTP 32	470500532001	11.5	34.5	-	-	-	-	-	0.02
SFTP 50	470500550001	19	52	-	TPGX 1103..	-	CS 300890T	-	0.08
SFCC 25	470500525002	10	26.5	-	-	CCGT 0602..	TS 25	TORX T08	0.01
SFCC 32	470500532002	11.5	34.5	-	-	-	-	-	0.02
SFCC 50	470500550002	19	52	-	-	CCGT 09T3..	TS 4	TORX T15	0.08
SFQC 50	470500550062	20.5	53	3	-	CCMT 09T3..	TS 4	TORXT15	0.1
SFSM 50-15°	470500550011	19	50.5	-	-	CCMT 09T3..	TS 4	TORXT15	0.07
SFSM 50-30°	470500550013								
SFSM 50-45°	470500550015								

D'ANDREA

MODULHARD'ANDREA

2 µm



Ø 36 ~ 138

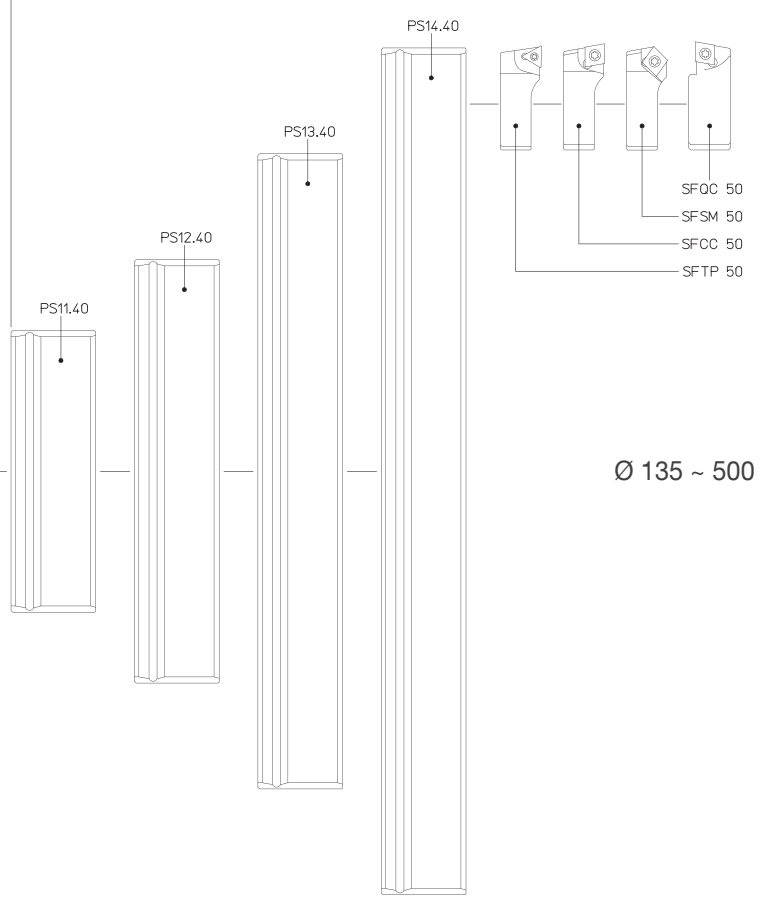
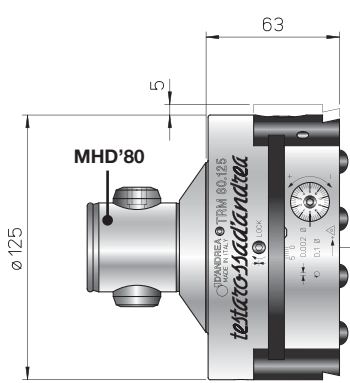
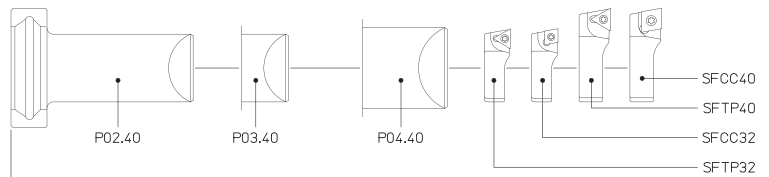

Ø 135 ~ 500

REF.	CODE	Kg.
TRM 80/125	455008001251	5.5

119



120



116



KIT K03
Ø 36 ~ 410

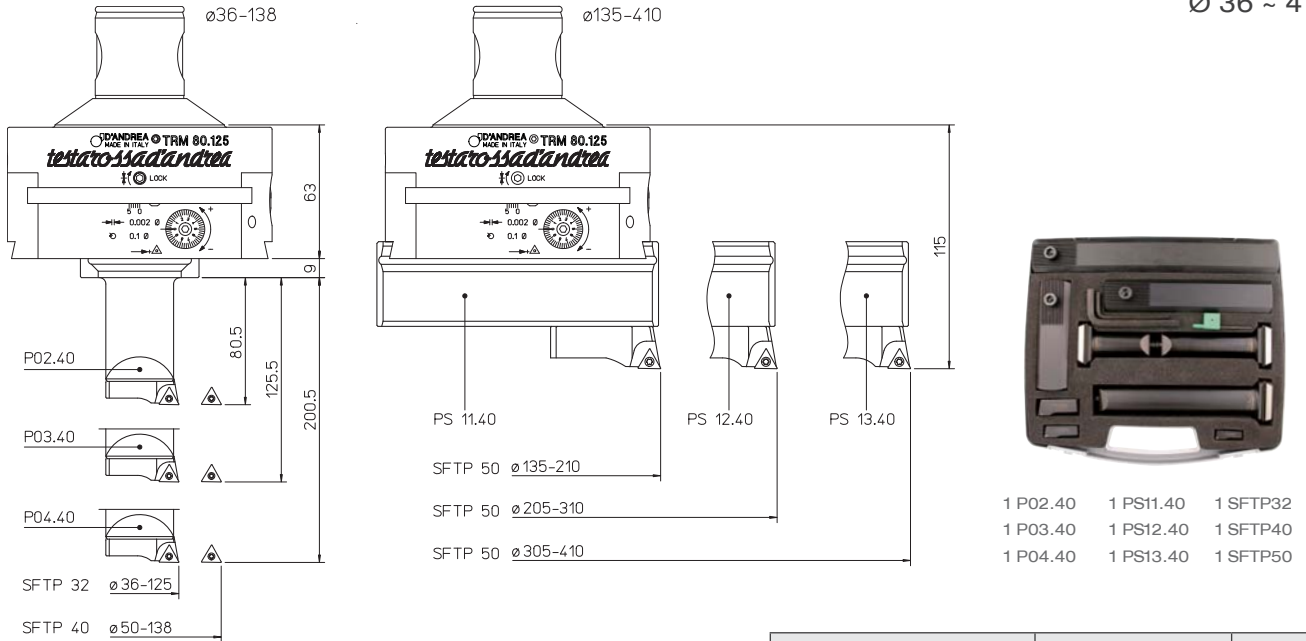

REF.	CODE	Ø
KIT K03 TRM 80/125	655012500030	36 ~ 410

P
Ø 36 ~ 138

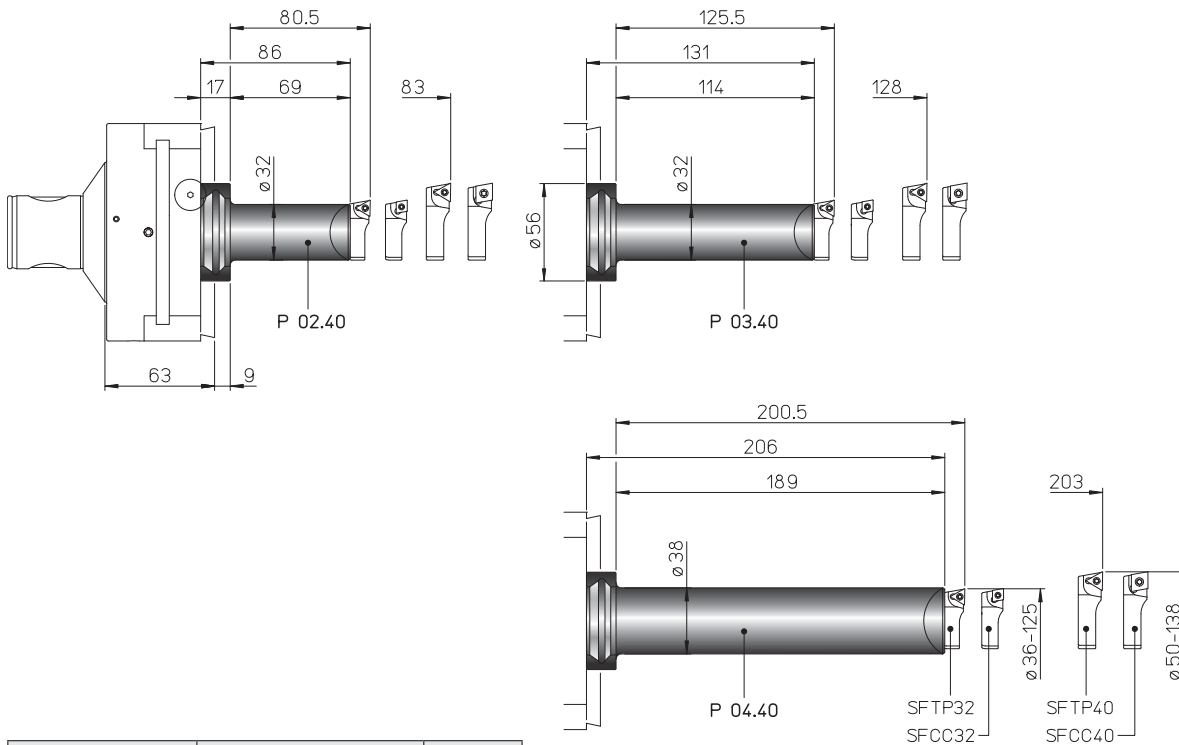

REF.	CODE	Kg.
P02.40	431040320700	0.7
P03.40	431040321150	1
P04.40	431040321900	2

- TOOLHOLDERS FOR TESTAROSSA
- ДЕРЖАТЕЛИ ДЛЯ ГОЛОВКИ TESTAROSSA
- OPRAWKI NARZĘDZIOWE DO GŁOWIC TESTAROSSA
- NÁSTROJOVÉ DRŽÁKY PRO TESTAROSSA
- TESTAROSSA İÇİN TAKIM TUTUCULAR

PS

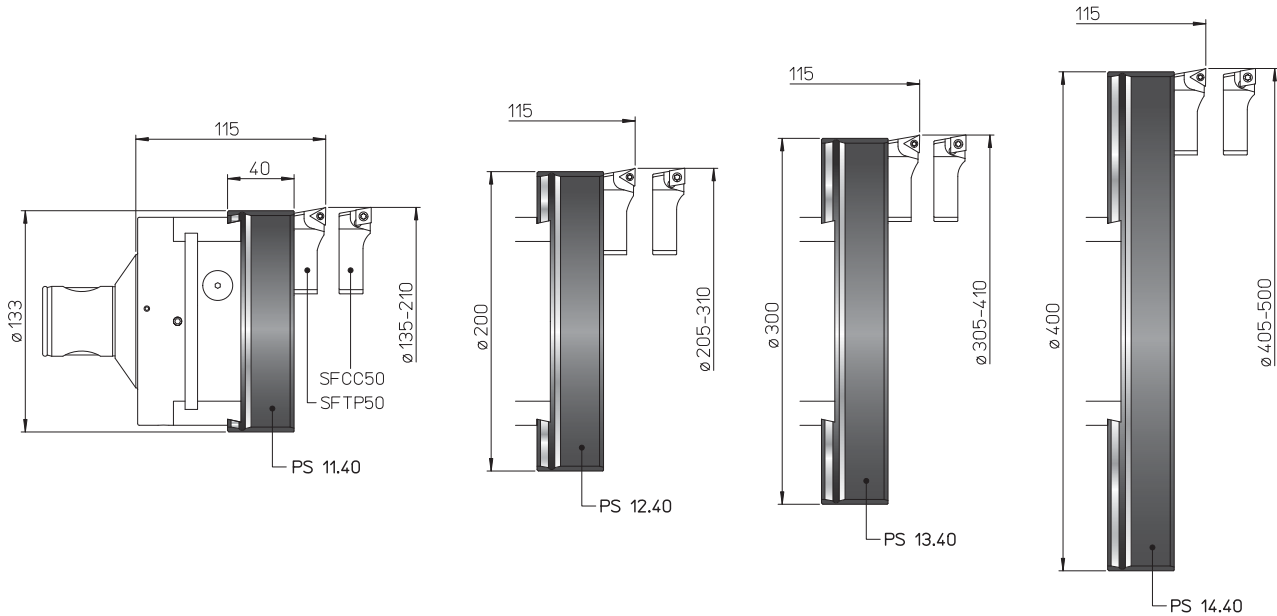
 \varnothing 135 ~ 500

PS

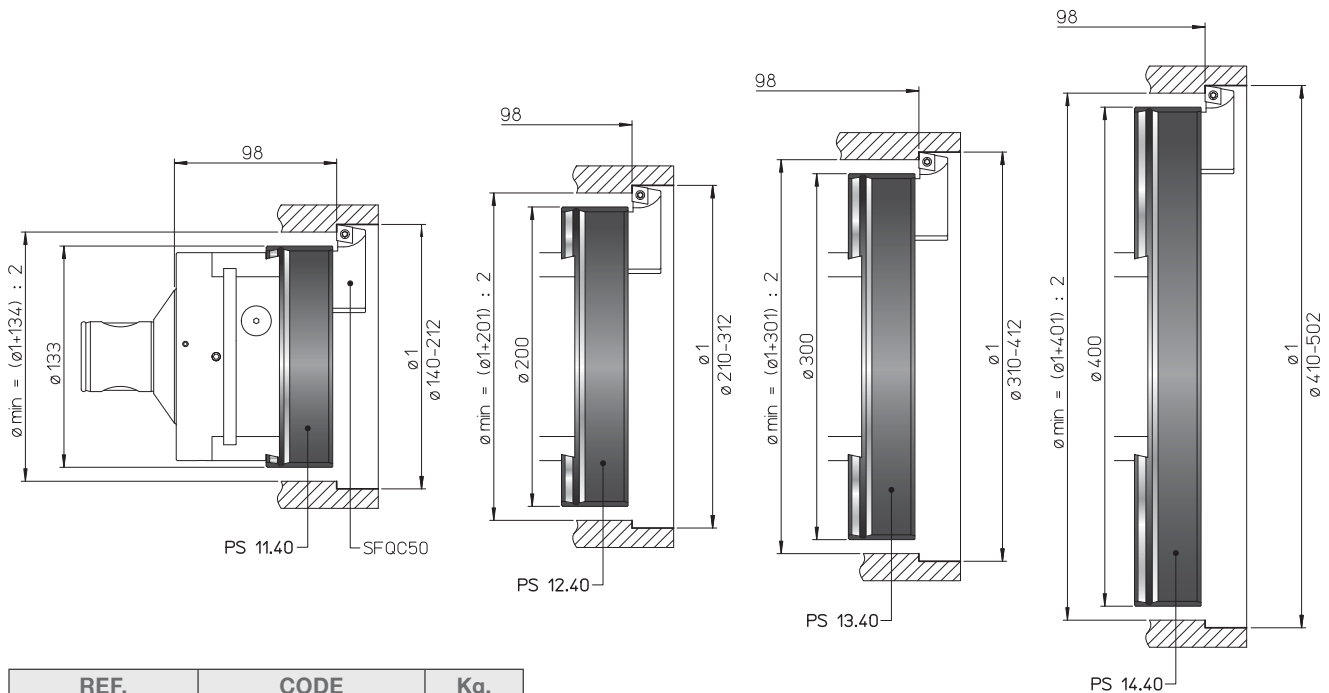
 \varnothing 140 ~ 502

REF.	CODE	Kg.
PS 11.40	433040351500	1.5
PS 12.40	433040352300	2.4
PS 13.40	433040353300	3.5
PS 14.40	433040354000	4.6

119



125



116



- TOOLHOLDERS FOR TESTAROSSA
- ДЕРЖАТЕЛИ ДЛЯ ГОЛОВКИ TESTAROSSA
- OPRAWKI NARZĘDZIOWE DO GŁOWIC TESTAROSSA
- NÁSTROJOVÉ DRŽÁKY PRO TESTAROSSA
- TESTAROSSA İÇİN TAKIM TUTUCULAR

PS
Ø 135 ~ 500

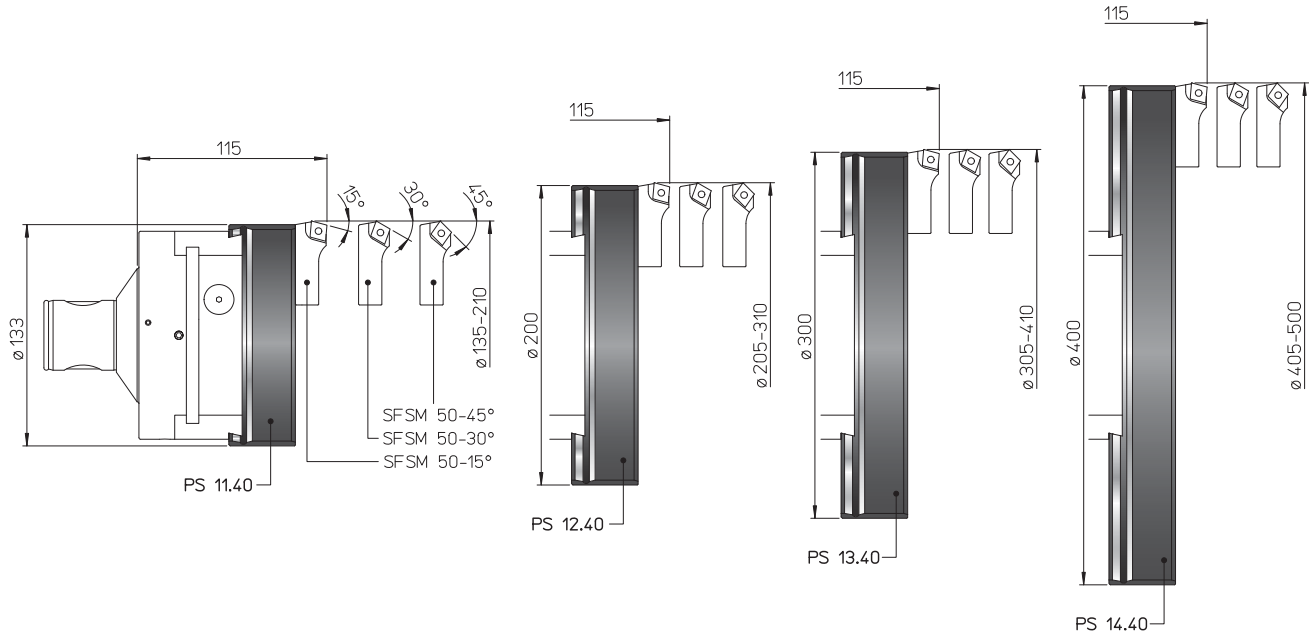

- BIT-HOLDERS FOR TESTAROSSA
- КАССЕТЫ ДЛЯ ГОЛОВКИ TESTAROSSA
- OSTRZA DO GŁOWIC TESTAROSSA
- HROTOVÉ DRŽÁKY TESTAROSSA
- TESTAROSSA İÇİN MATKAP KOVANLARI

SF

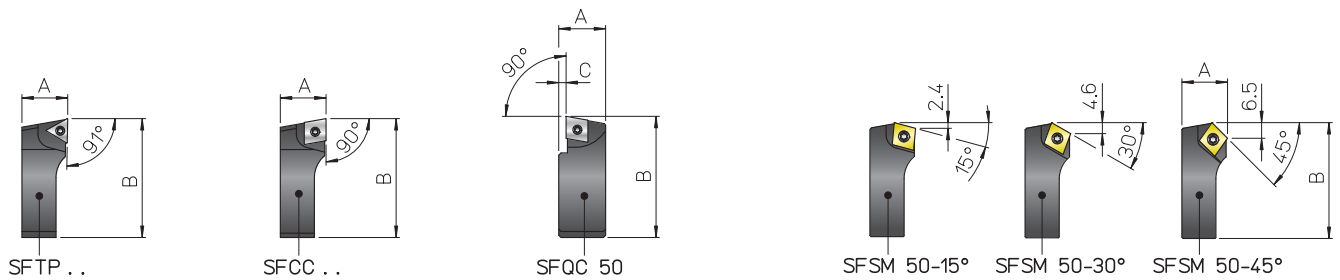

REF.	CODE	A	B	C	△	□	⌋	⌋	Kg.
SFTP 32	470500532001	11.5	34.5	-	TPGX 0902..	-	CS 250T	TORX T08	0.02
SFTP 40	470500540001	14	44	-	TPGX 1103..	-	CS 300890T		0.04
SFTP 50	470500550001	19	52	-	-	-	-		0.08
SFCC 32	470500532002	11.5	34.5	-	-	CCGT 0602..	TS 25	TORX T08	0.02
SFCC 40	470500540002	14	44	-	-	CCGT 09T3..	TS 4	TORX T15	0.04
SFCC 50	470500550002	19	52	-	-	-	-	-	0.08
SFQC 50	470500550062	20.5	53	3	-	CCMT 09T3..	TS 4	TORXT15	0.1
SFSM 50-15°	470500550011	19	50.5	-	-	CCMT 09T3..	TS 4	TORXT15	0.07
SFSM 50-30°	470500550013								
SFSM 50-45°	470500550015								

D'ANDREA

MODULHARD'ANDREA

ALUMINIUM TOOLS LINE

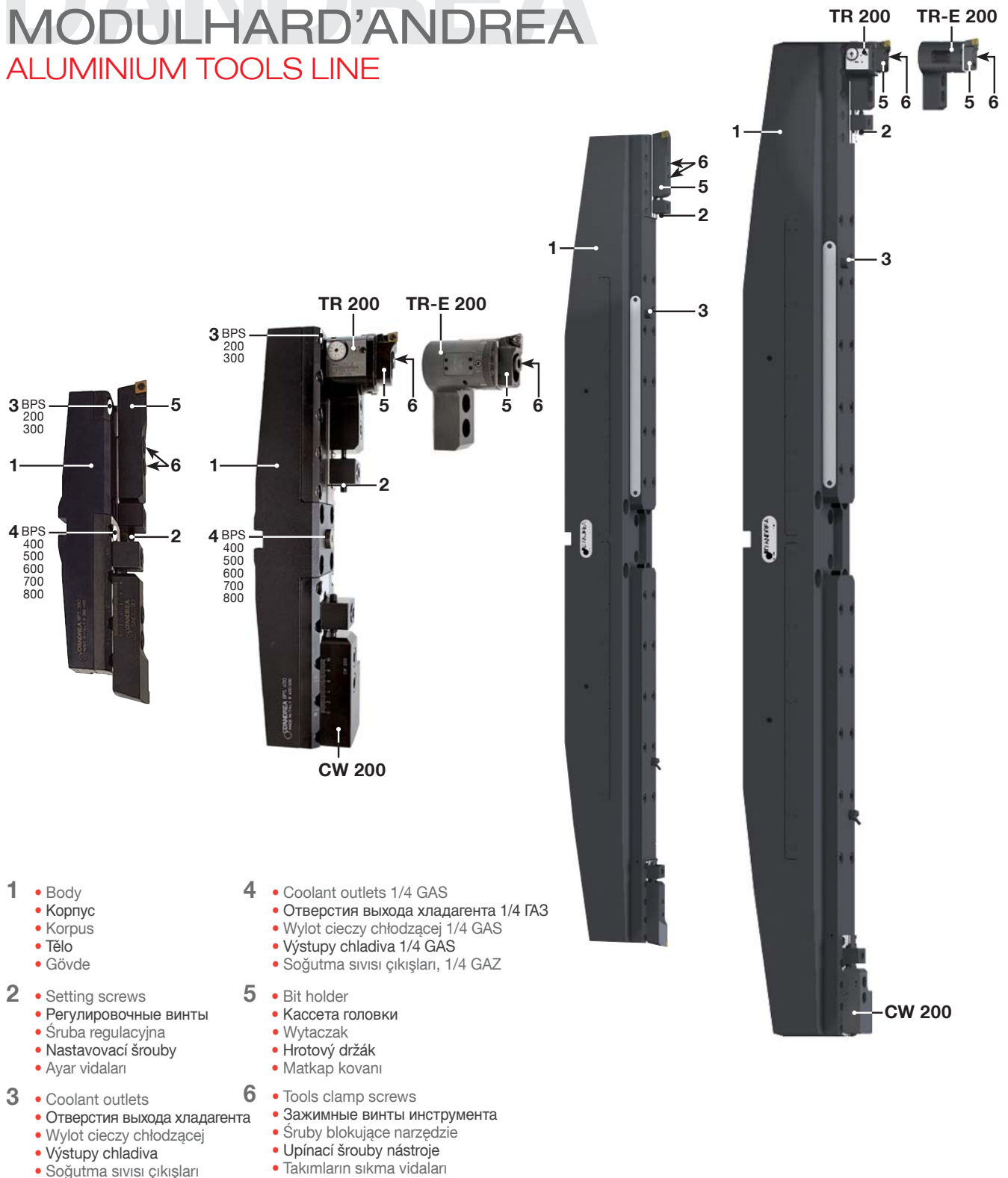

- | | |
|---|--|
| <p>1</p> <ul style="list-style-type: none"> • Body • Корпус • Korpus • Tělo • Gövde | <p>4</p> <ul style="list-style-type: none"> • Coolant outlets 1/4 GAS • Отверстия выхода хладагента 1/4 ГАЗ • Wylot cieczy chłodzącej 1/4 GAS • Výstupy chladiva 1/4 GAS • Soğutma sıvısı çıkışları, 1/4 GAZ |
| <p>2</p> <ul style="list-style-type: none"> • Setting screws • Регулировочные винты • Śruba regulacyjna • Nastavovací šrouby • Ayar vidaları | <p>5</p> <ul style="list-style-type: none"> • Bit holder • Кассета головки • Wytaczak • Hrotový držák • Matkap kovani |
| <p>3</p> <ul style="list-style-type: none"> • Coolant outlets • Отверстия выхода хладагента • Wylot cieczy chłodzącej • Výstupy chladiva • Soğutma sıvısı çıkışları | <p>6</p> <ul style="list-style-type: none"> • Tools clamp screws • Зажимные винты инструмента • Śruby blokujące narzędzie • Upínací šrouby nástroje • Takımların sıkma vidaları |

GB The BPS double-bit crossbars cover a working area from \varnothing 200 - 2700 mm. The BPS double-bit crossbars are constructed in Aluminium and mounted on a steel double-bit plate.

RU Двухрезцовые штанги BPS охватывают диапазон от 200 до 2700 мм. Корпус штанги BPS изготовлен из специального алюминиевого сплава и усилен стальной пластиной, на которой крепится кассета.

PL Wytaczadła typu BPS pozwalają obsłużyć zakres średnic od 200 do 2700 mm. Wytaczadła wykonywane są z aluminium, na którym mocowana jest stalowa płytka.

CZ Příčky dvouhrotového BPS pokrývají pracovní oblast od \varnothing 200 - 2700 mm. Příčky dvouhrotového BPS jsou konstruovány v hliníku a namontovány na ocelovou dvouhrotovou desku.

TR BPS çift uçlu çapraz kollar \varnothing 200 - 2700 mm arasında bir çalışma alanını kapsar. BPS çift uçlu çapraz kollar alüminyumdan mamuldür ve çelik çift uçlu plakanın üzerine monte edilir.



- DOUBLE-BIT CROSSBARS FOR BIG DIAMETERS
- ДВУХРЕЗЦОВЫЕ РАСТОЧНЫЕ ШТАНГИ ДЛЯ БОЛЬШИХ ДИАМЕТРОВ
- WYTACZADŁA WIELKOŚREDNICOWE
- DVOUHROTOVÉ PŘÍČKY PRO VELKÉ PRŮMĚRY
- BÜYÜK ÇAPLAR İÇİN ÇİFT UÇLU ÇAPRAZ KOLLAR

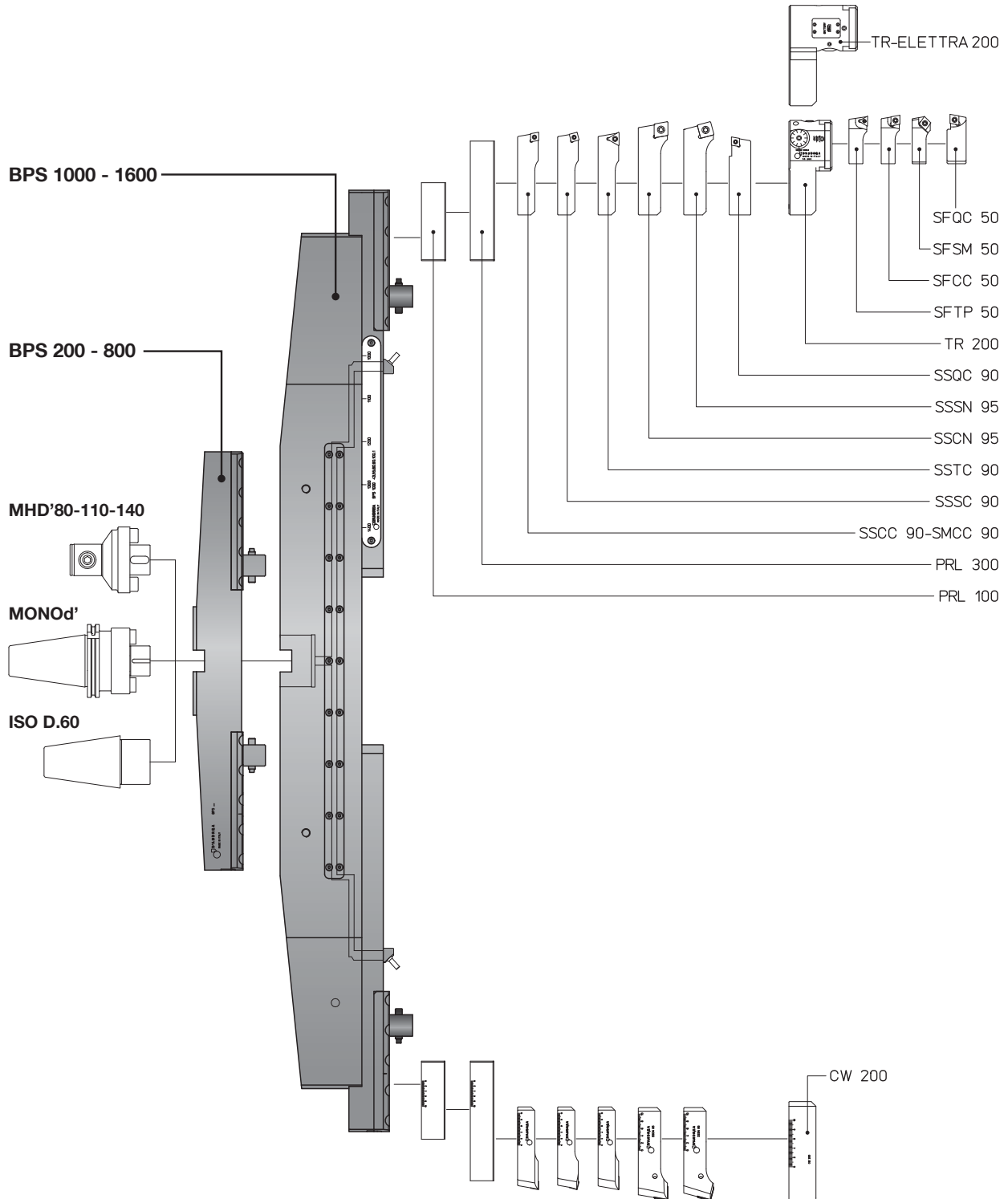

REF.	CODE	Kg.
BPS 200	435540881980	3.2
BPS 300	435540882980	3.9
BPS 400	435540883980	6.9
BPS 500	435560884940	9.4
BPS 600	435560885940	9.9

REF.	CODE	Kg.
BPS 700	435560886940	11.2
BPS 800	435560887940	15.2
BPS 1000 GD	435560901001	55
BPS 1150 GD	435560901151	70
BPS 1600 GD	435560901601	115

D'ANDREA

MODULHARD'ANDREA

ALUMINIUM TOOLS LINE

BPS 200~800 Ø 200 ~ 1200

- DOUBLE-BIT BORING CROSSBARS
- ДВУХРЕЗЦОВЫЕ ШТАНГИ
- WYTACZADŁA DWUONOŻOWE
- DVOUHROTOVÉ PŘÍČKY PRO VYVRTÁVÁNÍ
- DELİK AÇMA İÇİN ÇİFT UÇLU ÇAPRAZ KOLLAR

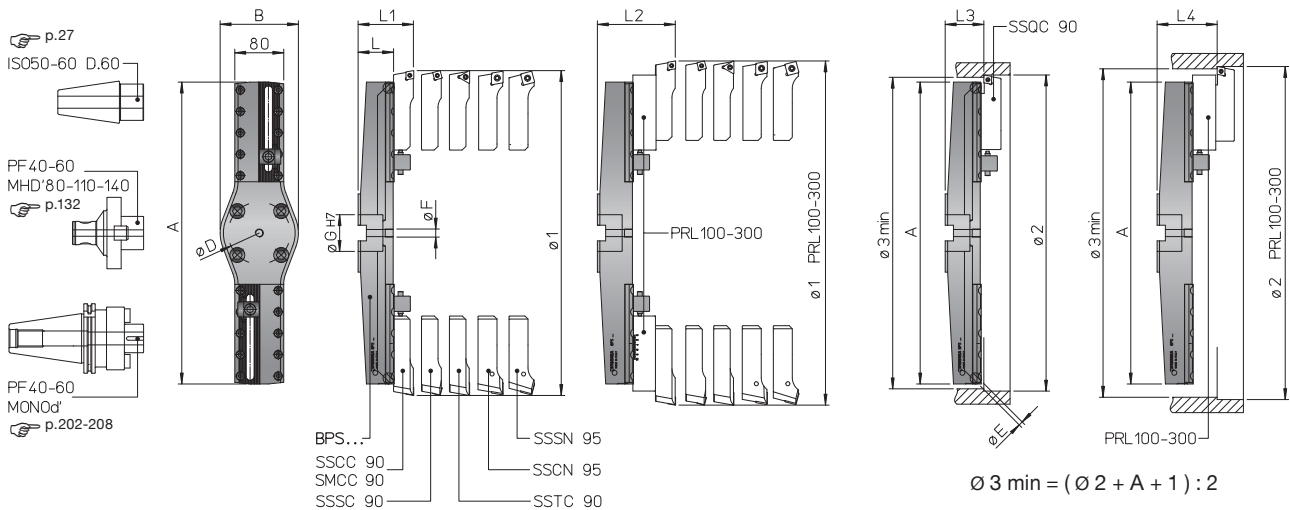

	BPS 200	BPS 300	BPS 400	BPS 500	BPS 600	BPS 700	BPS 800
A	194	288	394	494	594	694	794
B	-			128			
Ø D	(4xM12) 66.7			(4xM16) 101.6			
Ø E	2.5		-				
Ø F	-		1/4 GAS				
Ø G	40			60			
Ø 1	200 ~ 300	300 ~ 400	400 ~ 500	500 ~ 600	600 ~ 700	700 ~ 800	800 ~ 900
Ø 1 PRL 100	300 ~ 400	400 ~ 500	500 ~ 600	600 ~ 700	700 ~ 800	800 ~ 900	900 ~ 1000
Ø 1 PRL 300	400 ~ 600	500 ~ 700	600 ~ 800	700 ~ 900	800 ~ 1000	900 ~ 1100	1000 ~ 1200
Ø 2	202 ~ 302	302 ~ 402	402 ~ 502	502 ~ 602	602 ~ 702	702 ~ 802	802 ~ 902
Ø 2 PRL 100	302 ~ 402	402 ~ 502	502 ~ 602	602 ~ 702	702 ~ 802	802 ~ 902	902 ~ 1002
Ø 2 PRL 300	402 ~ 602	502 ~ 702	602 ~ 802	702 ~ 902	802 ~ 1002	902 ~ 1102	1002 ~ 1202
L	54		61	69	71	74	80
L1 S...90	86		93	101	103	106	112
L1 S...95	94		101	109	111	114	120
L2 PRL 100 S...90	116		123	131	133	136	142
L2 PRL 300 S...90	126		133	141	143	146	152
L2 PRL 100 S...95	124		131	139	141	144	150
L2 PRL 300 S...95	134		141	149	151	154	160
L3 SSQC 90	56.5		63.5	71.5	73.5	76.5	82.5
L4 PRL 100 SSQC 90	86.5		93.5	101.5	103.5	106.5	112.5
L4 PRL 300 SSQC 90	96.5		103.5	111.5	113.5	116.5	122.5

119



126



116



- DOUBLE-BIT CROSSBARS FOR BIG DIAMETER FINISH
- ДВУХРЕЗЦОВЫЕ РАСТОЧНЫЕ ШТАНГИ ДЛЯ ЧИСТОВОЙ ОБРАБОТКИ БОЛЬШИХ ДИАМЕТРОВ
- WYTACZADŁA WYKOŃCZENIOWE WIELKOŚREDNICOWE
- DVOUHROTOVÉ PŘÍČKY PRO DOKONČENÍ VELKÝCH PRŮMĚRŮ
- BÜYÜK ÇAPLI BITİRME İŞLERİ İÇİN ÇİFT UÇLU ÇAPRAZ KOLLAR

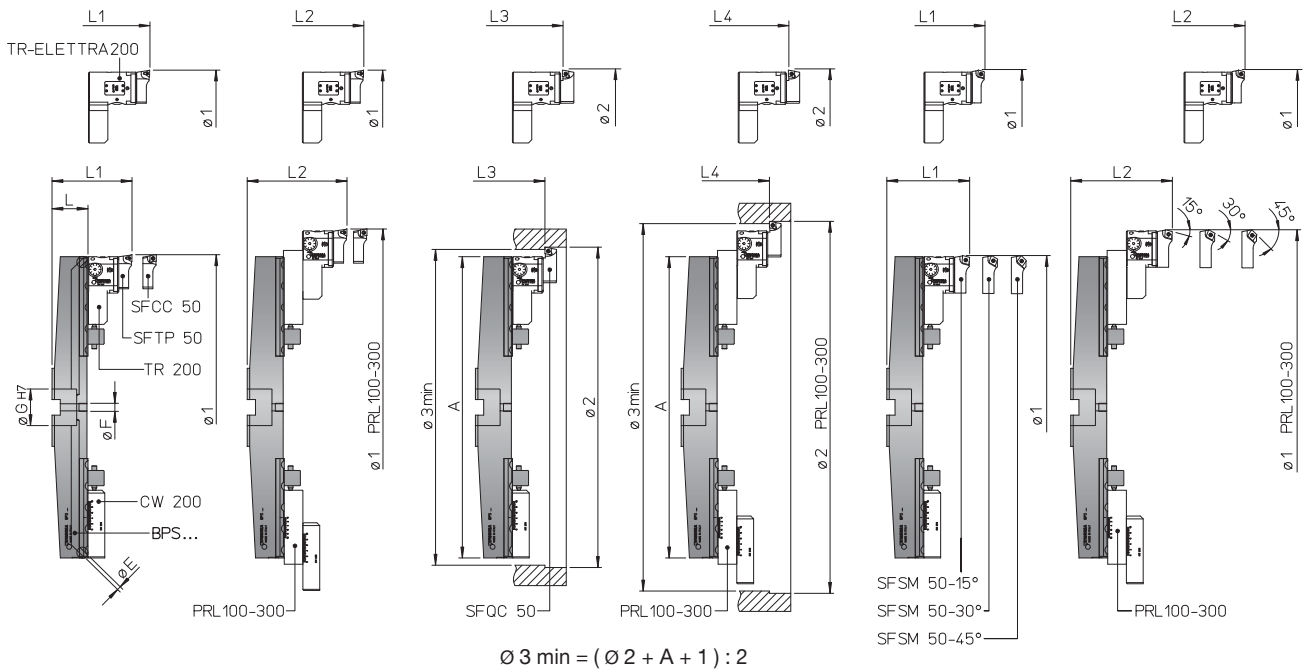

	BPS 200		BPS 300		BPS 400		BPS 500		BPS 600		BPS 700		BPS 800	
A	194		288		394		494		594		694		794	
B	-												128	
Ø D	(4xM12) 66.7						(4xM16) 101.6							
Ø E	2.5				-									
Ø F	-				1/4 GAS									
Ø G	40						60							
Ø 1	200~300	300~400	400 ~ 500		500 ~ 600		600 ~ 700		700 ~ 800		800 ~ 900			
Ø 1 PRL 100	300~400	400~500	500 ~ 600		600 ~ 700		700 ~ 800		800 ~ 900		900 ~ 1000			
Ø 1 PRL 300	400~600	500~700	600 ~ 800		700 ~ 900		800 ~ 1000		900 ~ 1100		1000 ~ 1200			
Ø 2	202~302	302~402	402 ~ 502		502 ~ 602		602 ~ 702		702 ~ 802		802 ~ 902			
Ø 2 PRL 100	302~402	402~502	502 ~ 602		602 ~ 702		702 ~ 802		802 ~ 902		902 ~ 1002			
Ø 2 PRL 300	402~602	502~702	602 ~ 802		702 ~ 902		802 ~ 1002		902 ~ 1102		1002 ~ 1202			
L	54		61		69		71		74		80			
	TR-200	TR-E200	TR-200	TR-E200	TR-200	TR-E200	TR-200	TR-E200	TR-200	TR-E200	TR-200	TR-E200	TR-200	TR-E200
L1	120	147	127	154	135	162	137	164	140	167	146	173		
L2 PRL 100	150	177	157	184	165	192	167	194	170	197	176	203		
L2 PRL 300	160	187	167	194	175	202	177	204	180	207	186	213		
L3	103	130	110	137	118	145	120	147	123	150	129	156		
L4 PRL 100	133	160	140	167	148	175	150	177	153	180	159	186		
L4 PRL 300	143	170	150	177	158	185	160	187	163	190	169	196		



D'ANDREA

MODULHARD'ANDREA

ALUMINIUM TOOLS LINE

BPS 1000~1600 GD

Ø 1000 ~ 2700

- DOUBLE-BIT BORING CROSSBARS
- ДВУХРЕЗЦОВЫЕ РАСТОЧНЫЕ ШТАНГИ
- WYTACZADŁA DWUNOŻOWE
- DVOUHROTOVÉ PŘÍČKY PRO VYVRTÁVÁNÍ
- DELİK AÇMA İÇİN ÇİFT UÇLU ÇAPRAZ KOLLAR

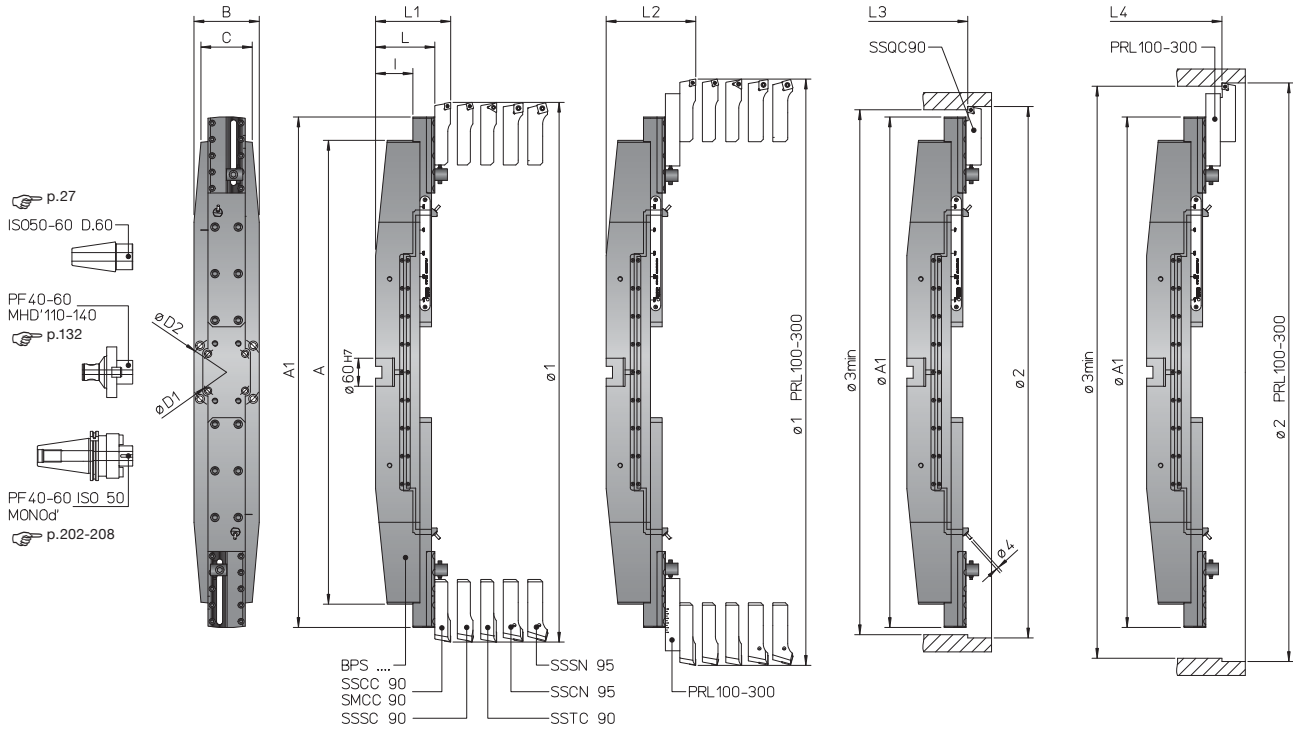

$$\varnothing 3 \text{ min} = (\varnothing 2 + A1 + 1) : 2$$

	BPS 1000 GD	BPS 1150 GD	BPS 1600 GD
A	995		1595
A1	995 ~ 1395	1495 ~ 1695	1595 ~ 2295
B	140		170
C	110		130
Ø D1	(4xM16) 101.6		
Ø D2	-		(4xM20) 177.8
Ø 1	1000 ~ 1500	1500 ~ 1800	1600 ~ 2400
Ø 1 PRL 100	1100 ~ 1600	1600 ~ 1900	1700 ~ 2500
Ø 1 PRL 300	1200 ~ 1800	1700 ~ 2100	1800 ~ 2700
Ø 2	1002 ~ 1502	1502 ~ 1802	1602 ~ 2402
Ø 2 PRL 100	1102 ~ 1602	1602 ~ 1902	1702 ~ 2502
Ø 2 PRL 300	1202 ~ 1802	1702 ~ 2102	1802 ~ 2702
I	80		105
L	126		151
L1 S...90	158		183
L1 S...95	166		191
L2 PRL 100 S...90	188		213
L2 PRL 300 S...90	198		223
L2 PRL 100 S...95	196		221
L2 PRL 300 S...95	206		231
L3 SSQC 90	128,5		153,5
L4 PRL 100 SSQC 90	158,5		183,5
L4 PRL 300 SSQC 90	168,5		193,5

119



126



116



BPS 1000~1600 GD

Ø 1000 ~ 2700

- DOUBLE-BIT CROSSBARS FOR BIG DIAMETER FINISH
- ДВУХРЕЗЦОВЫЕ РАСТОЧНЫЕ ШТАНГИ ДЛЯ ЧИСТОВОЙ ОБРАБОТКИ БОЛЬШИХ ДИАМЕТРОВ
- WYTACZADŁA WYKOŃCZENIOWE WIELKOŚREDNICOWE
- DVOUHROTOVÉ PŘÍČKY PRO DOKONČENÍ VELKÝCH PRŮMĚRŮ
- GENİŞ ÇAPLI BITİRME İŞLERİ İÇİN ÇİFT UÇLU ÇAPRAZ KOLLAR

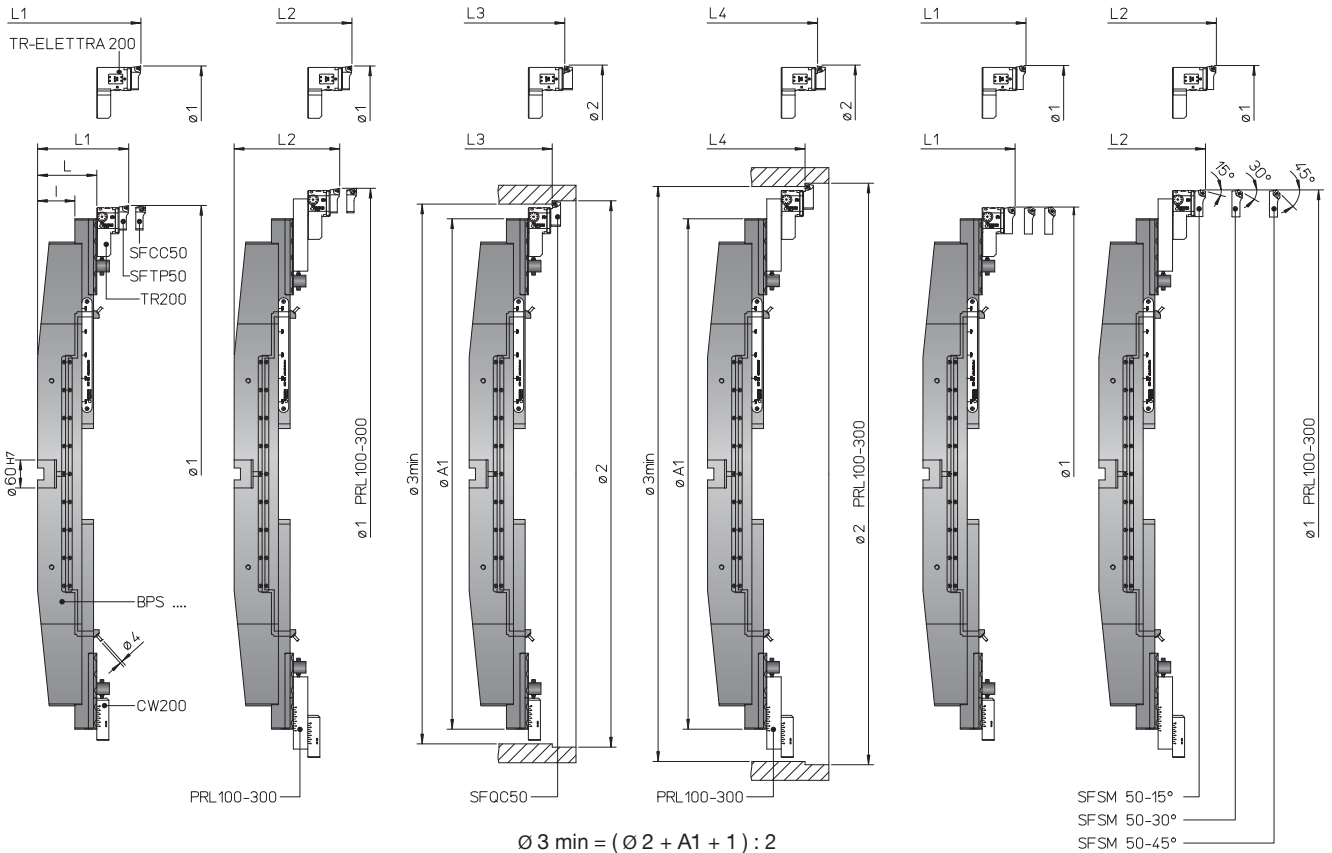

	BPS 1000 GD		BPS 1150 GD		BPS 1600 GD	
A	995				1595	
A1	995 ~ 1395		1495 ~ 1695		1595 ~ 2295	
B	140				170	
C	110				130	
Ø D1	(4xM16) 101.6					
Ø D2	-					
Ø 1	1000 ~ 1500		1500 ~ 1800		1600 ~ 2400	
Ø 1 PRL 100	1100 ~ 1600		1600 ~ 1900		1700 ~ 2500	
Ø 1 PRL 300	1200 ~ 1800		1700 ~ 2100		1800 ~ 2700	
Ø 2	1002 ~ 1502		1502 ~ 1802		1602 ~ 2402	
Ø 2 PRL 100	1102 ~ 1602		1602 ~ 1902		1702 ~ 2502	
Ø 2 PRL 300	1202 ~ 1802		1702 ~ 2102		1802 ~ 2702	
I	80				105	
	TR-200	TR-ELETTRA200	TR-200	TR-ELETTRA200	TR-200	TR-ELETTRA200
L	126	153	126	153	151	178
L1	192	219	192	219	217	244
L2 PRL 100	222	249	222	249	247	274
L2 PRL 300	232	259	232	259	257	284
L3	175	202	175	202	200	227
L4 PRL 100	205	232	205	232	230	257
L4 PRL 300	215	242	215	242	240	267



- MICROMETRIC HEAD TR 200 / TR-ELETTRA 200
- МИКРОМЕТРИЧЕСКАЯ ГОЛОВКА TR 200 / TR-ELETTRA 200
- GŁOWICA MIKROMETRYCZNA TR 200 / TR-ELETTRA 200
- MIKROMETRICKÁ HLAVA TR 200 / TR-ELETTRA 200
- MIKROMETRIK KAFA TR 200 / TR-ELETTRA 200

TR 200



- Body
• Корпус
• Korpus
• Tělo
• Gövde
- Slide toolholder
• Салазки
• Śanie narzędziowe
• Šoupátko nástrojového držáku
• Kayar takim tutucu
- Micrometric vernier scale
• Микрометрический нониус
• Noniusz mikrometryczny
• Mikrometrické měřítko vernie
• Mikrometrik verniye skalasi
- Slide clamp screw
• Зажимные винты салазок
• Śruba blokująca śanie narzędziowe
• Upinací šroub šoupátka
• Sürgülü sikma vidası

2 μm

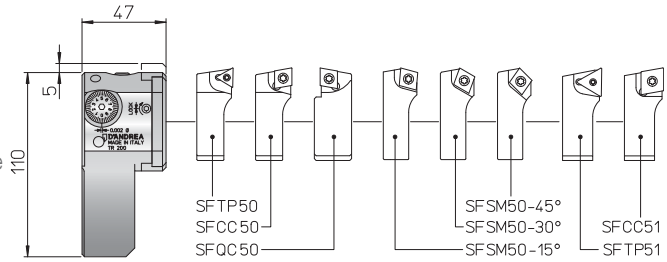

REF.	CODE	Kg.
TR 200	455020002000	1.3

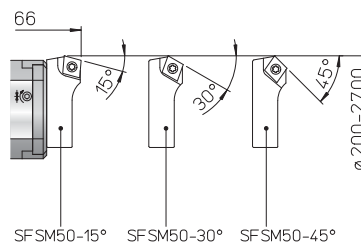
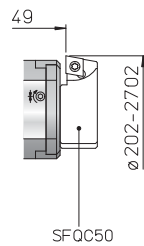
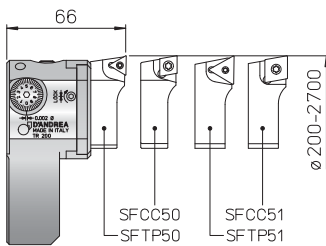

TR-ELETTRA 200

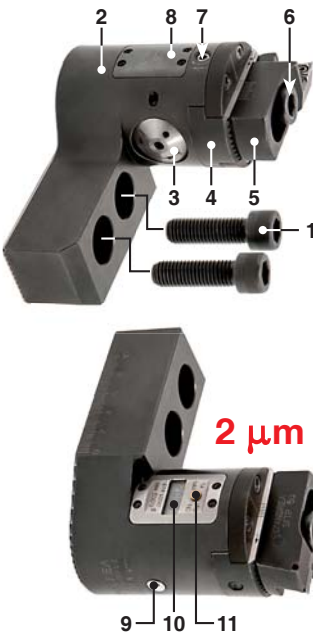

- Lock screw TR-E 200
• Фиксирующий винт
• Śruby mocujące TR-E 200
• Zajišťovací šroub TR-E 200
• Kilit vidası TR-E 200
- Body
• Корпус
• Korpus
• Tělo
• Gövde
- Set screw
• Установочный винт
• Śruba ustawcza
• Nastavovací šroub
• Ayar vidası
- Slide toolholder
• Салазки
• Śanie narzędziowe
• Šoupátko nástrojového držáku
• Kayar takim tutucu
- Bit holders
• Кассета головок
• Wytaczak
• Hrotový držák
• Matkap kovani
- Tool clamp screws
• Зажимные винты инструмента
• Śruba blokująca narzędzie
• Upinací šrouby nástroje
• Takımların sikma vidaları
- Slide clamp screw
• Зажимные винты салазок
• Śruba blokująca śanie narzędziowe
• Upinací šroub šoupátka
• Sürgülü sikma vidası
- Battery compartment cover
• Крышка батарейного отсека
• Osłona baterii
• Kryt prostoru baterie
• Pil bölümü kapağı
- Oiler
• Масленка
• Smarownica
• Olejnička
• Yağlayıcı
- Digital display
• Цифровой дисплей
• Wyświetlacz cyfrowy
• Digitální displej
• Dijital gösterge
- Selection button
• Кнопка выбора
• Przycisk wyboru
• Tlačítko pro výběr
• Seçim düğmesi

2 μm

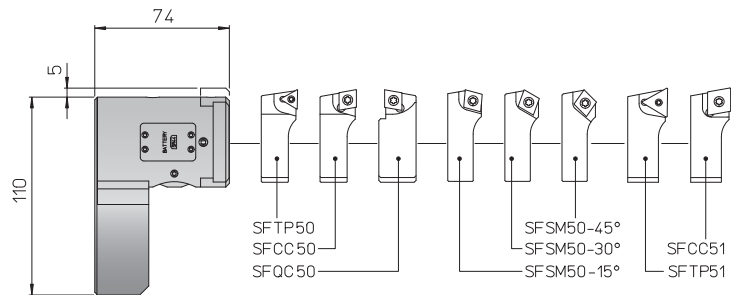

REF.	CODE	Kg.
TR-ELETTRA 200	455220002000	1.7

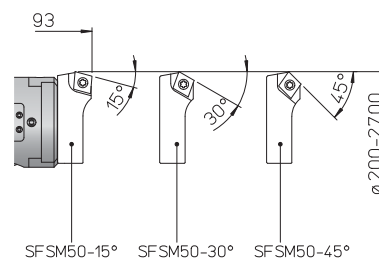
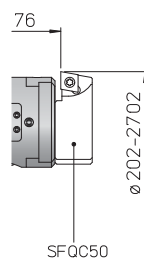
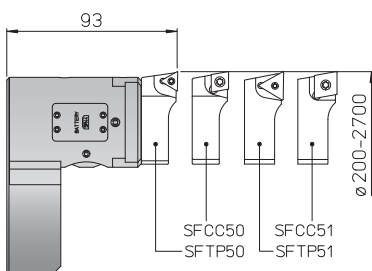

119



127



116



- BIT-HOLDERS FOR TESTAROSSA
- КАССЕТЫ ДЛЯ ГОЛОВКИ TESTAROSSA
- OSTRZA DO GŁOWIC TESTAROSSA
- HROTOVÉ DRŽÁKY TESTAROSSA
- TESTAROSSA İÇİN MATKAP KOVANLARI

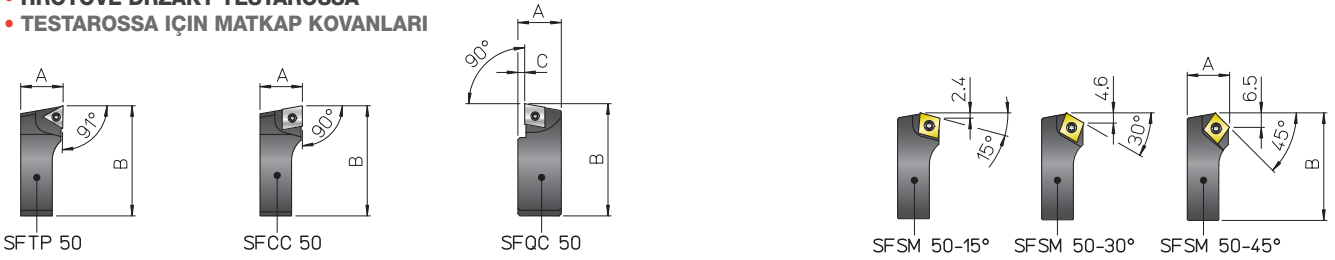

REF.	CODE	A	B	C	△	□	⊥	⌘	Kg.
SFTP 50	470500550001	19	52	-	TPGX 1103..	-	CS 300890T	TORX T08	0.08
SFTP 51	470500550003	21	52	-	TCMT 16T3..	-	TS 4	TORX T15	0.09
SFCC 50	470500550002	19	52	-	-	CCGT 09T3..	TS 4	TORX T15	0.08
SFCC 51	470500550004	21	52	-	-	CCMT 1204..	TS 5	TORX T25	0.09
SFQC 50	470500550062	20.5	53	3	-	CCMT 09T3..	TS 4	TORXT15	0.1
SFSM 50-15°	470500550011	19	50.5	-	-	CCMT 09T3..	TS 4	TORXT15	0.07
SFSM 50-30°	470500550013								
SFSM 50-45°	470500550015								

- BIT-HOLDERS FOR DOUBLE-BIT ITEMS
- КАССЕТЫ ДЛЯ ДВУХРЕЗЦОВЫХ ГОЛОВОК
- OSTRZA DO GŁOWIC DWUNOŻOWYCH
- HROTOVÉ DRŽÁKY PRO DVOUHROTOVÉ DÍLY
- ÇİFT UÇLU EKİPMAN İÇİN MATKAP KOVANLARI

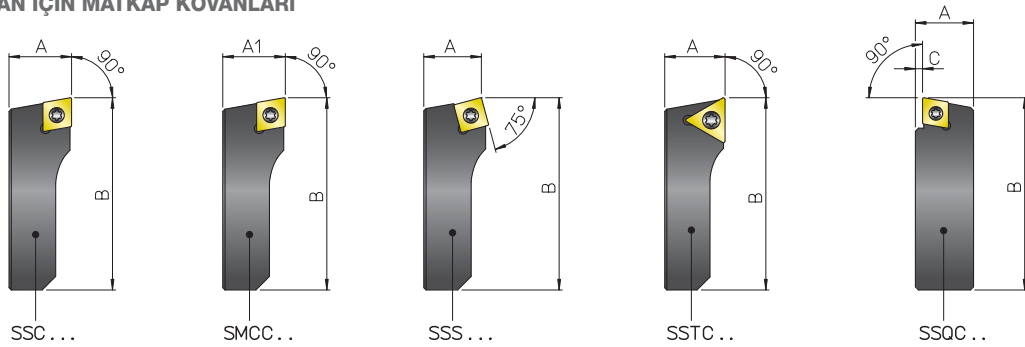

REF.	CODE	A	A1	B	C	□	□	△	⊥	⌘	Kg.
SSCC 90	470500590201	32	-	130	-	CCMT 1204..	-	-	TS 5	TORX T25	0.7
SSCN 95	470500595201	40	-	130	-	CNM. 1906..	-	-		p.126	0.9
SMCC 90	470500590203	-	31.7	130	-	CCMT 1204..	-	-	TS 5	TORX T25	0.7
SSSC 90	470500590202	32	-	130	-	-	SCMT 1204..	-	TS 5	TORX T25	0.7
SSSN 95	470500595202	40	-	130	-	-	SNM . 1906..	-		p.126	0.9
SSTC 90	470500590206	32	-	130	-	TCMT 2204..	-	-	TS 5	TORX T25	0.7
SSQC 90	470500590261	31.5	-	122	3.5	CCMT 1204..	-	-	TS 5	TORX T25	0.8

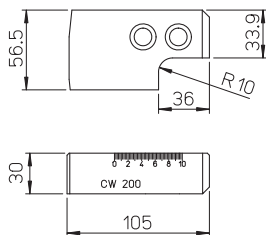

REF.	CODE	Kg.
CW 200	392011010501	1.3

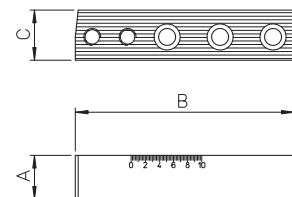

REF.	CODE	A	B	C	Kg.
PRL 100	392011015501	31	155	33.5	1.1
PRL 300	392011030001	41	255	35.5	2.8

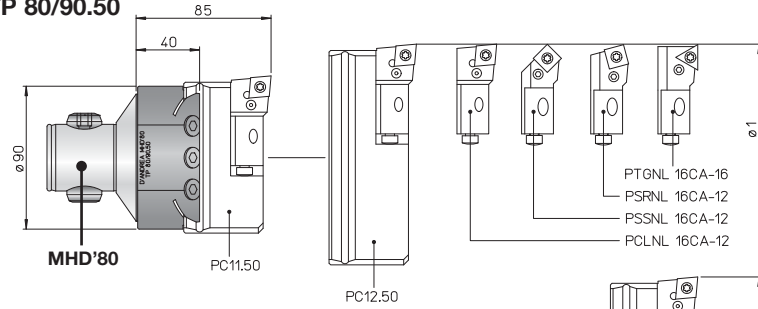
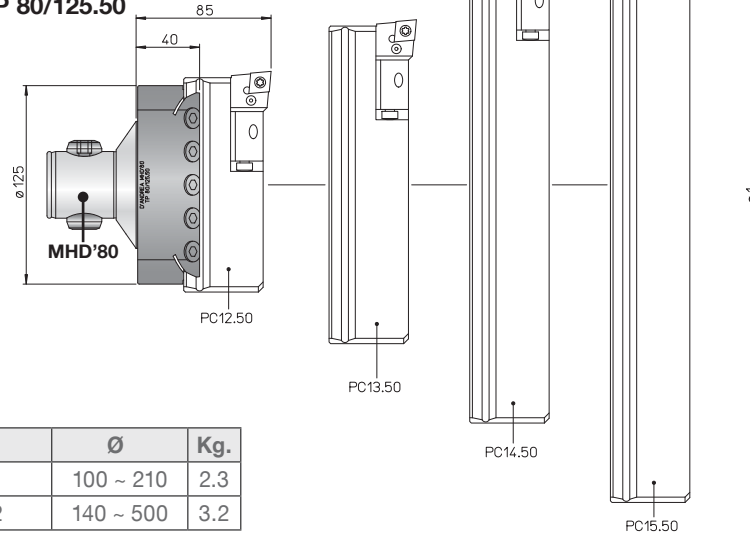

- TOOLHOLDERS
- ДЕРЖАТЕЛИ
- OPRAWKI NARZĘDZIOWE
- NÁSTROJOVÉ DRŽÁKY
- TAKIM TUTUCULAR

TP 80/90.50

TP 80/125.50

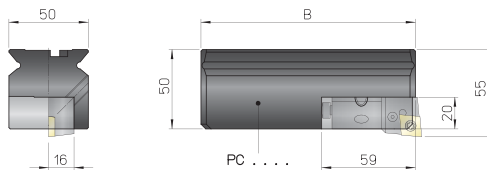
REF.	CODE	Ø	Kg.
TP 80/90.50	460408050001	100 ~ 210	2.3
TP 80/125.50	460408050002	140 ~ 500	3.2

PC

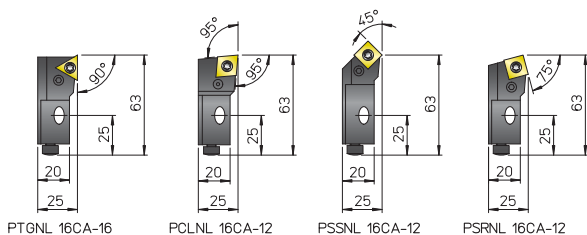
REF.	CODE	B	Ø 1 TP80/90.50	Ø 1 TP80/125.50	Kg.
PC 11.50	433050160950	95	100 ~ 140	-	1.3
PC 12.50	433050161350	135	140 ~ 210	140 ~ 210	2
PC 13.50	433050162000	200	-	210 ~ 310	3.2
PC 14.50	433050163000	300	-	310 ~ 410	4.8
PC 15.50	433050164000	400	-	410 ~ 500	6.3

16CA ISO 5611

REF.	CODE	△
PTGNL 16CA-16	483010161001	TNM. 1604..
PCLNL 16CA-12	483010161002	CNM. 1204..
PSSNL 16CA-12	483010161003	SNM. 1204..
PSRNL 16CA-12	483010161004	

• On request • Поставляются по запросу • Na zamówienie • Na vyžádán • İsteğe bağılı



- TOOLHOLDERS
- ДЕРЖАТЕЛИ
- OPRAWKI NARZĘDZIOWE
- NÁSTROJOVÉ DRŽÁKY
- TAKIM TUTUCULAR

TU

89

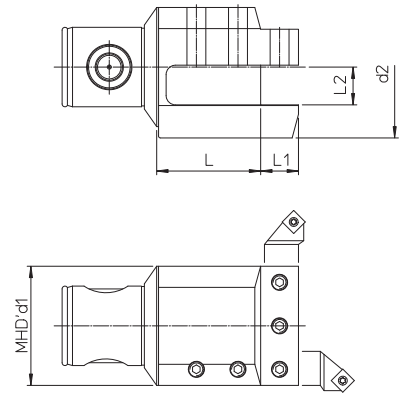

REF.	CODE	MHD' d1	d2	L	L1	L2	Kg.
TU 50/60.16	460505016001	50	60	44	16	16	1.2
TU 63/75.20	460506320001	63	75	55	20	20	2.4
TU 80/95.25	460508025001	80	95	65	25	25	3.6
TU 110/110.32	460511032001	110	130	78	32	32	11.2

- CHAMFERING TOOLS
- КОЛЬЦО ДЛЯ СНЯТИЯ ФАСКИ
- PIERŚCIEŃ DO SKOSÓW
- ZKOSENÉ NÁSTROJE
- YIV AÇMA TAKIMLARI

AS.. 45°

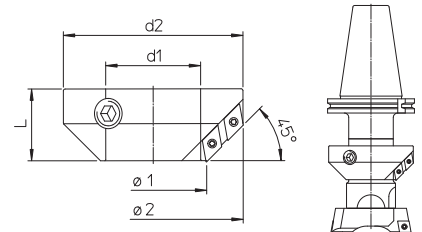

REF.	CODE	Ø1	d1	d2	L				Kg.
AS 16.45	655601600130	18 ~ 28	16	28	13	DCMT 0702..	TS 25	TORX T08	0.035
AS 20.45	655602000150	23 ~ 32	20	32	15				0.045
AS 25.45	655602500180	28 ~ 43	25	43	18				0.1
AS 32.45	655603200220	35 ~ 54	32	54	22				0.2
AS 40.45	655604000300	46 ~ 72	40	72	30	DCMT 11T3..	TS 4	TORX T15	0.5
AS 50.45	655605000380	56 ~ 95	50	95	38				1.1
AS 63.45	655606300460	75 ~ 125	63	125	46	DCMT 1504..	TS 5	TORX 25	2.3
AS 80.45	655608000580	95 ~ 165	80	165	58				5.2

120

